

Shedrow 2' Overhang

One Stall

Base Description:

- 1/12 roof pitch
- 8' eave height
- 18" overhang at eaves and gable ends
- Painted steel roofing and fascia
- 1 - 12'x12' stall

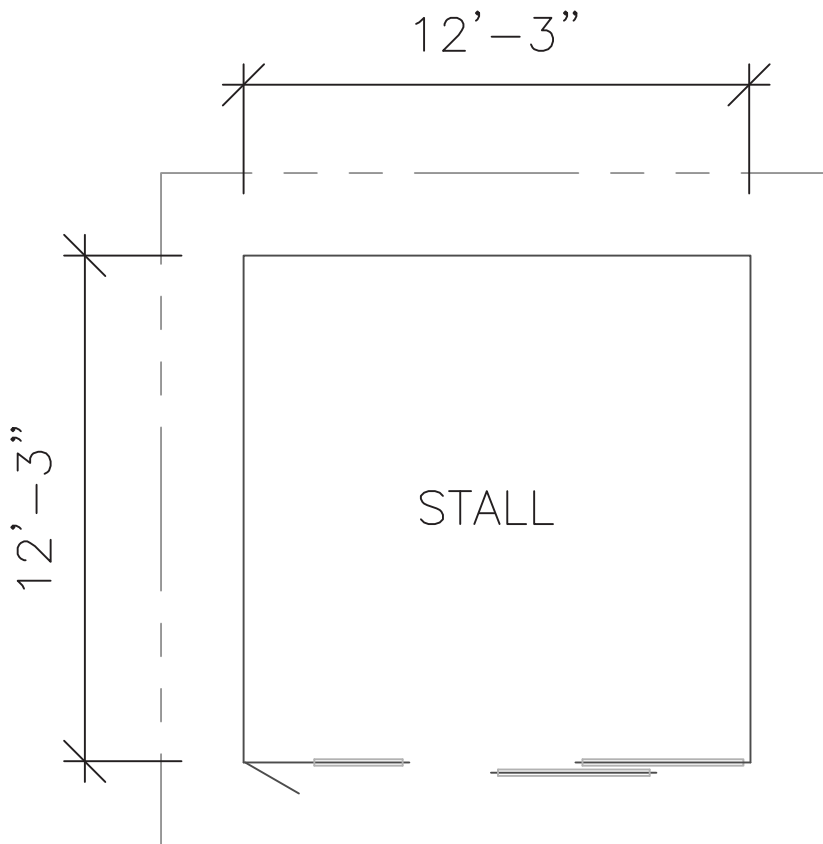

Shedrow 2' Overhang

Two Stall

Base Description:

- 1/12 roof pitch
- 8' eave height
- 18" overhang at eaves and gable ends
- Painted steel roofing and facia
- 2 - 12'x12' stalls with 2/3 - 3 rail divider wall

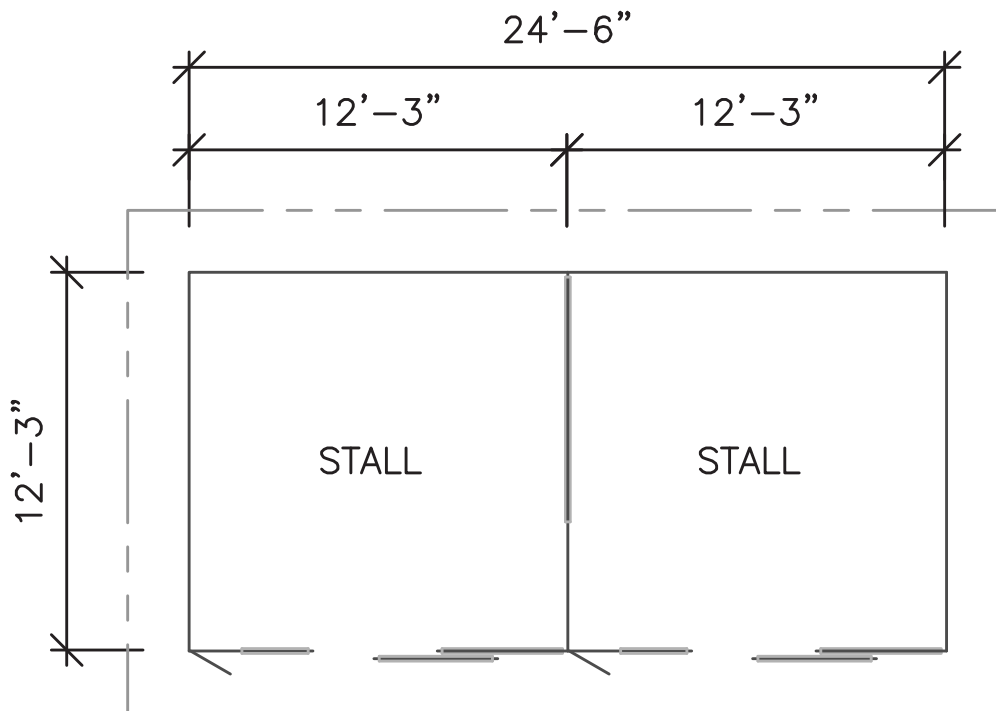

Shedrow 2' Overhang

Two Stall with Tack

Base Description:

- 1/12 roof pitch
- 8' eave height
- 18" overhang at eaves and gable ends
- Painted steel roofing and facia
- 2 - 12'x12' stalls with 2/3 - 3 rail divider wall
- 1 - 8'x12' tack room with 4070 steel entry door

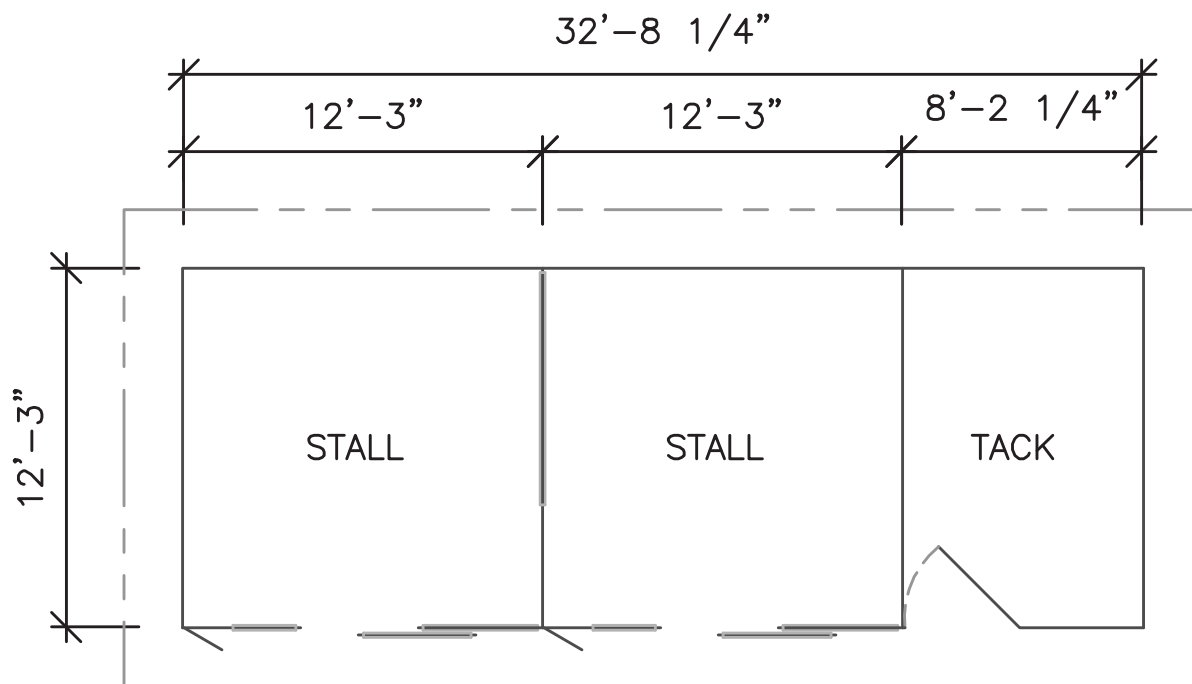

Shedrow 2' Overhang

Two Stall with Tack and Feed

Base Description:

- 1/12 roof pitch
- 8' eave height
- 18" overhang at eaves and gable ends
- Painted steel roofing and fascia
- 2 - 12'x12' stalls with 2/3 - 3 rail divider wall
- 1 - 8'x12' tack room with 4070 steel entry door
- 1 - 8'x12' feed room with 4' solid sliding door

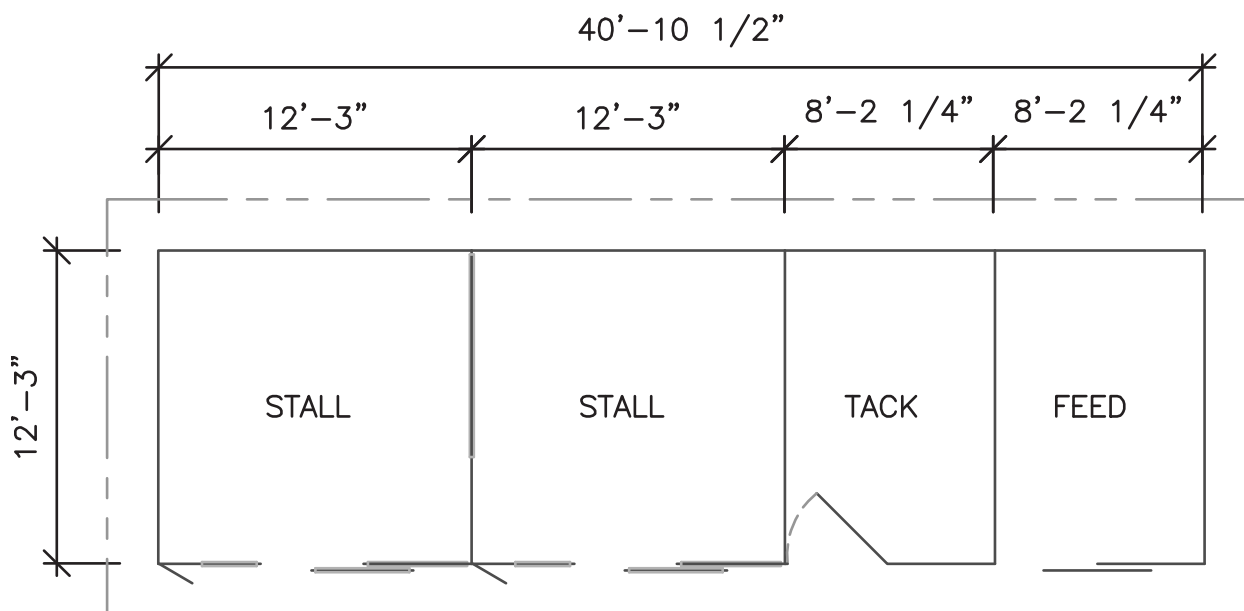

Shedrow 2' Overhang

Two Stall with Tack and Run-In

Base Description:

- 1/12 roof pitch
- 8' eave height
- 18" overhang at eaves and gable ends
- Painted steel roofing and fascia
- 2 - 12'x12' stalls with 2/3 - 3 rail divider wall
- 1 - 8'x12' tack room with 4070 steel entry door
- 1 - 12'x12' run-in shelter

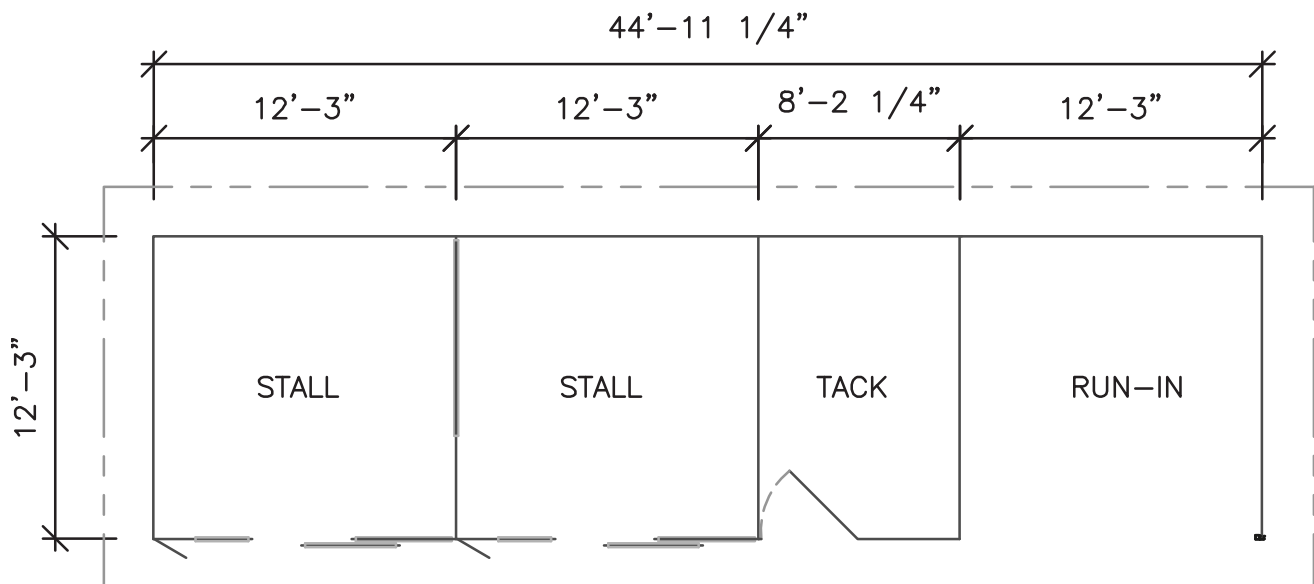

Shedrow 10' Overhang

Two Stall

Base Description:

- 3/12 roof pitch
- 9' eave height
- 10' roof overhang in front posted at 8'
- 18" overhang at eaves and gable ends
- 3"x3" porch posts
- Painted steel roofing and fascia
- 2 - 12'x12' stalls with 2/3 grill divider wall

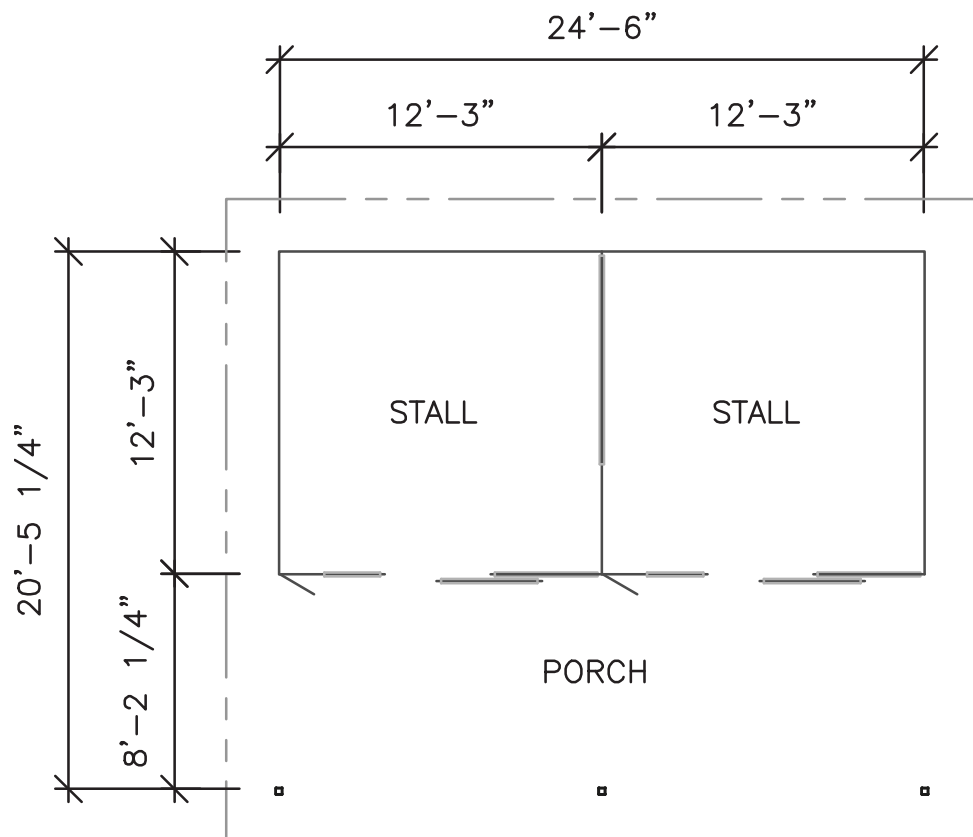

Shedrow 10' Overhang

Two Stall with Tack

Base Description:

- 3/12 roof pitch
- 9' eave height
- 10' roof overhang in front posted at 8'
- 18" overhang at eaves and gable ends
- 3"x3" porch posts
- Painted steel roofing and fascia
- 2 - 12'x12' stalls
- 1 - 8'x12' tack room with 4070 steel entry door

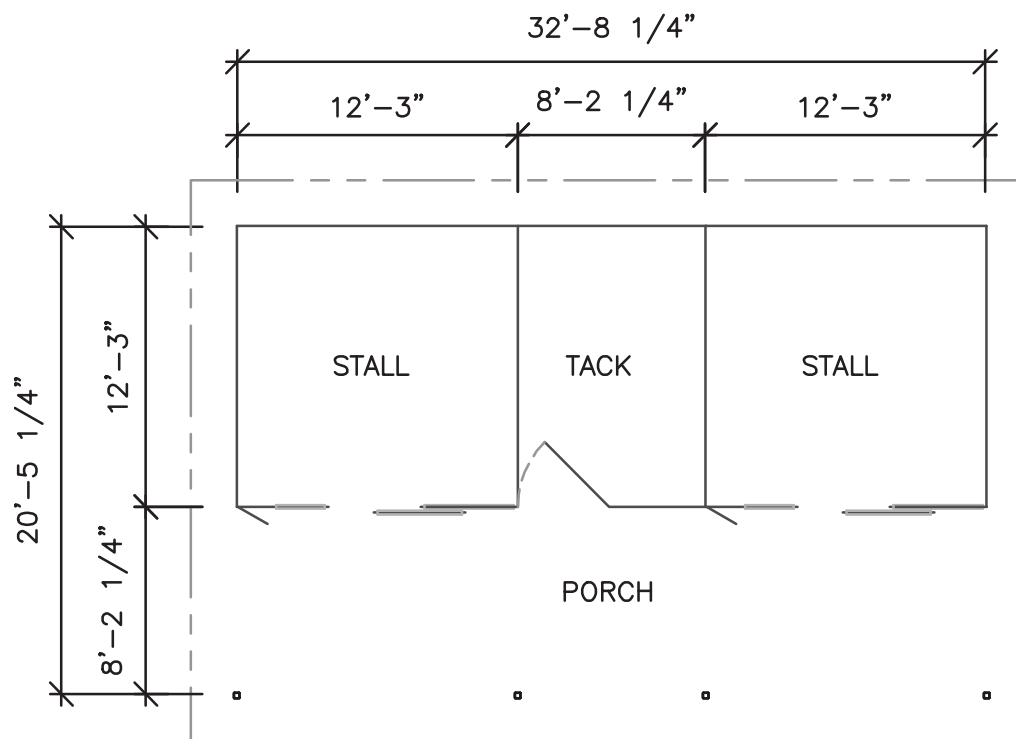

Shedrow 10' Overhang

Two Stall with Tack

Base Description:

- 3/12 roof pitch
- 9' eave height
- 10' roof overhang in front posted at 8'
- 18" overhang at eaves and gable ends
- 3"x3" porch posts
- Painted steel roofing and facia
- 2 - 12'x12' stalls with 2/3 grill divider wall
- 1 - 8'x12' tack room with 4070 steel entry door

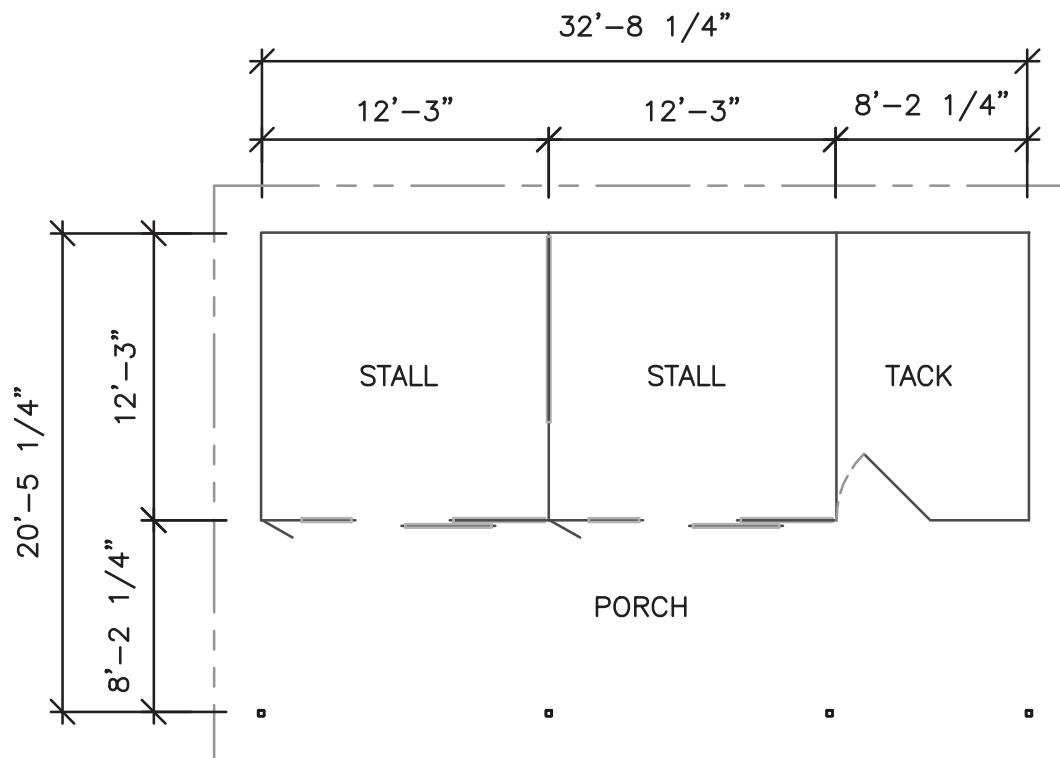

Shedrow 10' Overhang

Two Stall with Tack

Base Description:

- 3/12 roof pitch
- 9' eave height
- 10' roof overhang in front posted at 8'
- 18" overhang at eaves and gable ends
- 3"x3" porch posts
- Painted steel roofing and facia
- 2 - 12'x12' stalls with 2/3 grill divider wall
- 1 - 12'x12' tack room with 4070 steel entry door

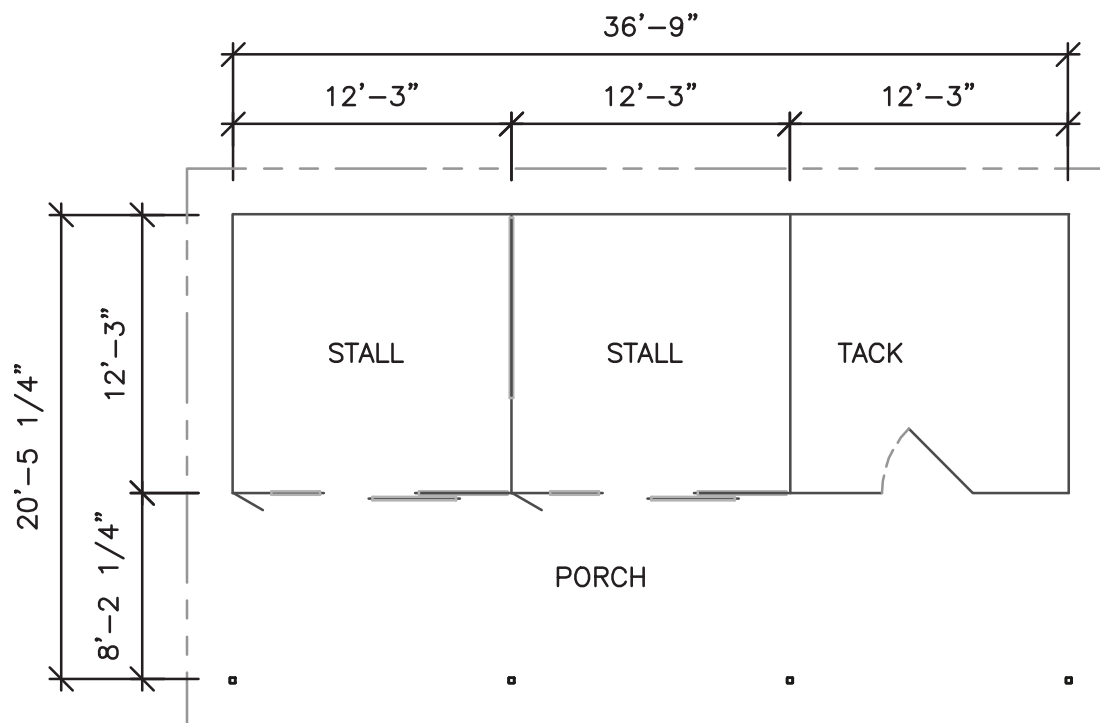

Shedrow 10' Overhang

Three Stall with Tack

Base Description:

- 3/12 roof pitch
- 9' eave height
- 10' roof overhang in front posted at 8'
- 18" overhang at eaves and gable ends
- 3"x3" porch posts
- Painted steel roofing and facia
- 3 - 12'x12' stalls with 2/3 grill divider wall
- 1 - 12'x12' tack room with 4070 steel entry door

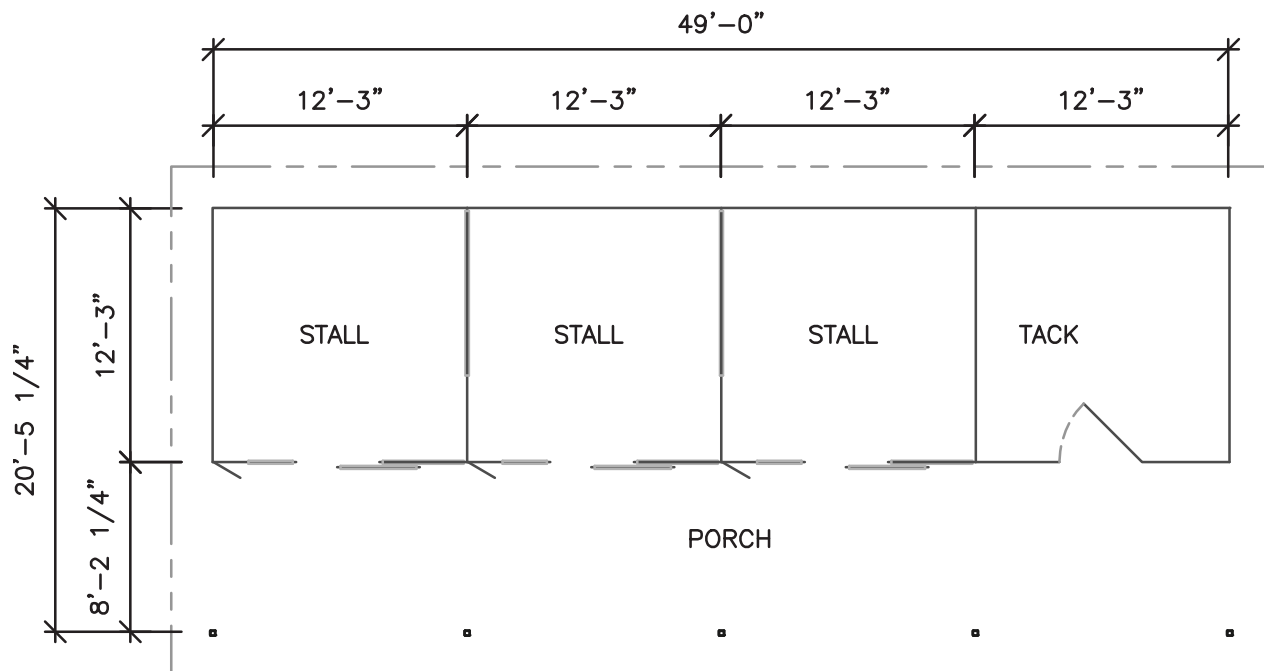

Shedrow 10' Overhang

Three Stall with Feed and Tack

Base Description:

- 3/12 roof pitch
- 9' eave height
- 10' roof overhang in front posted at 8'
- 18" overhang at eaves and gable ends
- 3"x3" porch posts
- Painted steel roofing and fascia
- 3 - 12'x12' stalls with 2/3 grill divider wall
- 1 - 12'x12' tack room with 4070 steel entry door
- 1 - 12'x12' feed room with 6' sliding door

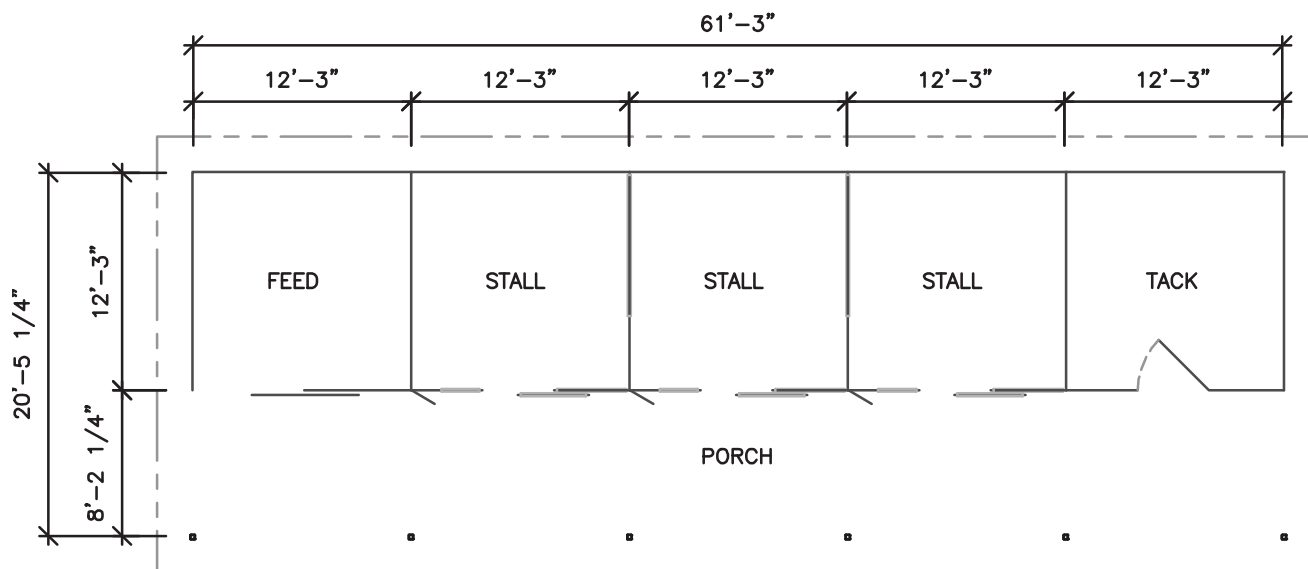

Shedrow 10' Overhang

Four Stall with Feed and Tack

Base Description:

- 3/12 roof pitch
- 9' eave height
- 10' roof overhang in front posted at 8'
- 18" overhang at eaves and gable ends
- 3"x3" porch posts
- Painted steel roofing and fascia
- 4 - 12'x12' stalls with 2/3 grill divider wall
- 1 - 12'x12' tack room with 4070 steel entry door
- 1 - 12'x12' feed room with 6' sliding door

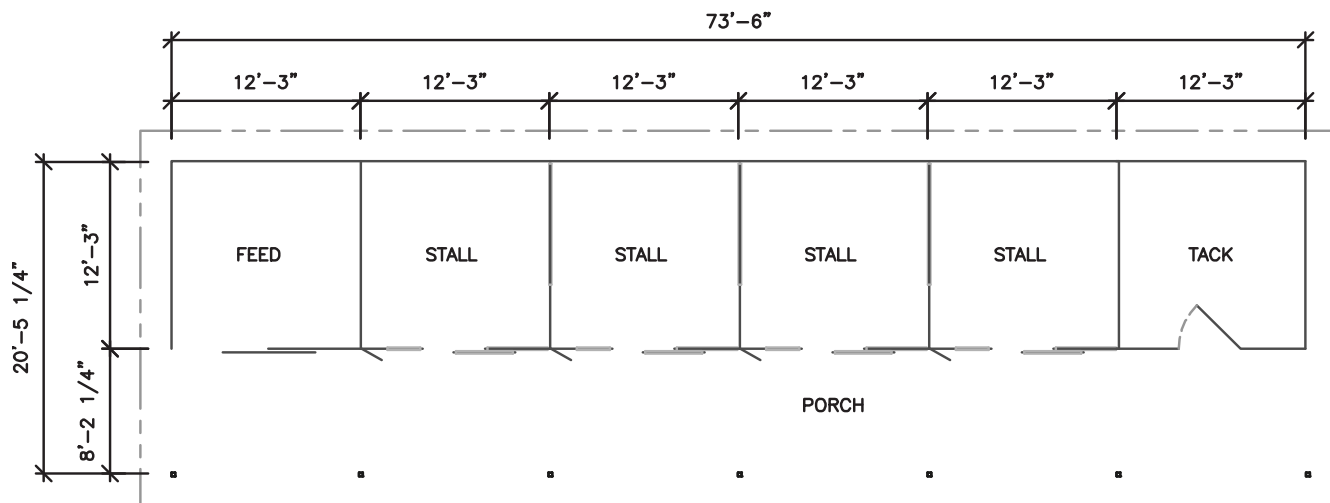

Shedrow 10' Overhang

Five Stall with Feed and Tack

Base Description:

- 3/12 roof pitch
- 9' eave height
- 10' roof overhang in front posted at 8'
- 18" overhang at eaves and gable ends
- 3"x3" porch posts
- Painted steel roofing and fascia
- 5 - 12'x12' stalls with 2/3 grill divider wall
- 1 - 12'x12' tack room with 4070 steel entry door
- 1 - 12'x12' feed room with 6' sliding door

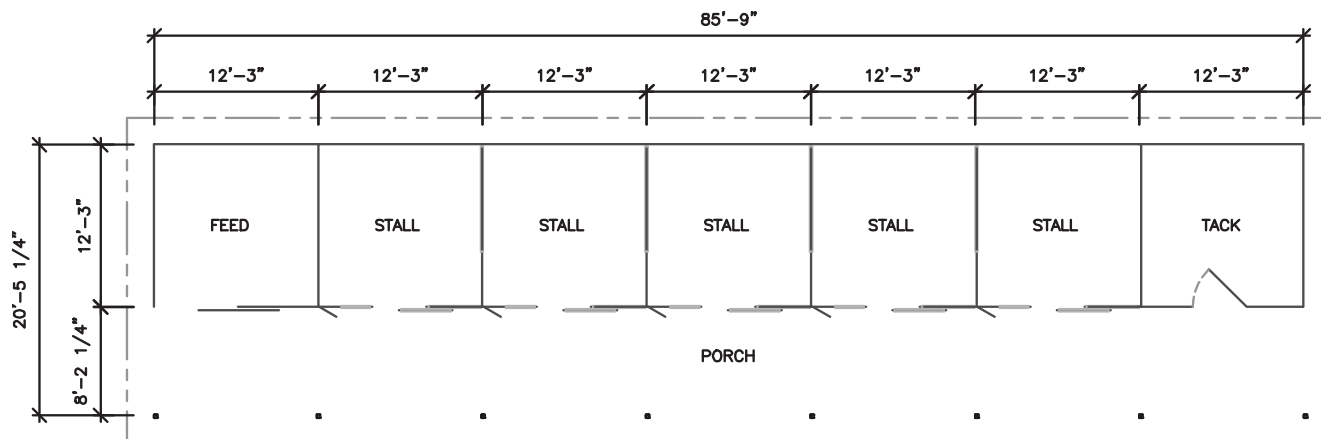

Shedrow 14' Overhang

Two Stall

Base Description:

- 3/12 roof pitch
- 9' eave height
- 14' roof overhang in front posted at 12'
- 18" overhang at eaves and gable ends
- 3"x3" porch posts
- Painted steel roofing and facia
- 2 - 12'x12' stalls with 2/3 grill divider wall

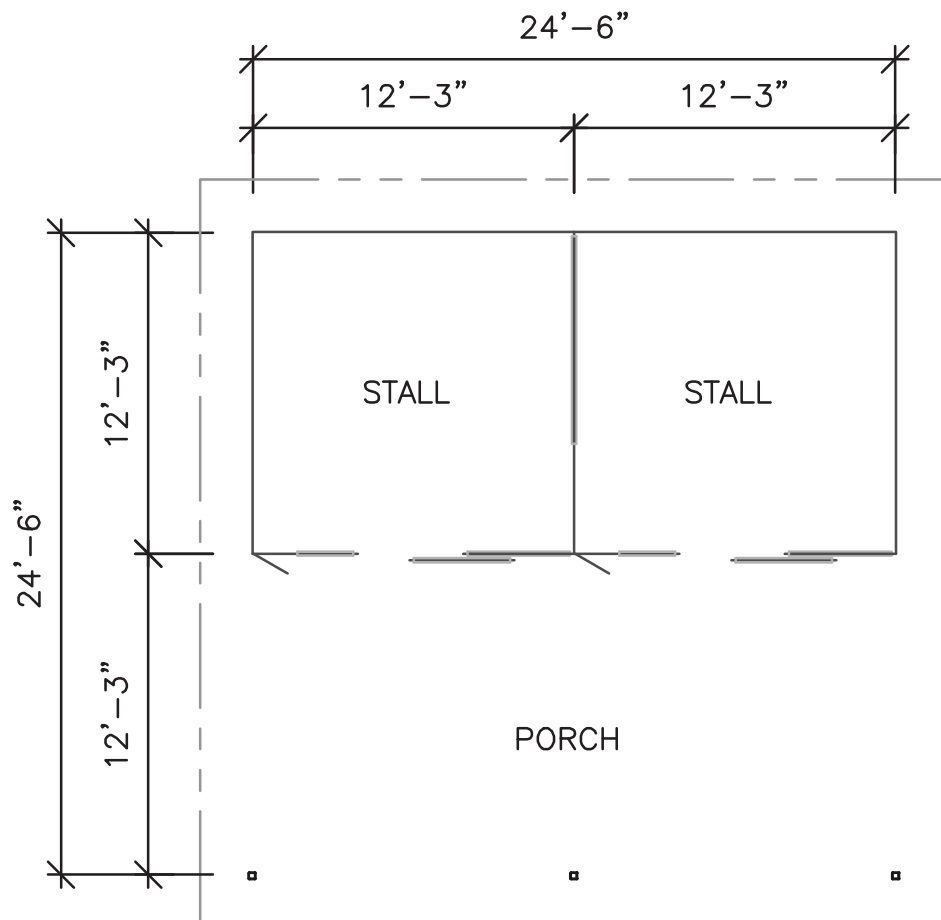

Shedrow 14' Overhang

Two Stall with Tack

Base Description:

- 3/12 roof pitch
- 9' eave height
- 14' roof overhang in front posted at 12'
- 18" overhang at eaves and gable ends
- 3"x3" porch posts
- Painted steel roofing and fascia
- 2 - 12'x12' stalls
- 1 - 8'x12' tack room with 4070 steel entry door

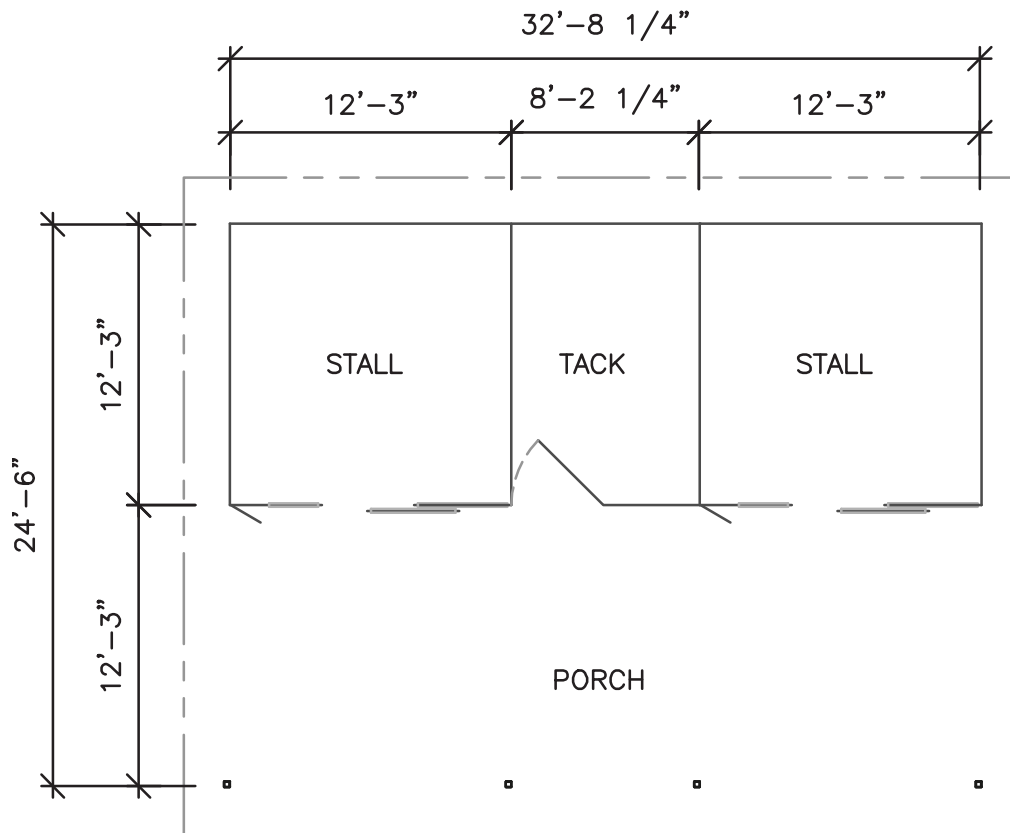

Shedrow 14' Overhang

Two Stall with Tack

Base Description:

- 3/12 roof pitch
- 9' eave height
- 14' roof overhang in front posted at 12'
- 18" overhang at eaves and gable ends
- 3"x3" porch posts
- Painted steel roofing and facia
- 2 - 12'x12' stalls with 2/3 grill divider wall
- 1 - 8'x12' tack room with 4070 steel entry door

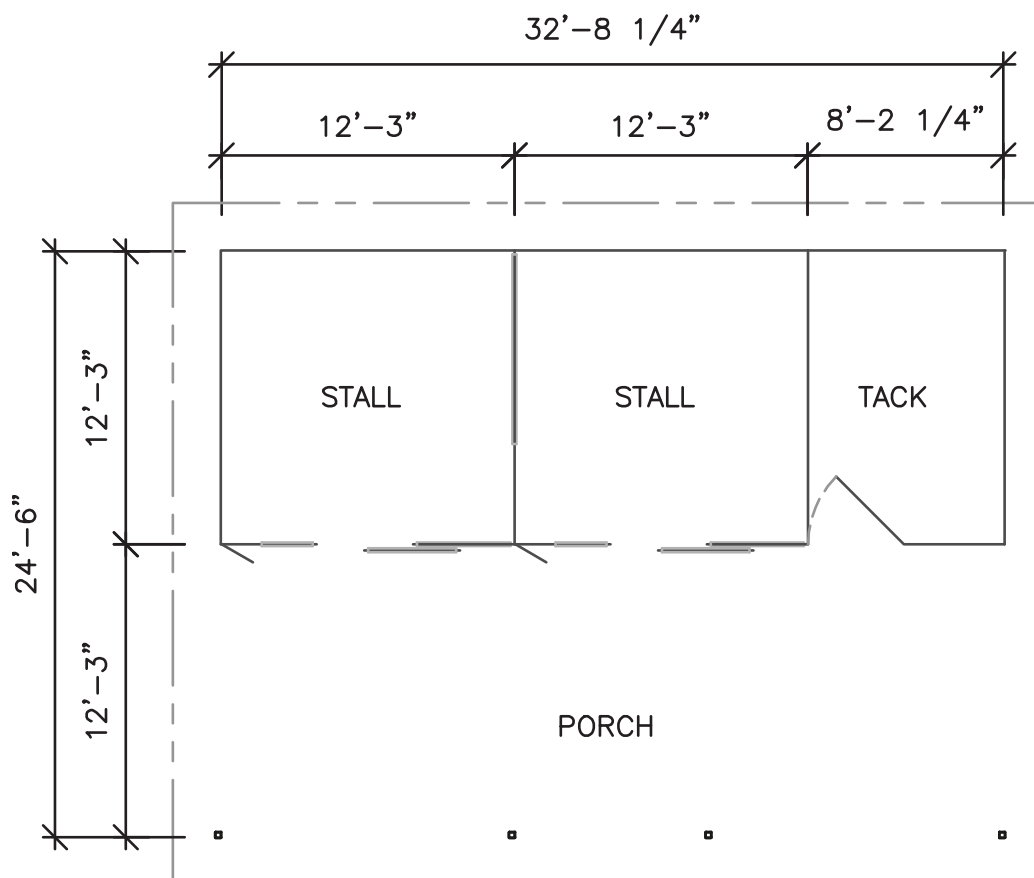

Shedrow 14' Overhang

Two Stall with Tack



Base Description:

- 3/12 roof pitch
- 9' eave height
- 14' roof overhang in front posted at 12'
- 18" overhang at eaves and gable ends
- 3"x3" porch posts
- Painted steel roofing and fascia
- 2 - 12'x12' stalls with 2/3 grill divider wall
- 1 - 12'x12' tack room with 4070 steel entry door

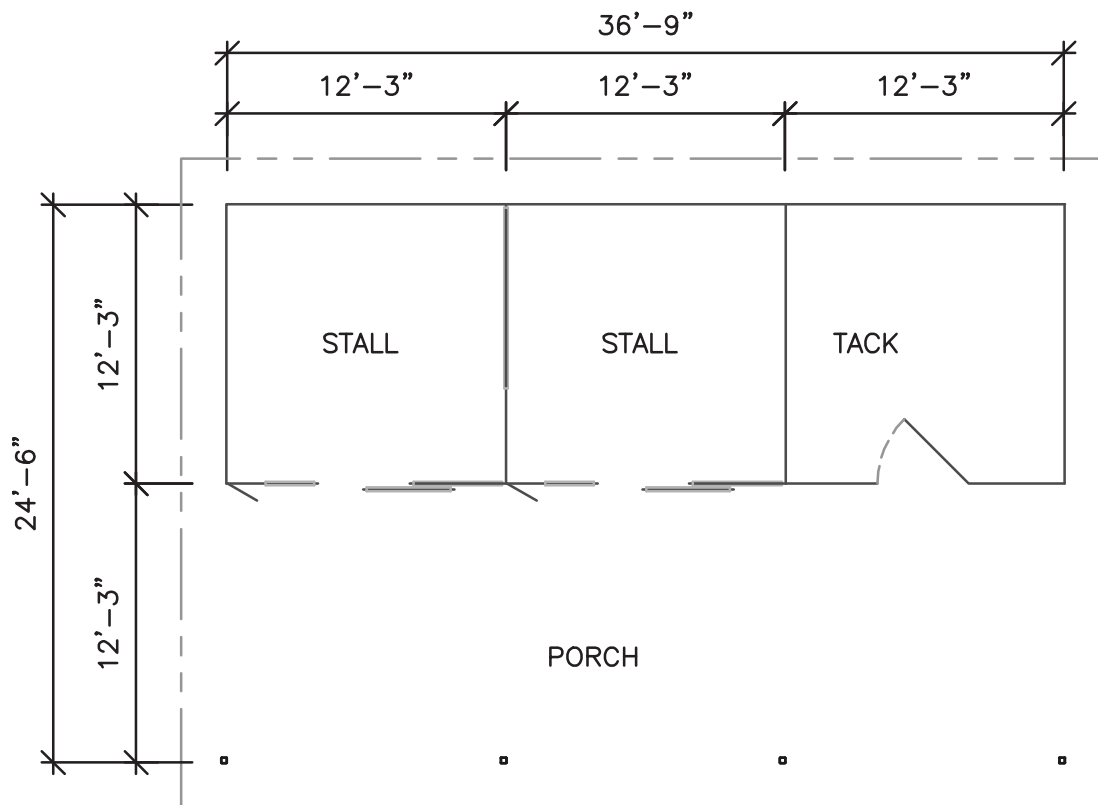

Shedrow 14' Overhang

Three Stall with Tack



Base Description:

- 3/12 roof pitch
- 9' eave height
- 14' roof overhang in front posted at 12'
- 18" overhang at eaves and gable ends
- 3"x3" porch posts
- Painted steel roofing and facia
- 3 - 12'x12' stalls with 2/3 grill divider wall
- 1 - 12'x12' tack room with 4070 steel entry door

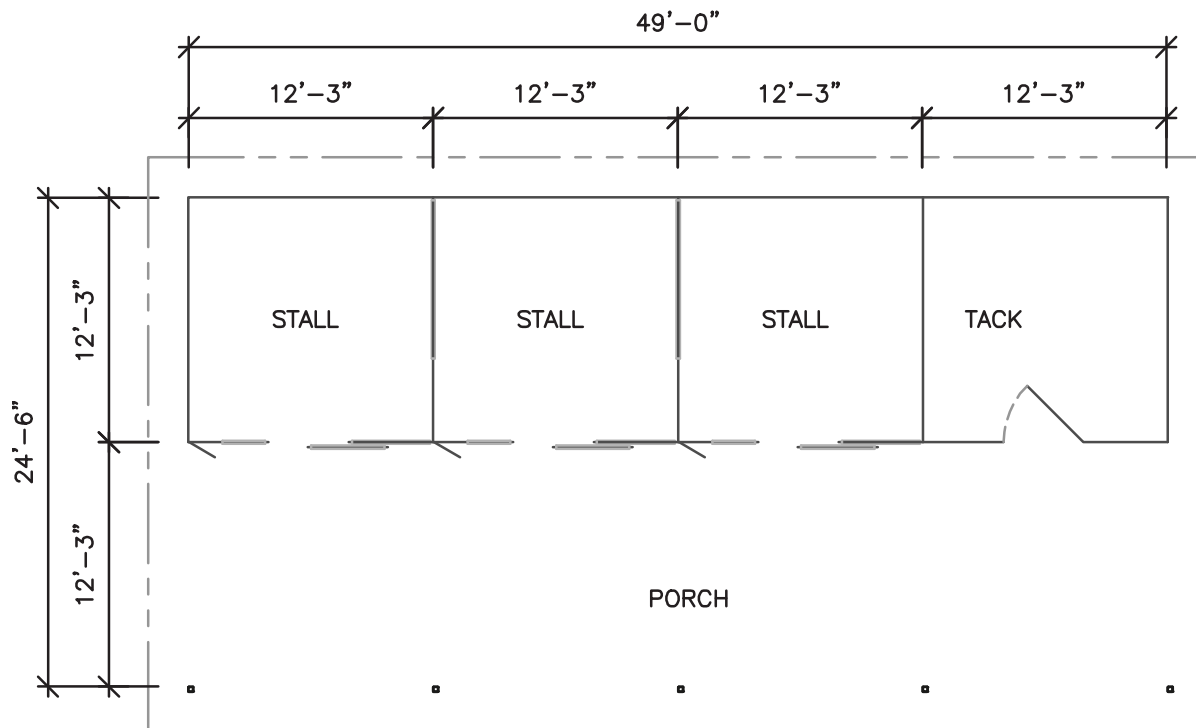

Shedrow 14' Overhang

Three Stall with Feed and Tack



Base Description:

- 3/12 roof pitch
- 9' eave height
- 14' roof overhang in front posted at 12'
- 18" overhang at eaves and gable ends
- 3"x3" porch posts
- Painted steel roofing and fascia
- 3 - 12'x12' stalls with 2/3 grill divider wall
- 1 - 12'x12' tack room with 4070 steel entry door
- 1 - 12'x12' feed room with 6' sliding door

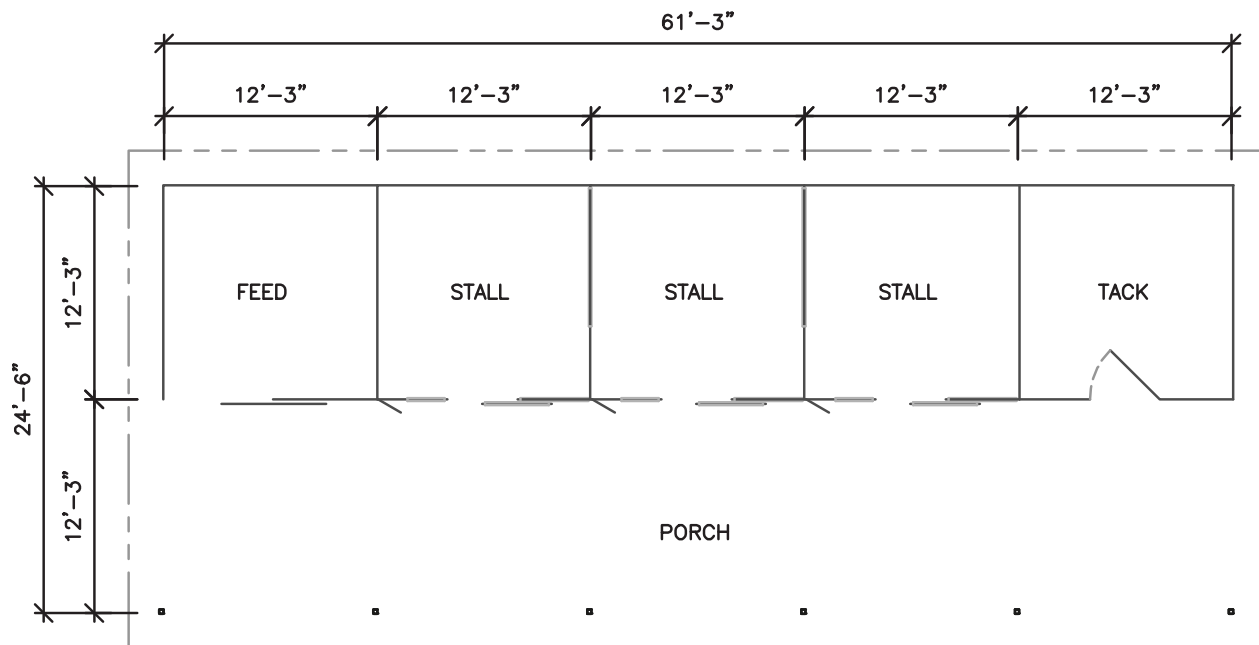

Shedrow 14' Overhang

Four Stall with Feed and Tack

Base Description:

- 3/12 roof pitch
- 9' eave height
- 14' roof overhang in front posted at 12'
- 18" overhang at eaves and gable ends
- 3"x3" porch posts
- Painted steel roofing and fascia
- 4 - 12'x12' stalls with 2/3 grill divider wall
- 1 - 12'x12' tack room with 4070 steel entry door
- 1 - 12'x12' feed room with 6' sliding door

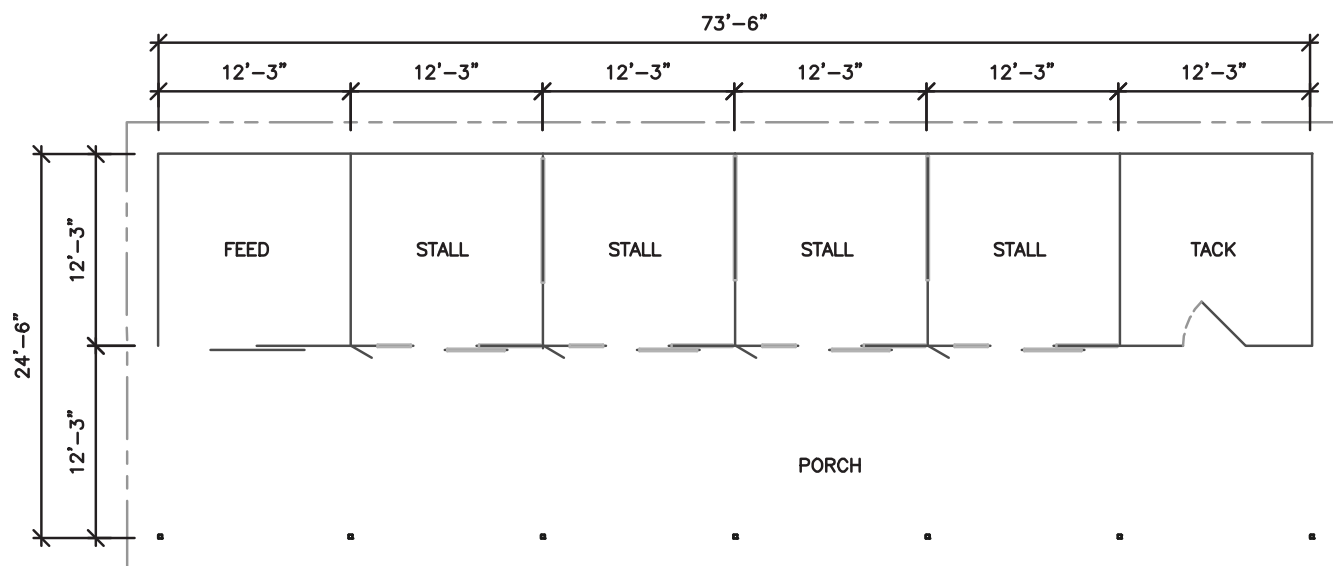

Shedrow 14' Overhang

Five Stall with Feed and Tack



Base Description:

- 3/12 roof pitch
- 9' eave height
- 14' roof overhang in front posted at 12'
- 18" overhang at eaves and gable ends
- 3"x3" porch posts
- Painted steel roofing and fascia
- 5 - 12'x12' stalls with 2/3 grill divider wall
- 1 - 12'x12' tack room with 4070 steel entry door
- 1 - 12'x12' feed room with 6' sliding door

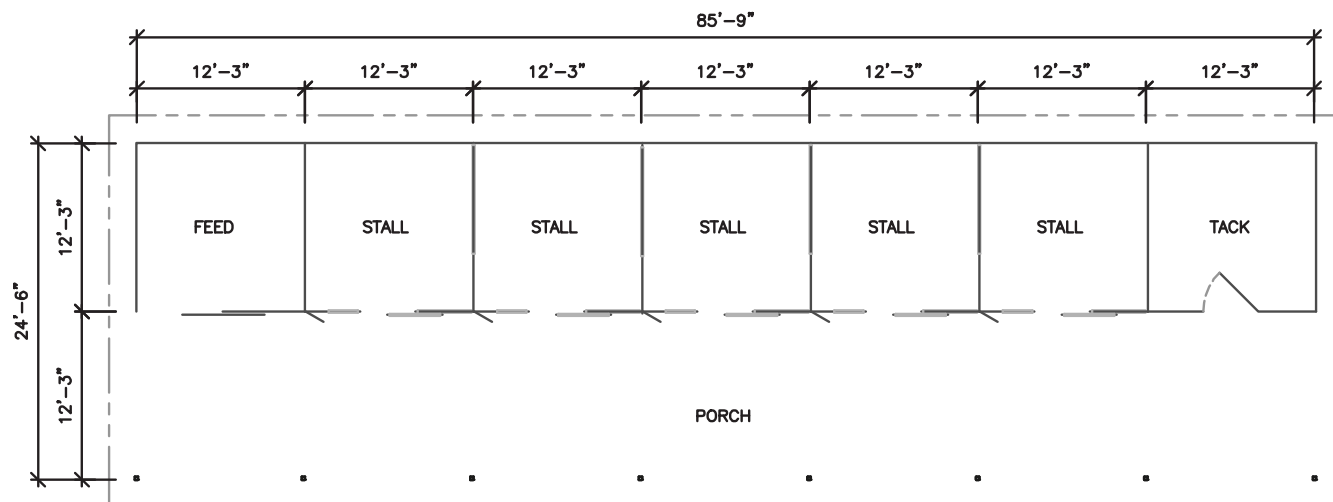

U-Shaped Shedrow

12 Stall with Feed, Tack, Wash, and Groom



Base Description:

- 3/12 roof pitch
- 9' eave height
- 14' roof overhang in front posted at 12'
- 18" overhang at eaves and gable ends
- 3"x3" porch posts
- Painted steel roofing and fascia
- 12 - 12'x12' stalls with 2/3 grill divider wall
- 1 - 12'x24' tack room with 4070 steel entry door and 8' pivot wall
- 1 - 12'x24' feed room with 6' sliding door
- 2 - 12'x12' wash bays with divider walls
- 1 - 12'x12' saddle/groom bay

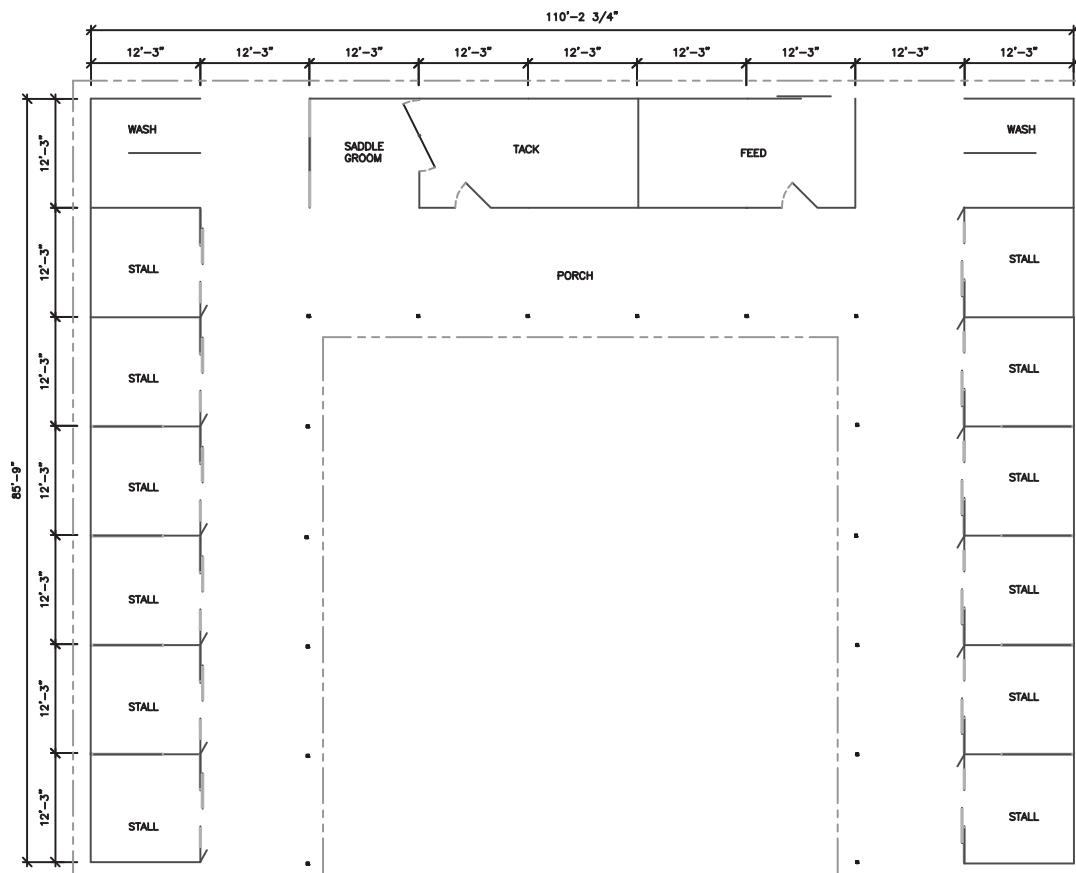

U-Shaped Shedrow

12 Stall with Feed, Tack, Wash, and Groom



Base Description:

- 3/12 roof pitch
- 9' eave height
- 14' roof overhang in front posted at 12'
- 18" overhang at eaves and gable ends
- 3"x3" porch posts
- Painted steel roofing and fascia
- 10 - 12'x12' stalls with 2/3 grill divider wall
- 2 - 12'x12' stalls with foaling 2/3 grill divider wall
- 1 - 12'x24' tack room with 4070 steel entry door and 8' pivot wall
- 1 - 12'x24' feed room with 6' sliding door
- 1 - 12'x12' wash bay with cross tie post and tie rings
- 1 - 12'x12' saddle/groom bay with tie rings

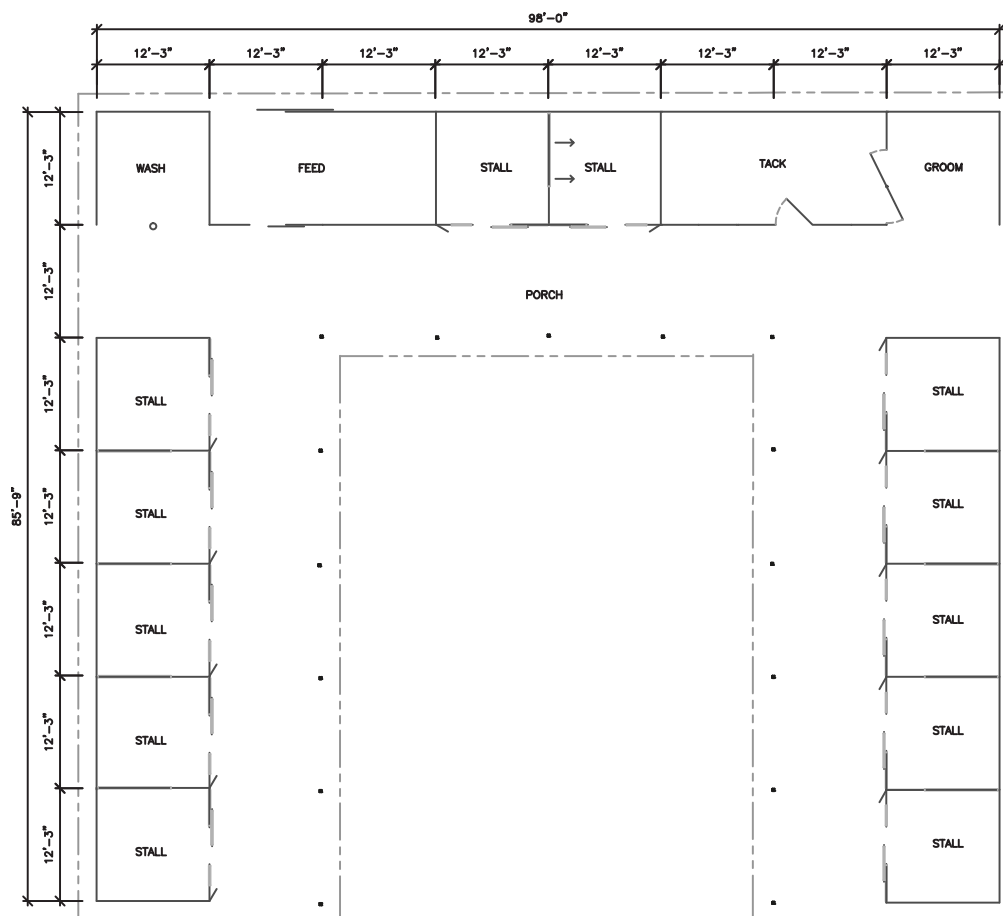

Back-to-Back Shedrow

20 Stall

Base Description:

- 3/12 roof pitch
- 9' eave height
- 18" overhang at eaves and gable ends
- Painted steel roofing and fascia
- 20 - 12'x12' stalls with solid divider walls

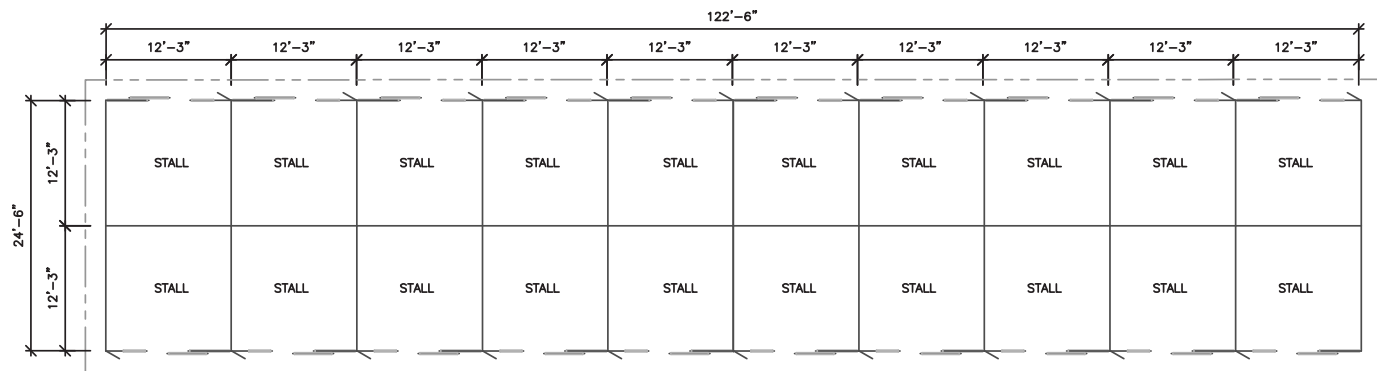

Back-to-Back Shedrow

18 Stall with Tack



Base Description:

- 3/12 roof pitch
- 9' eave height
- 18" overhang at eaves and gable ends
- Painted steel roofing and facia
- 18 - 12'x12' stalls with solid divider walls
- 2 - 12'x12' tack rooms with 4070 steel entry door

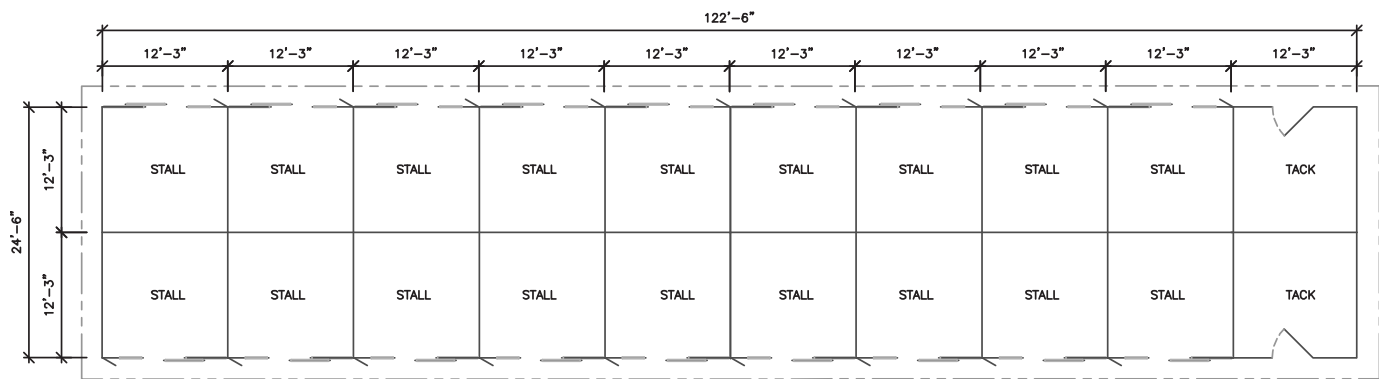

Back-to-Back Shedrow

20 Stall with 10' Overhang



Base Description:

- 3/12 roof pitch
- 9' eave height
- 18" overhang at eaves and gable ends
- 10' overhangs posted at 8'
- Painted steel roofing and fascia
- 20 - 12'x12' stalls with solid divider walls

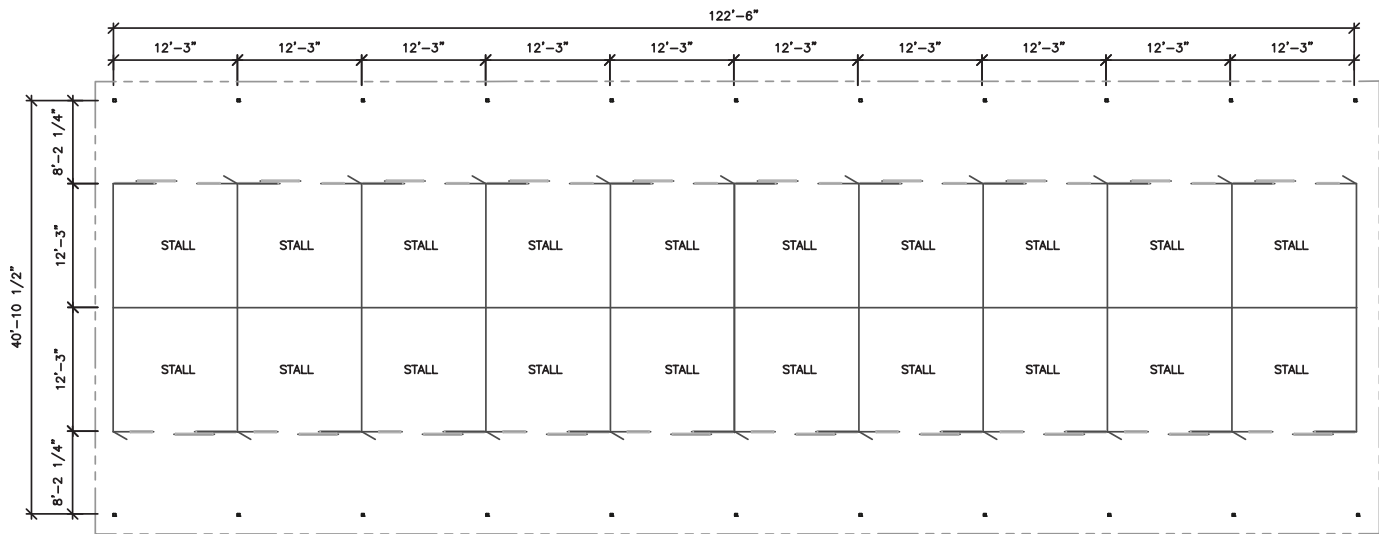

Back-to-Back Shedrow

18 Stall with Tack 10' Overhang



Base Description:

- 3/12 roof pitch
- 9' eave height
- 18" overhang at eaves and gable ends
- 10' overhangs posted at 8'
- Painted steel roofing and fascia
- 18 - 12'x12' stalls with solid divider walls
- 2 - 12'x12' tack rooms with 4070 steel entry door

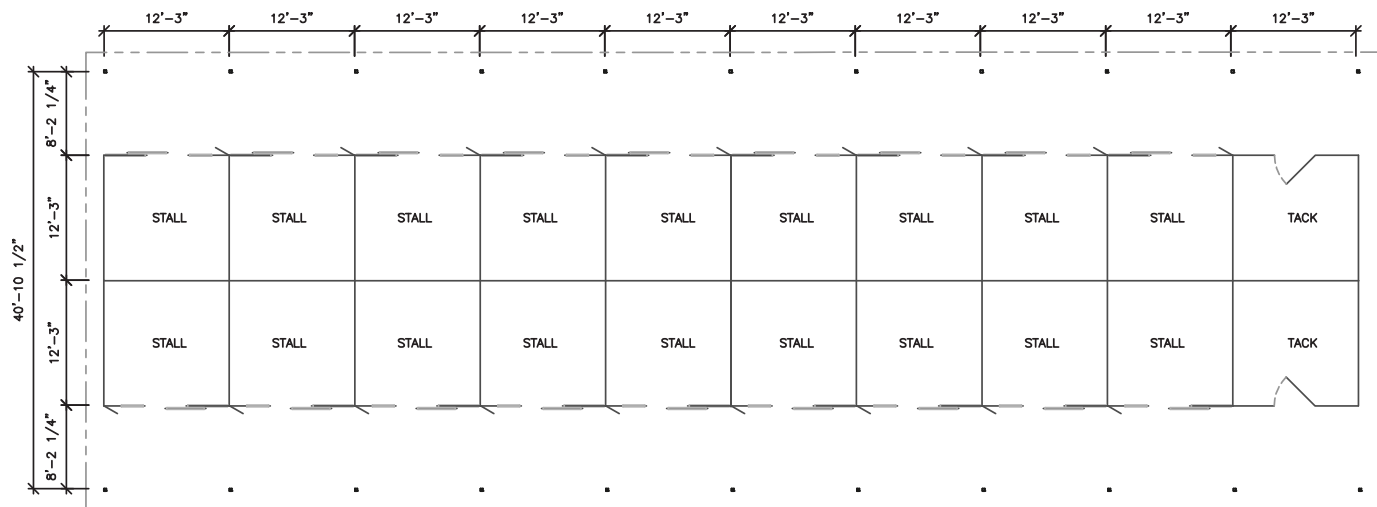

Back-to-Back Shedrow

20 Stall with 14' Overhang



Base Description:

- 3/12 roof pitch
- 9' eave height
- 18" overhang at eaves and gable ends
- 14' overhangs posted at 12'
- Painted steel roofing and fascia
- 20 - 12'x12' stalls with solid divider walls

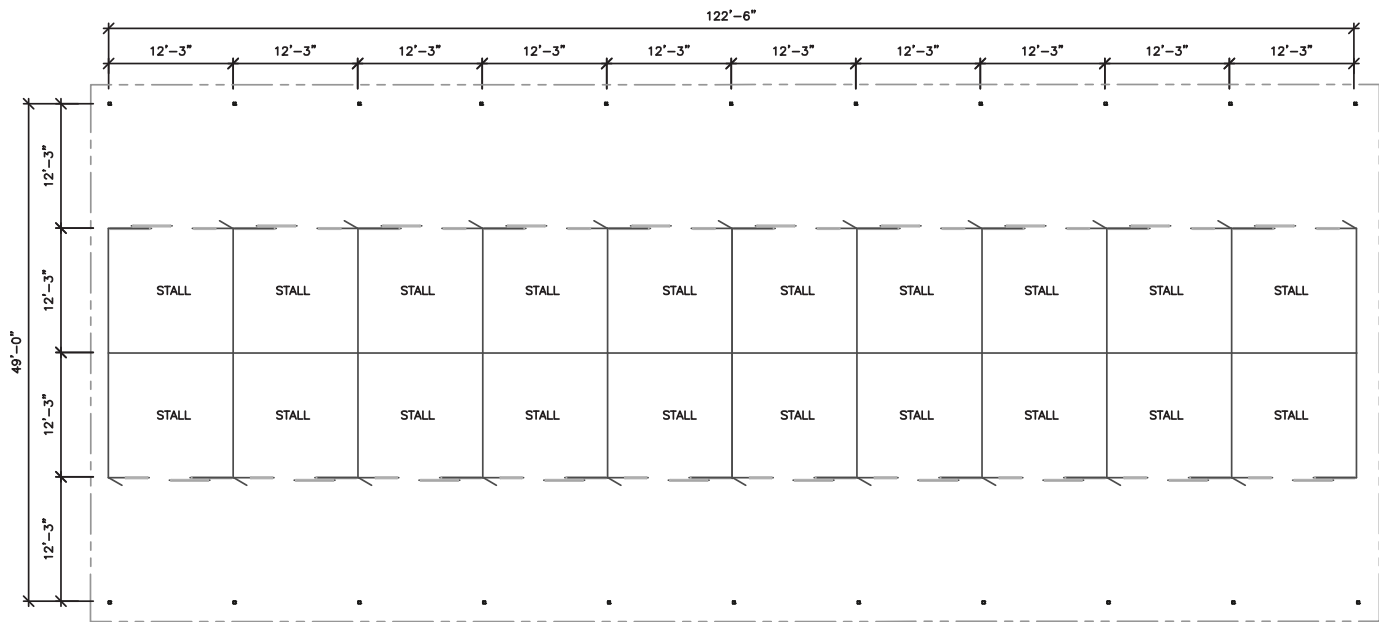

Back-to-Back Shedrow

18 Stall with Tack 14' Overhang



Base Description:

- 3/12 roof pitch
- 9' eave height
- 18" overhang at eaves and gable ends
- 14' overhangs posted at 12'
- Painted steel roofing and fascia
- 18 - 12'x12' stalls with solid divider walls
- 2 - 12'x12' tack rooms with 4070 steel entry door

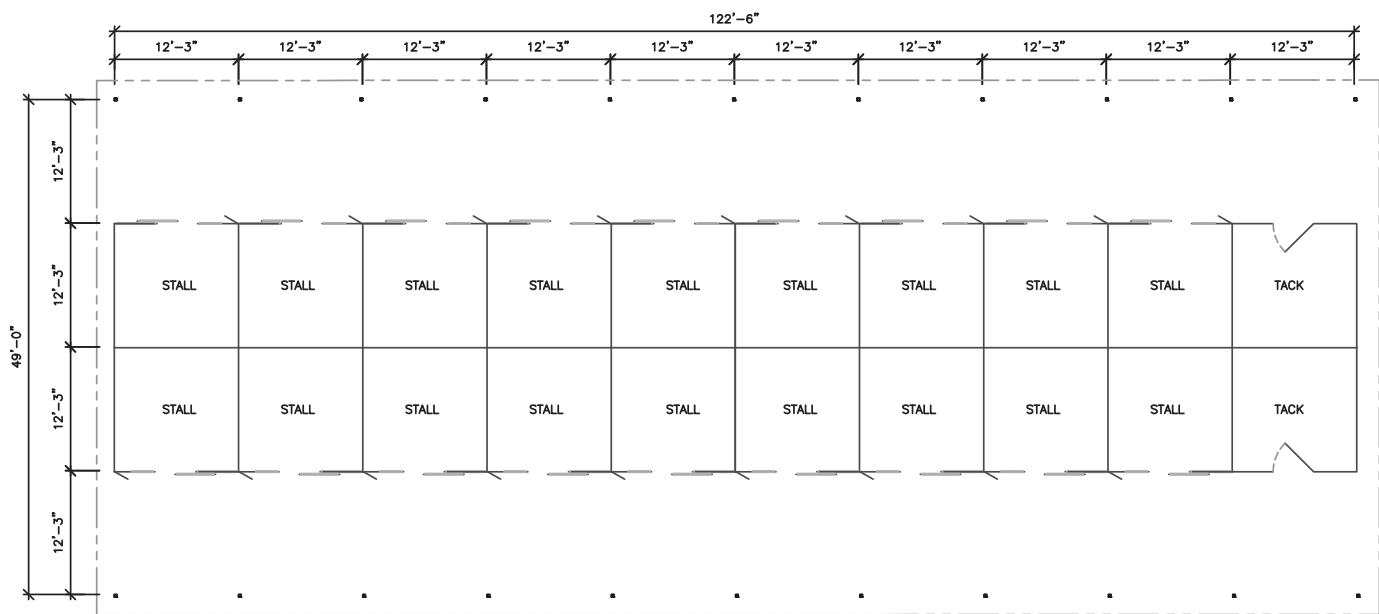

Specialty Shedrow

Two Stall with Hay Storage and Tack



Base Description:

- 3/12 roof pitch
- 9' eave height
- 14' overhang in front posted at 12'
- 18" overhang at eaves and gable ends
- 3"x3" porch posts
- Painted steel roofing and fascia
- 2 - 12'x12' stalls with 2/3 grill divider wall
- 1 - 12'x12' hay storage with 4' hinged grilled door and 6' solid sliding door
- 1 - 8'x12' tack room with 4070 steel entry door

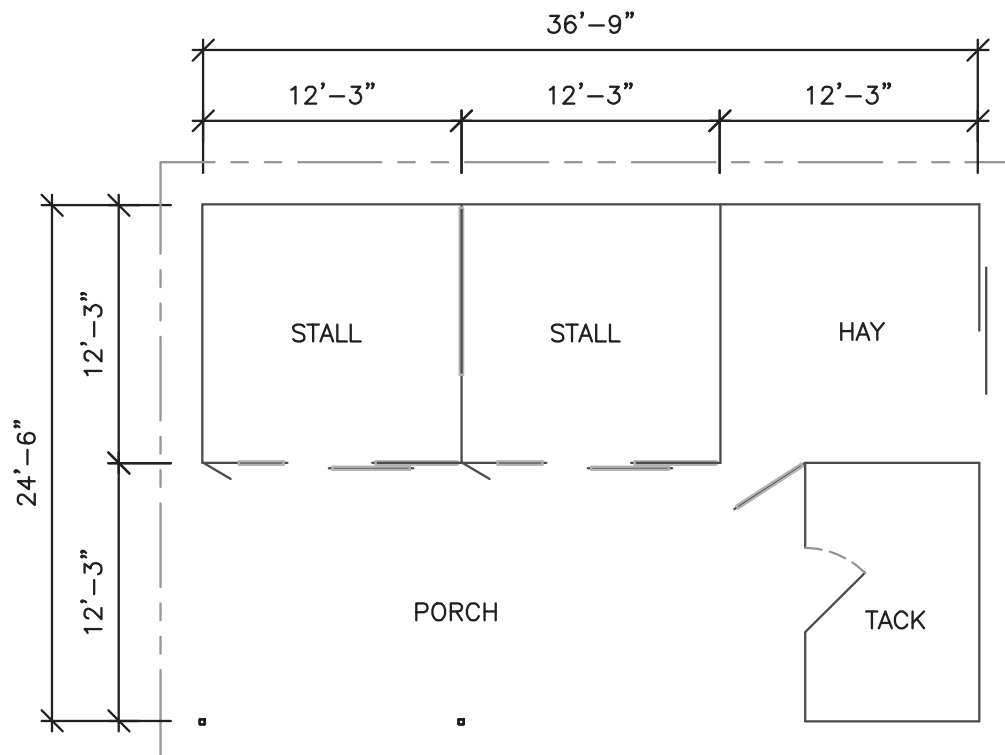

Specialty Shedrow

Three Stall with Hay Storage and Tack



Base Description:

- 3/12 roof pitch
- 9' eave height
- 14' overhang in front posted at 12'
- 18" overhang at eaves and gable ends
- Painted steel roofing and fascia
- Pair 12' breezeway doors
- 3 - 12'x12' stalls with 2/3 grill divider wall
- 1 - 8'x12' hay storage with 6' solid sliding door
- 1 - 8'x12' tack room with 4070 steel entry door

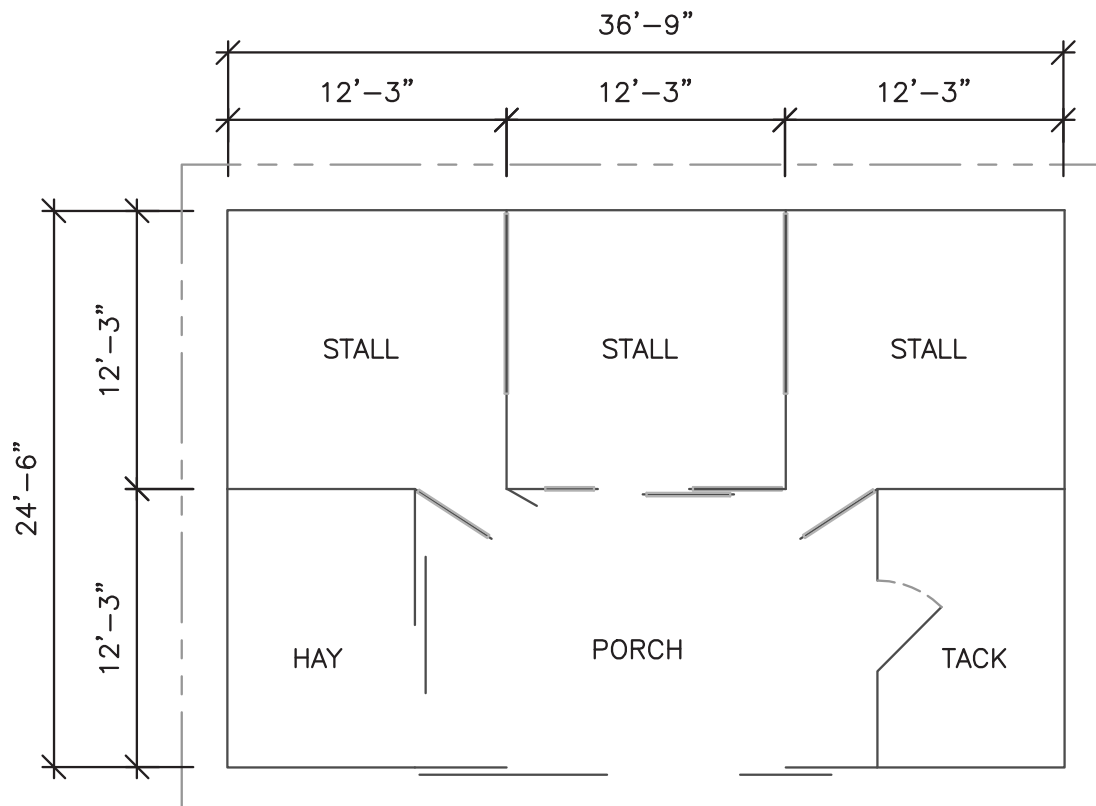

Specialty Shedrow

Two Stall with Hay Storage and Tack



Base Description:

- 3/12 roof pitch
- 9' eave height
- 14' overhang in front posted at 12'
- 18" overhang at eaves and gable ends
- 3"x3" porch posts
- Painted steel roofing and fascia
- 2 - 12'x12' stalls with 2/3 grill divider wall
- 1 - 12'x24' hay storage with 4070 steel entry door and 8' solid sliding door
- 1 - 12'x24' tack room with 4070 steel entry door

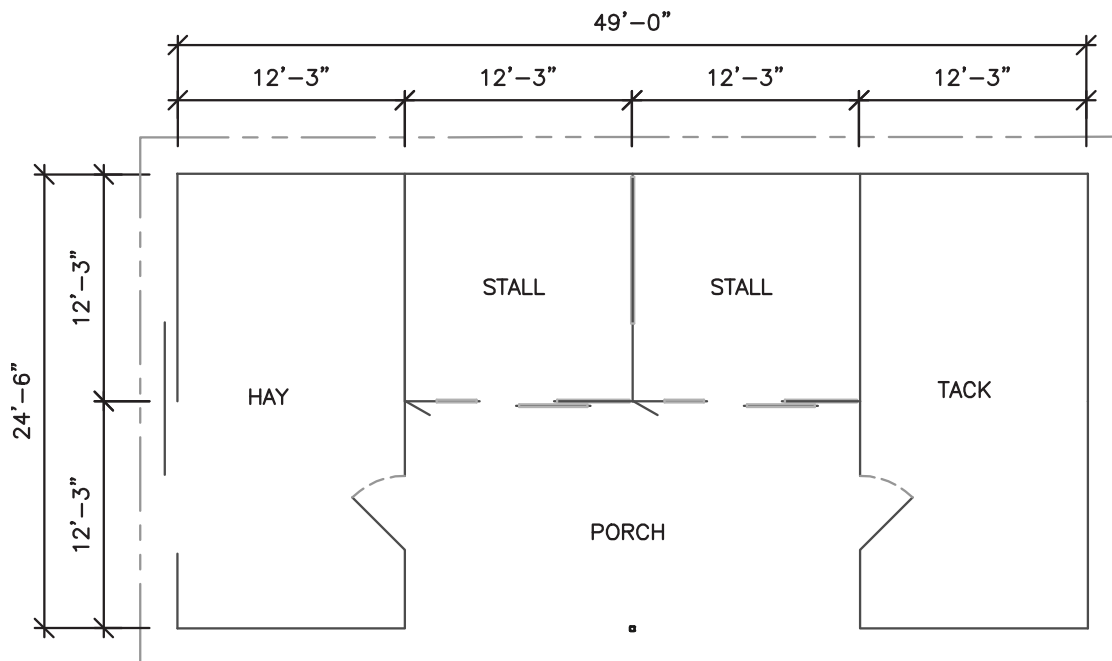

Specialty Shedrow

Three Stall with Hay Storage, Tack, and Wash



Base Description:

- 3/12 roof pitch
- 9' eave height
- 14' overhang in front posted at 12'
- 18" overhang at eaves and gable ends
- 3"x3" porch posts
- Painted steel roofing and fascia
- 3 - 12'x12' stalls with 2/3 grill divider wall
- 1 - 12'x24' hay storage with 4070 steel entry door and 8' solid sliding door
- 1 - 12'x12' tack room with 4070 steel entry door
- 1 - 12'x12' wash bay with 4" round tie post

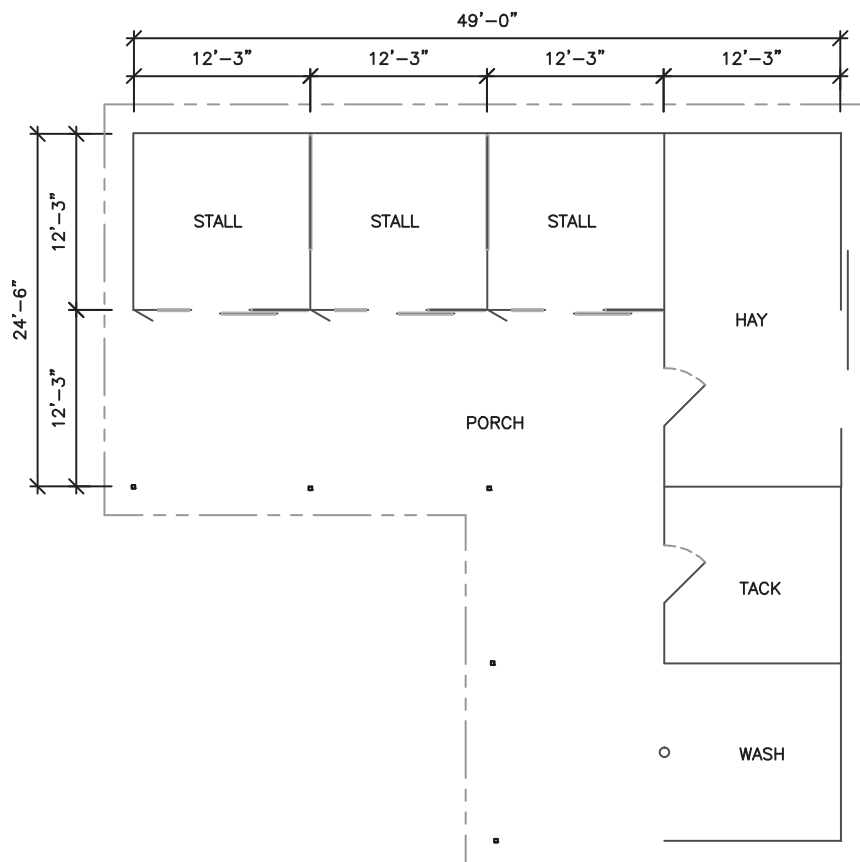

Single Breezeway Four Stall

Base Description:

- 3/12 roof pitch
- 9' eave height
- 18" overhang at eaves and gable ends
- Painted steel roofing and fascia
- 4 - 12'x12' stalls with 2/3 grill divider wall
- 12' breezeway with doors

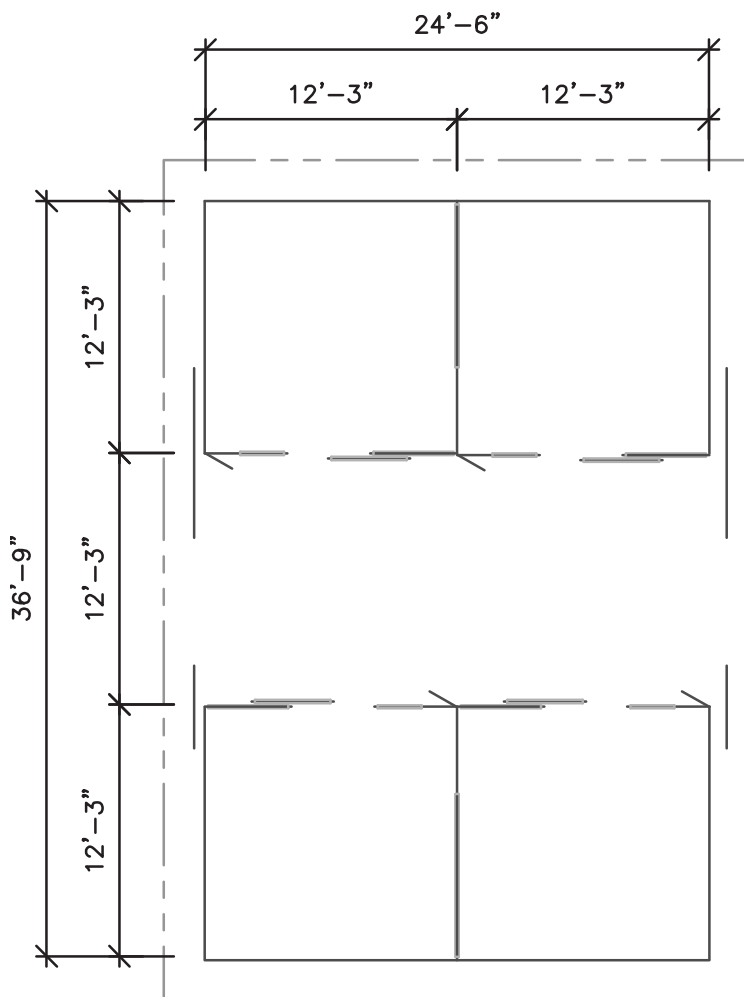

Single Breezeway Four Stall

Base Description:

- 3/12 roof pitch
- 9' eave height
- 18" overhang at eaves and gable ends
- Painted steel roofing and fascia
- 4 - 12'x12' stalls with 2/3 grill divider wall
- 16' breezeway with doors

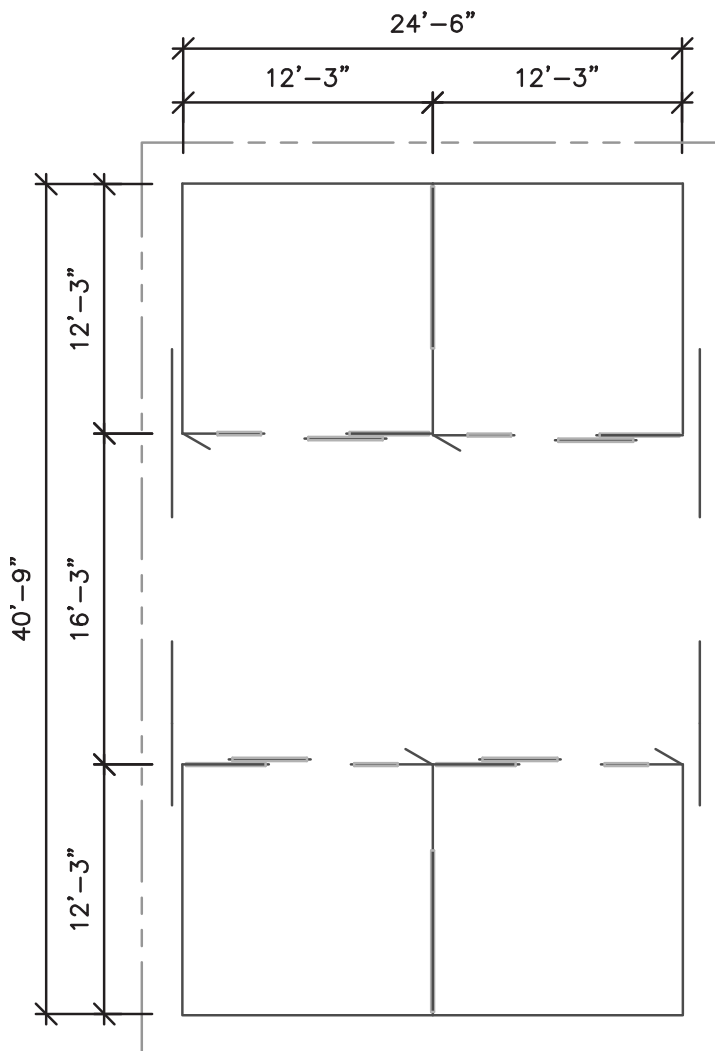

Single Breezeway

Three Stall with Tack

Base Description:

- 3/12 roof pitch
- 9' eave height
- 18" overhang at eaves and gable ends
- Painted steel roofing and fascia
- 3 - 12'x12' stalls with 2/3 grill divider wall
- 1 - 12'x12' tack with 4070 steel entry door
- 12' breezeway with doors

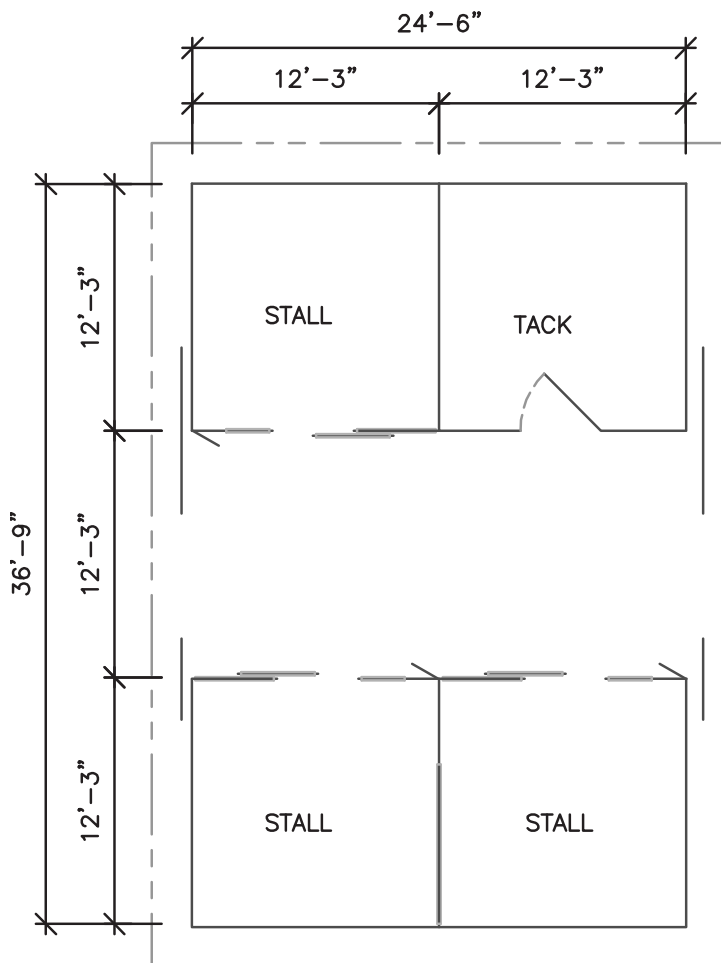

Single Breezeway

Three Stall with Tack

Base Description:

- 3/12 roof pitch
- 9' eave height
- 18" overhang at eaves and gable ends
- Painted steel roofing and fascia
- 3 - 12'x12' stalls with 2/3 grill divider wall
- 1 - 12'x12' tack with 4070 steel entry door
- 16' breezeway with doors

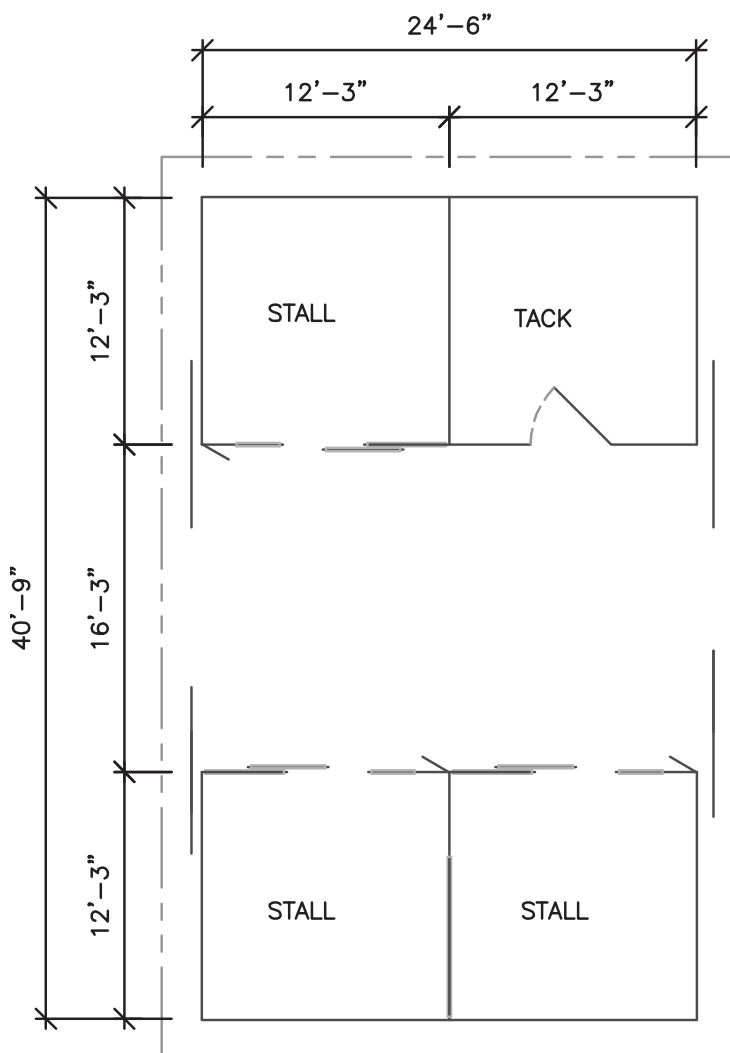

Single Breezeway

Three Stall with Tack

Base Description:

- 3/12 roof pitch
- 9' eave height
- 18" overhang at eaves and gable ends
- Painted steel roofing and fascia
- 2 - 12'x12' stalls
- 1 - 12'x16' stall with 2/3 grill divider wall
- 1 - 12'x16' tack with 4070 steel entry door and 8' pivot wall
- 12' breezeway with doors

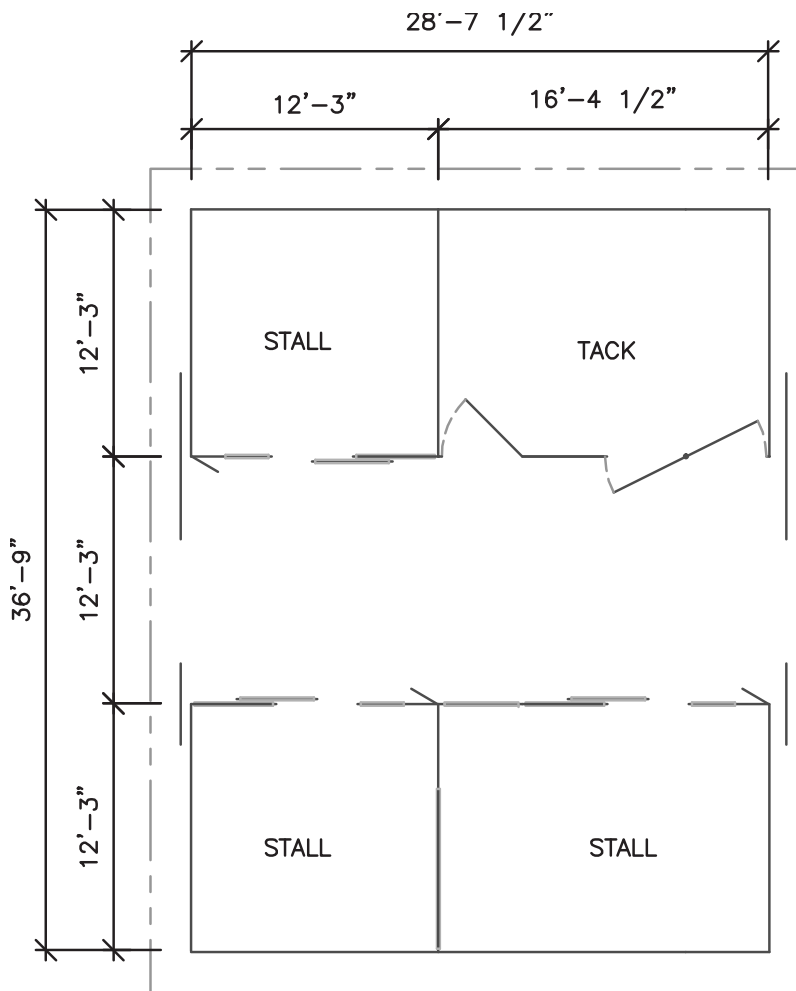

Single Breezeway

Three Stall with Tack

Base Description:

- 3/12 roof pitch
- 9' eave height
- 18" overhang at eaves and gable ends
- Painted steel roofing and fascia
- 2 - 12'x12' stalls
- 1 - 12'x16' stall with 2/3 grill divider wall
- 1 - 12'x16' tack with 4070 steel entry door and 8' pivot wall
- 16' breezeway with doors

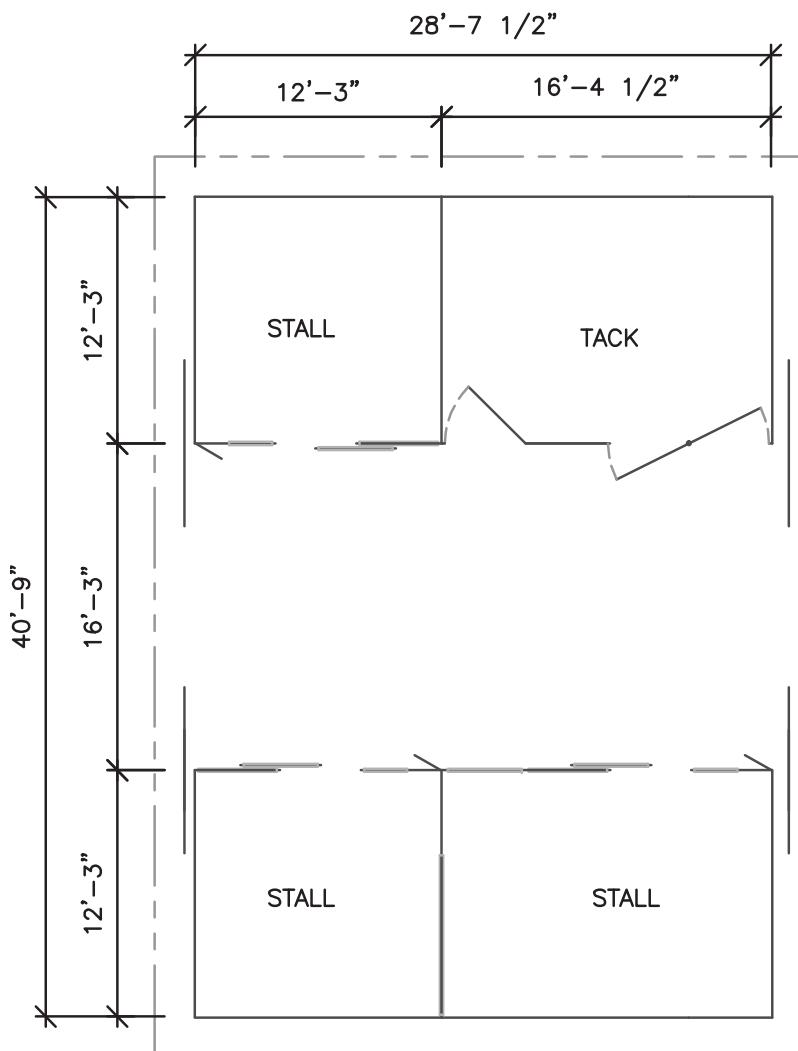

Single Breezeway

Two Stall with Tack and Hay Storage

Base Description:

- 3/12 roof pitch
- 9' eave height
- 18" overhang at eaves and gable ends
- Painted steel roofing and fascia
- 2 - 12'x12' stalls with 2/3 grill divider wall
- 1 - 12'x12' tack with 4070 steel entry door
- 1 - 12'x12' open hay storage
- 12' breezeway with doors

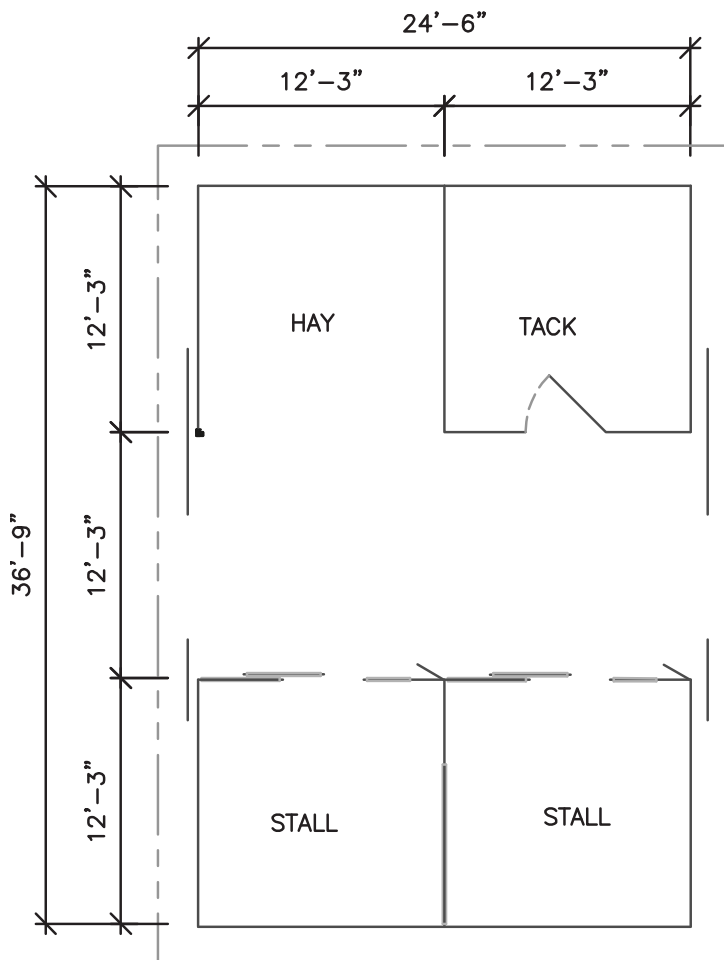

Single Breezeway

Two Stall with Tack and Hay Storage

Base Description:

- 3/12 roof pitch
- 9' eave height
- 18" overhang at eaves and gable ends
- Painted steel roofing and fascia
- 2 - 12'x12' stalls with 2/3 grill divider wall
- 1 - 12'x12' tack with 4070 steel entry door
- 1 - 12'x12' open hay storage
- 16' breezeway with doors

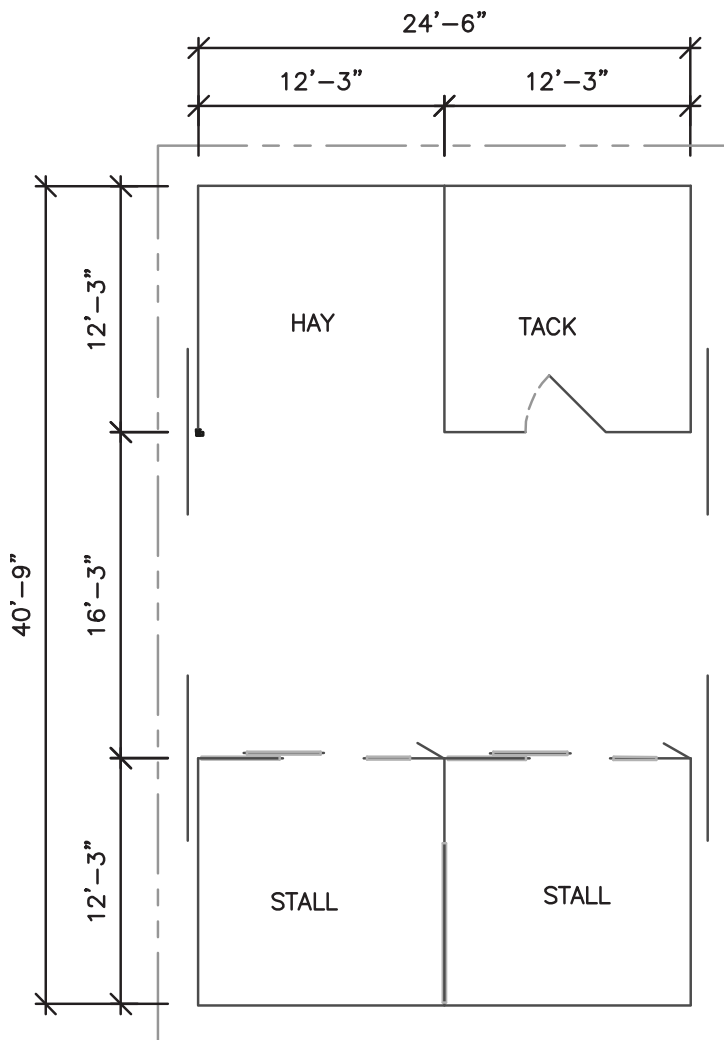

Single Breezeway

Four Stall with Tack and Hay Storage

Base Description:

- 3/12 roof pitch
- 9' eave height
- 18" overhang at eaves and gable ends
- Painted steel roofing and fascia
- 4 - 12'x12' stalls with 2/3 grill divider wall
- 1 - 12'x12' tack with 4070 steel entry door
- 1 - 12'x12' open hay storage
- 12' breezeway with doors

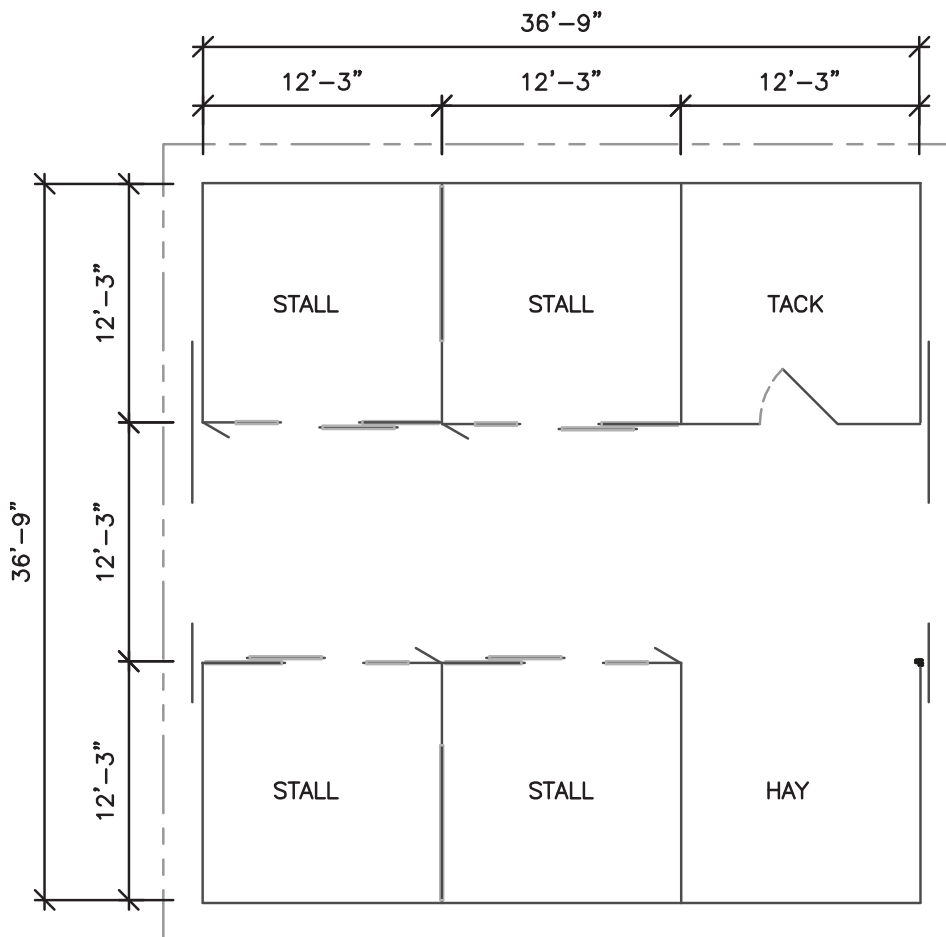

Single Breezeway

Four Stall with Tack and Hay Storage

Base Description:

- 3/12 roof pitch
- 9' eave height
- 18" overhang at eaves and gable ends
- Painted steel roofing and fascia
- 4 - 12'x12' stalls with 2/3 grill divider wall
- 1 - 12'x12' tack with 4070 steel entry door
- 1 - 12'x12' open hay storage
- 16' breezeway with doors

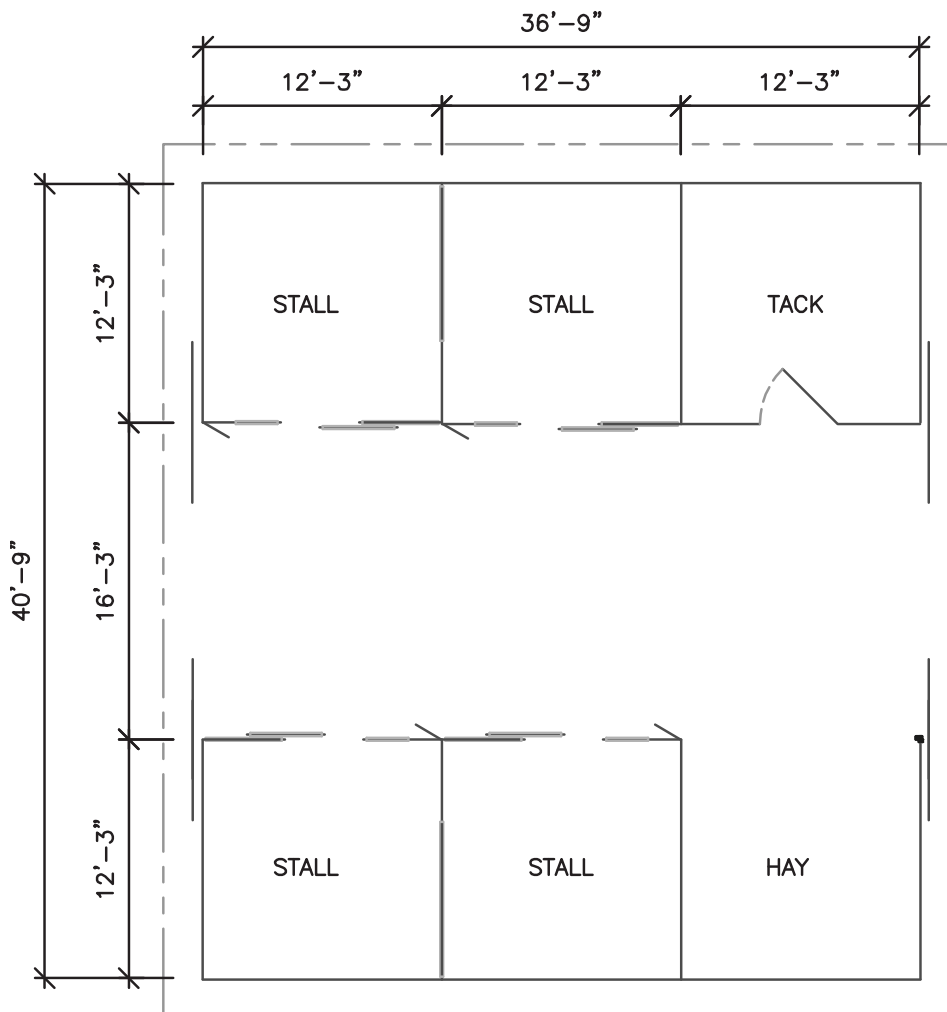

Single Breezeway

Two Stall with Tack and Hay Storage

Base Description:

- 3/12 roof pitch
- 9' eave height
- 18" overhang at eaves and gable ends
- Painted steel roofing and fascia
- 1 - 12'x12' stall with 2/3 grill divider wall
- 1 - 12'x16' stall with 2/3 grill divider wall
- 1 - 12'x16' tack with 4070 steel entry door and 8' pivot wall
- 1 - 12'x12' open hay storage
- 12' breezeway with doors

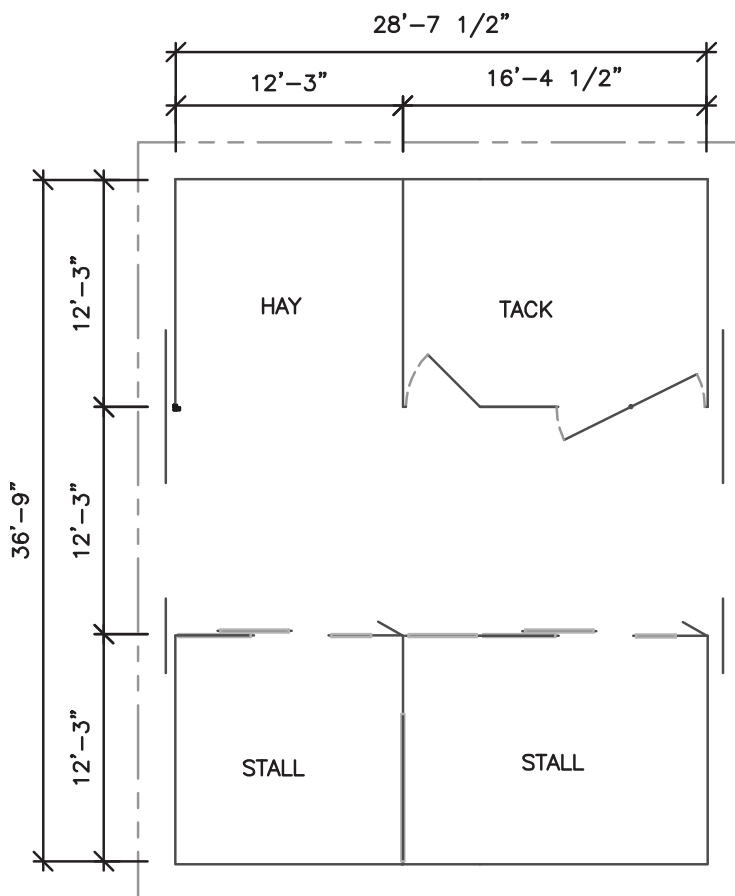

Single Breezeway

Two Stall with Tack and Hay Storage

Base Description:

- 3/12 roof pitch
- 9' eave height
- 18" overhang at eaves and gable ends
- Painted steel roofing and fascia
- 1 - 12'x12' stall with 2/3 grill divider wall
- 1 - 12'x16' stall with 2/3 grill divider wall
- 1 - 12'x16' tack with 4070 steel entry door and 8' pivot wall
- 1 - 12'x12' open hay storage
- 16' breezeway with doors

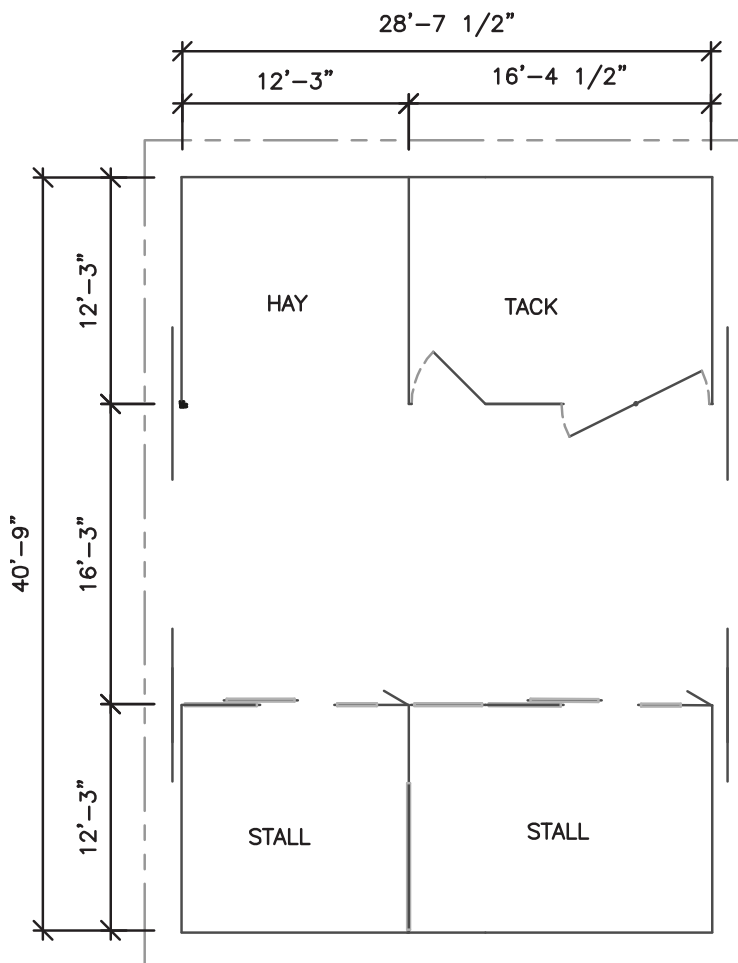

Single Breezeway

Four Stall with Tack and Hay Storage

Base Description:

- 3/12 roof pitch
- 9' eave height
- 18" overhang at eaves and gable ends
- Painted steel roofing and fascia
- 4 - 12'x12' stalls with 2/3 grill divider wall
- 1 - 12'x16' tack with 4070 steel entry door and 8' pivot wall
- 1 - 12'x16' open hay storage
- 12' breezeway with doors

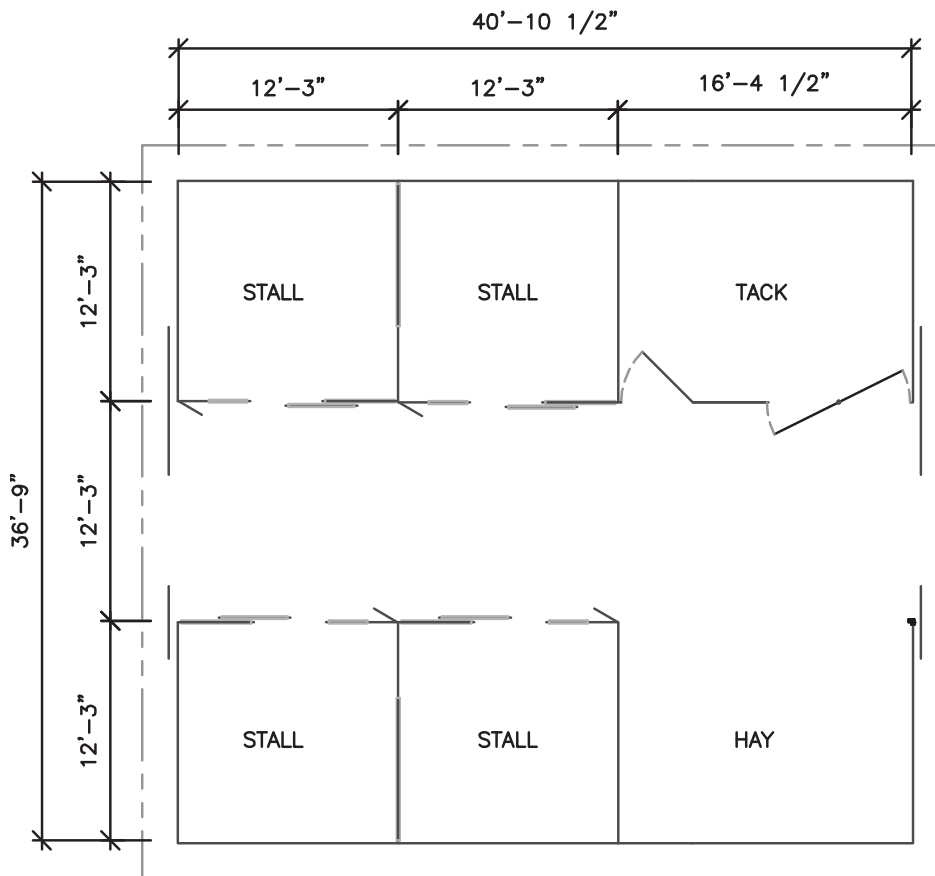

Single Breezeway

Four Stall with Tack and Hay Storage

Base Description:

- 3/12 roof pitch
- 9' eave height
- 18" overhang at eaves and gable ends
- Painted steel roofing and fascia
- 4 - 12'x12' stalls with 2/3 grill divider wall
- 1 - 12'x16' tack with 4070 steel entry door and 8' pivot wall
- 1 - 12'x16' open hay storage
- 16' breezeway with doors

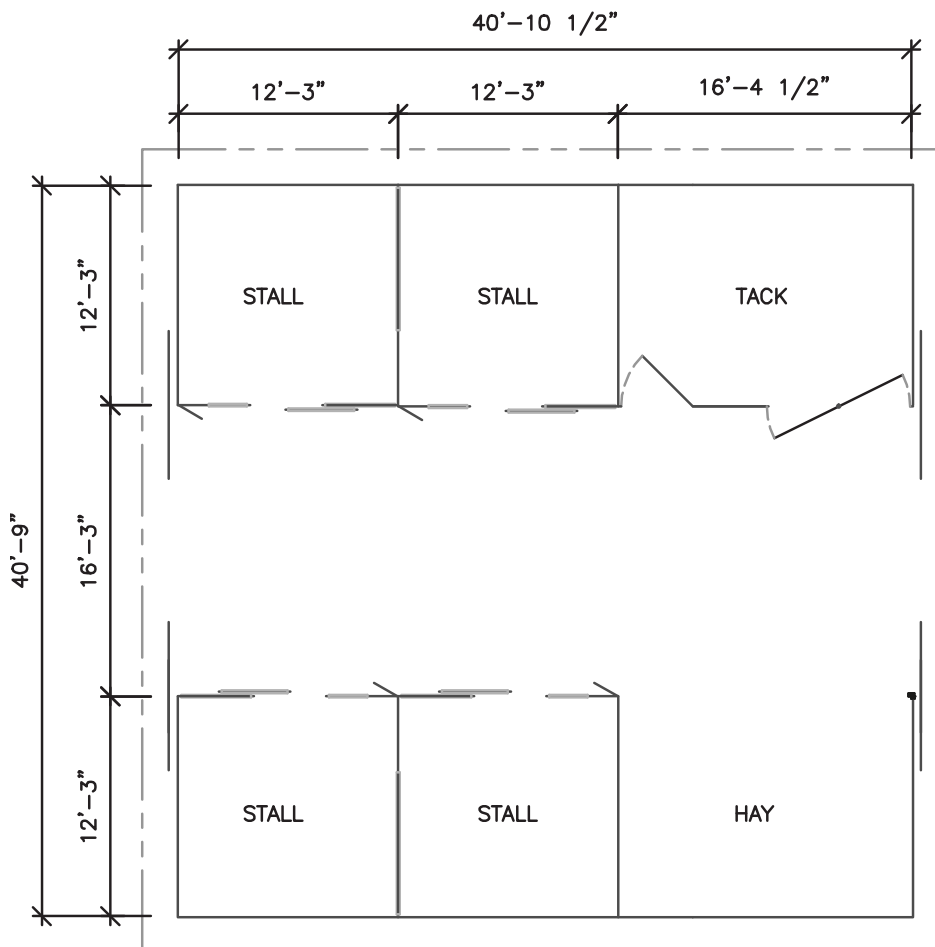

Single Breezeway

Three Stall with Tack, Hay Storage, and Wash

Base Description:

- 3/12 roof pitch
- 9' eave height
- 18" overhang at eaves and gable ends
- Painted steel roofing and facia
- 3 - 12'x12' stalls with 2/3 grill divider wall
- 1 - 12'x12' tack with 4070 steel entry door
- 1 - 12'x12' open hay storage
- 1 - 12'x12' wash with 4" cross tie post and rings
- 12' breezeway with doors

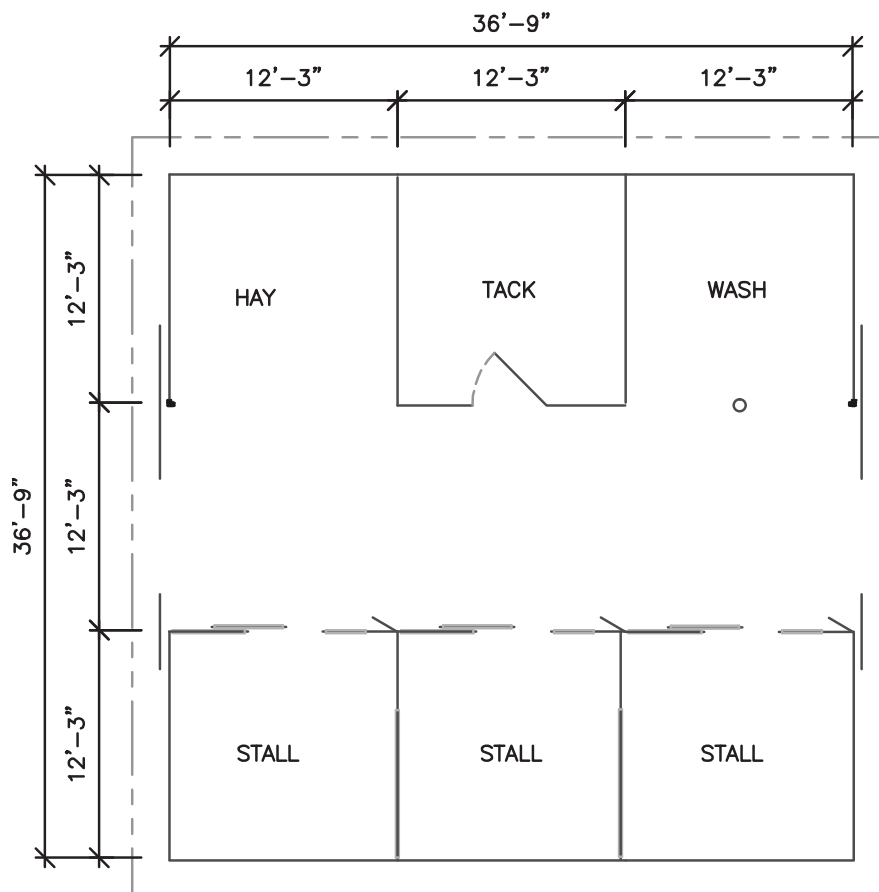

Single Breezeway

Three Stall with Tack, Hay Storage, and Wash

Base Description:

- 3/12 roof pitch
- 9' eave height
- 18" overhang at eaves and gable ends
- Painted steel roofing and fascia
- 3 - 12'x12' stalls with 2/3 grill divider wall
- 1 - 12'x12' tack with 4070 steel entry door
- 1 - 12'x12' open hay storage
- 1 - 12'x12' wash with 4" cross tie post and rings
- 16' breezeway with doors

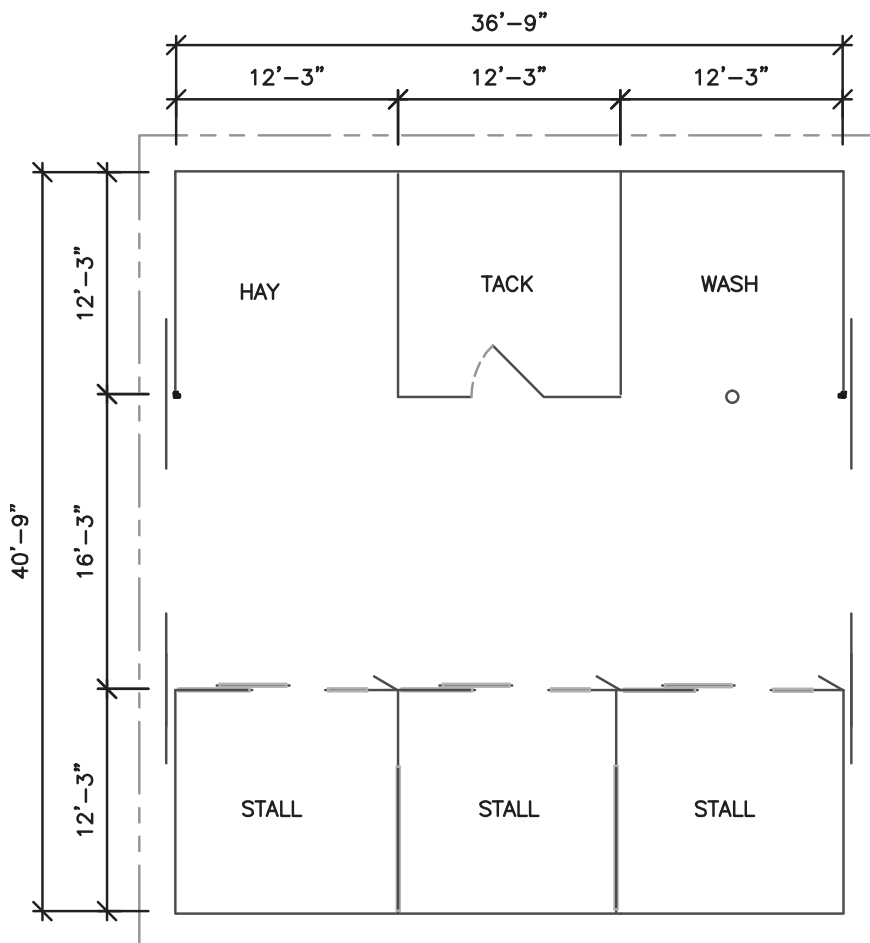

Single Breezeway

Five Stall with Tack, Hay Storage, and Wash

Base Description:

- 3/12 roof pitch
- 9' eave height
- 18" overhang at eaves and gable ends
- Painted steel roofing and fascia
- 4 - 12'x12' stalls with 2/3 grill divider wall
- 1 - 12'x16' stall with 2/3 grill divider wall
- 1 - 12'x16' tack with 4070 steel entry door and 8' pivot wall
- 1 - 12'x16' hay storage with 6' solid sliding door
- 1 - 12'x16' wash with divider wall and 2 tie rings
- 12' breezeway with doors

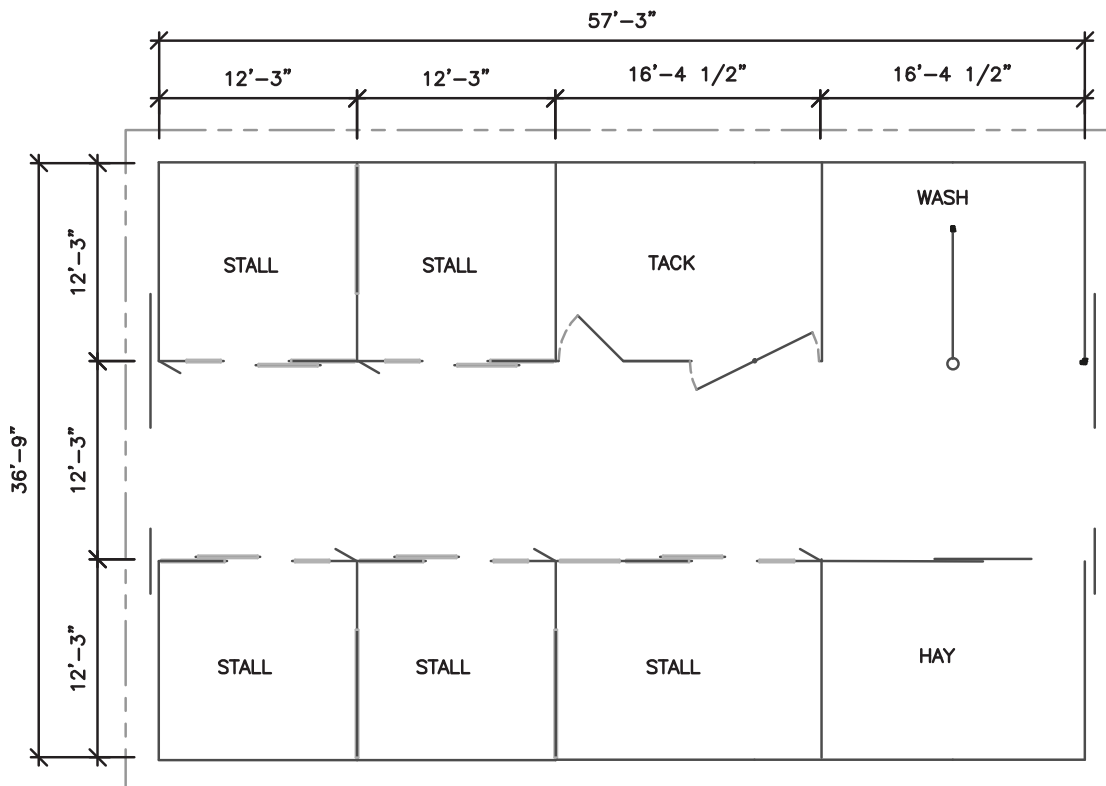

Single Breezeway

Five Stall with Tack, Hay Storage, and Wash

Base Description:

- 3/12 roof pitch
- 9' eave height
- 18" overhang at eaves and gable ends
- Painted steel roofing and fascia
- 4 - 12'x12' stalls with 2/3 grill divider wall
- 1 - 12'x16' stall with 2/3 grill divider wall
- 1 - 12'x16' tack with 4070 steel entry door and 8' pivot wall
- 1 - 12'x16' hay storage with 6' solid sliding door
- 1 - 12'x16' wash with divider wall and 2 tie rings
- 16' breezeway with doors

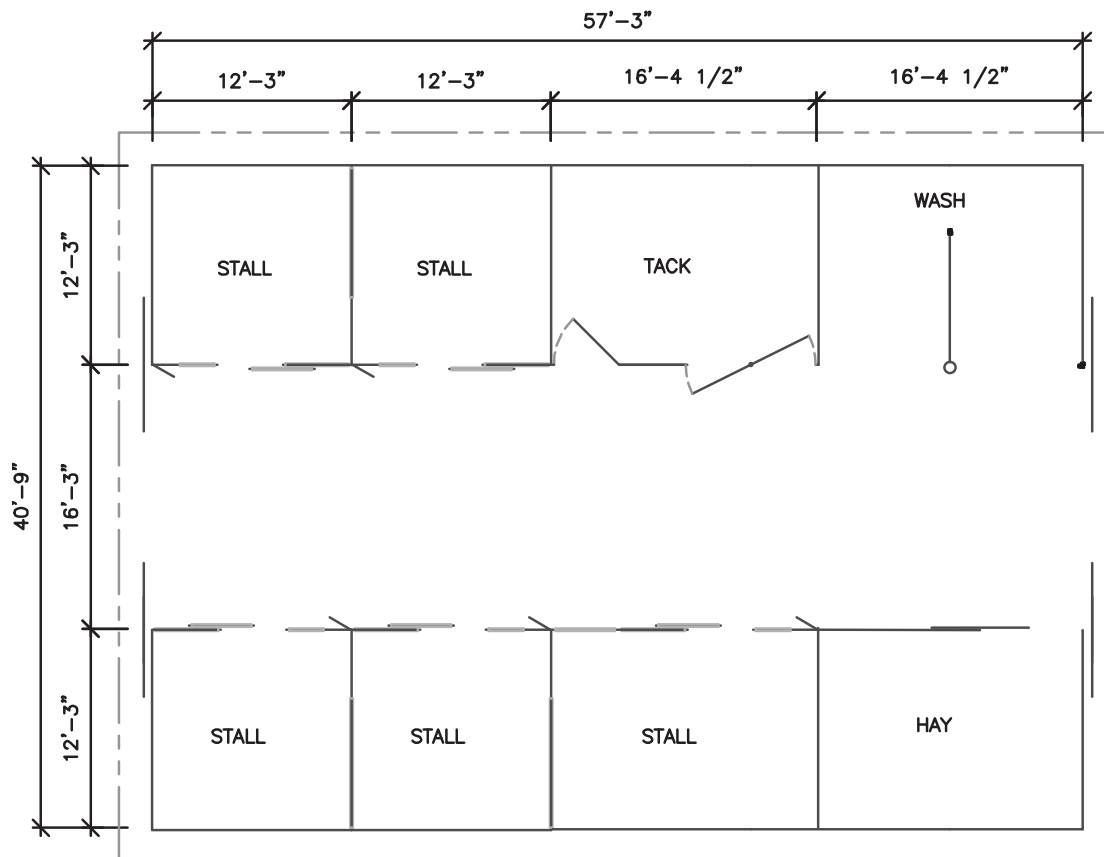

Cross Breezeway

12 Stall with Tack, Hay Storage, Wash, and Saddle/Groom

Base Description:

- 3/12 roof pitch
- 9' eave height
- 18" overhang at eaves and gable ends
- Painted steel roofing and fascia
- 12 - 12'x12' stalls with 2/3 grill divider wall
- 1 - 12'x16' tack with 4070 steel entry door and 8' pivot wall
- 1 - 12'x16' hay storage with 8' solid sliding door
- 1 - 12'x16' wash with tie post
- 1 - 12'x16' saddle/groom bay
- 2 - 16' side gable porches posted at 12'
- 12' breezeway with doors (four pair)
- Side porches are gable porches

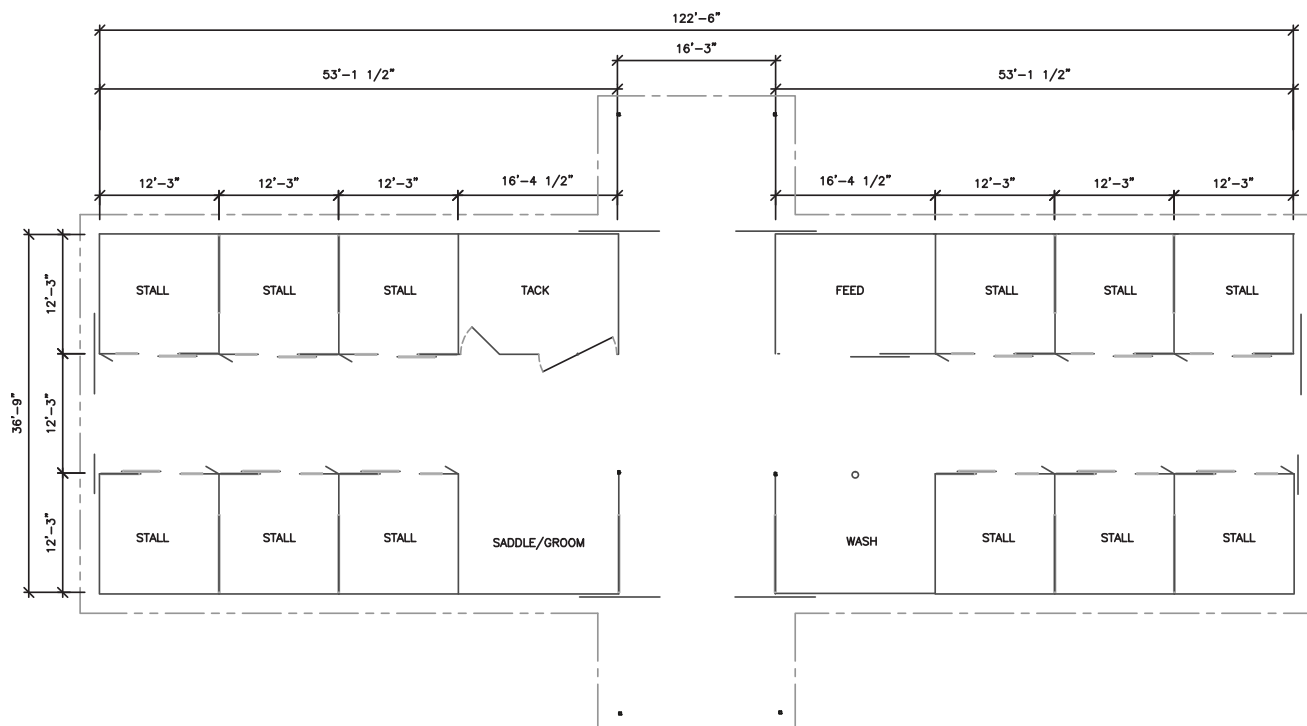

Cross Breezeway

12 Stall with Tack, Hay Storage, Wash, and Saddle/Groom

Base Description:

- 3/12 roof pitch
- 9' eave height
- 18" overhang at eaves and gable ends
- Painted steel roofing and fascia
- 12 - 12'x12' stalls with 2/3 grill divider wall
- 1 - 12'x16' tack with 4070 steel entry door and 8' pivot wall
- 1 - 12'x16' hay storage with 8' solid sliding door
- 1 - 12'x16' wash with tie post
- 1 - 12'x16' saddle/groom bay
- 2 - 16' side gable porches posted at 12'
- 16' breezeway with doors (four pair)
- Side porches are gable porches

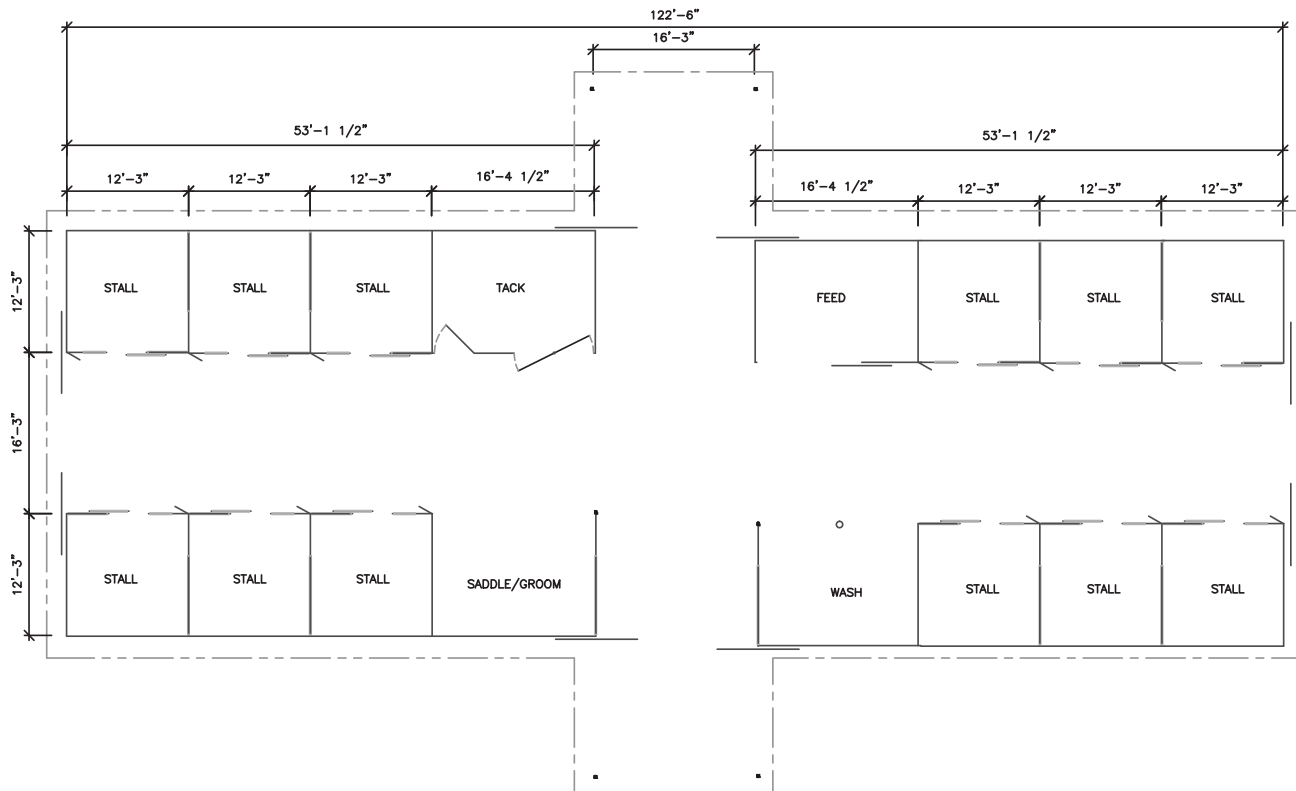

Cross Breezeway

12 Stall with Tack, Hay Storage, Wash, and Saddle/Groom

Base Description:

- 3/12 roof pitch
- 9' eave height
- 18" overhang at eaves and gable ends
- Painted steel roofing and fascia
- 12 - 12'x12' stalls with 2/3 grill divider wall
- 1 - 12'x16' tack with 4070 steel entry door and 8' pivot wall
- 1 - 12'x16' hay storage with 6' solid sliding door
- 1 - 12'x12' wash with tie post
- 1 - 12'x16' saddle/groom bay
- 12' breezeway with doors (four pair)

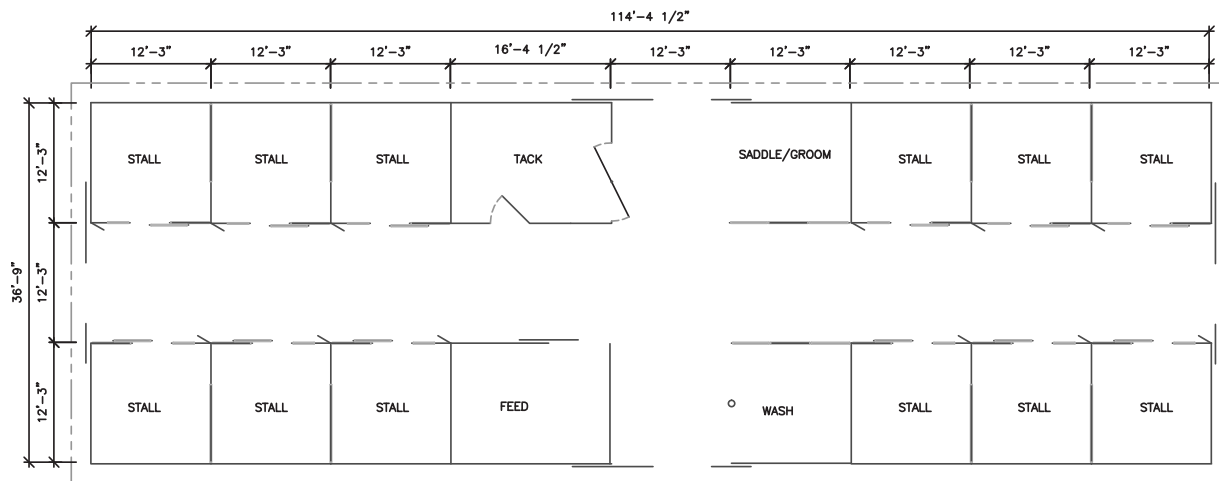

Cross Breezeway

12 Stall with Tack, Hay Storage, Wash, and Saddle/Groom

Base Description:

- 3/12 roof pitch
- 9' eave height
- 18" overhang at eaves and gable ends
- Painted steel roofing and fascia
- 12 - 12'x12' stalls with 2/3 grill divider wall
- 1 - 12'x16' tack with 4070 steel entry door and 8' pivot wall
- 1 - 12'x16' hay storage with 6' solid sliding door
- 1 - 12'x12' wash with tie post
- 1 - 12'x16' saddle/groom bay
- 12' cross breezeway with doors (two-pair)
- 16' breezeway with doors (two-pair)

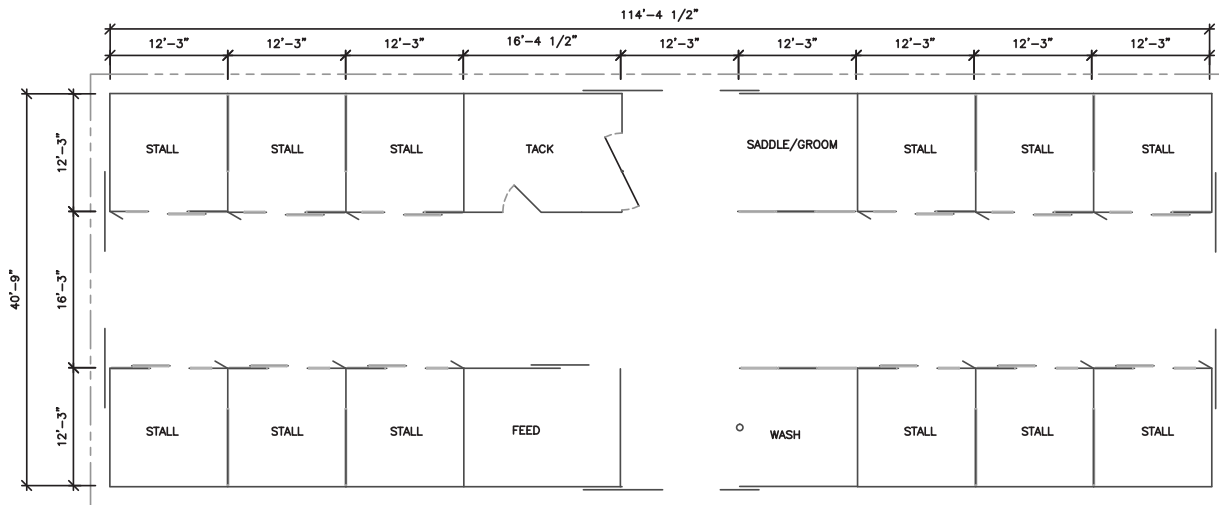

Back-to-Back Breezeway

8 Stall

Base Description:

- 3/12 roof pitch
- 9' eave height
- 18" overhang at eaves and gable ends
- Painted steel roofing and fascia
- 8 - 12'x12' stalls with 2/3 grill divider wall
- 12' breezeway with doors

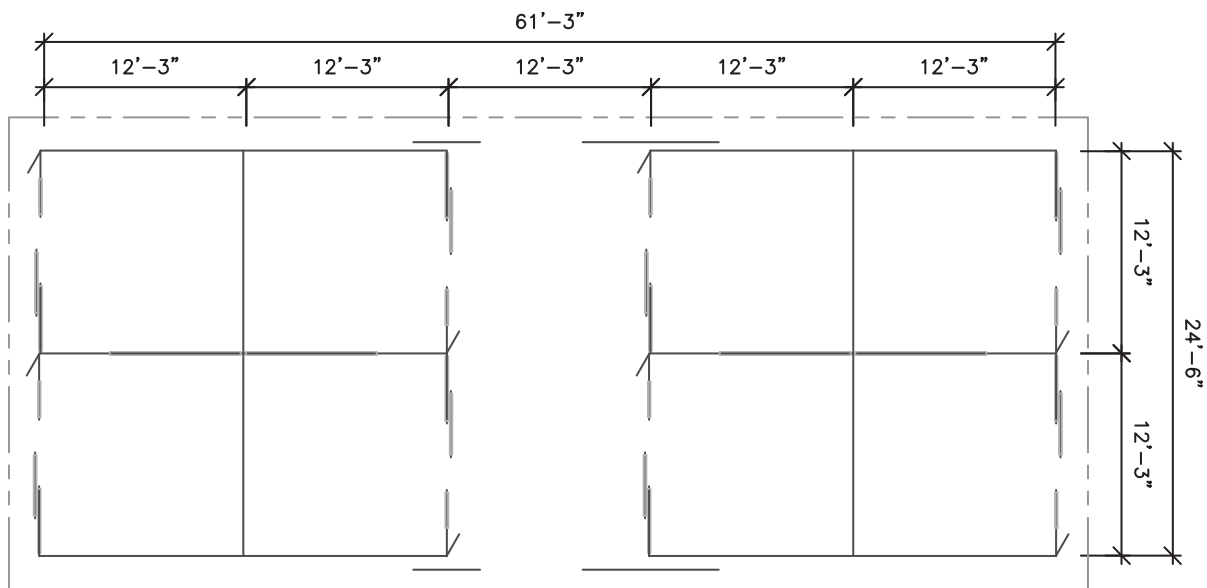

Back-to-Back Breezeway

16 Stall with Wash and Tack

Base Description:

- 3/12 roof pitch
- 9' eave height
- 18" overhang at eaves and gable ends
- Painted steel roofing and fascia
- 16 - 12'x12' stalls with 2/3 grill divider wall
- 2 - 12'x12' wash bays
- 2 - 12'x12' tack room with 4070 steel entry door
- 12' breezeway with doors

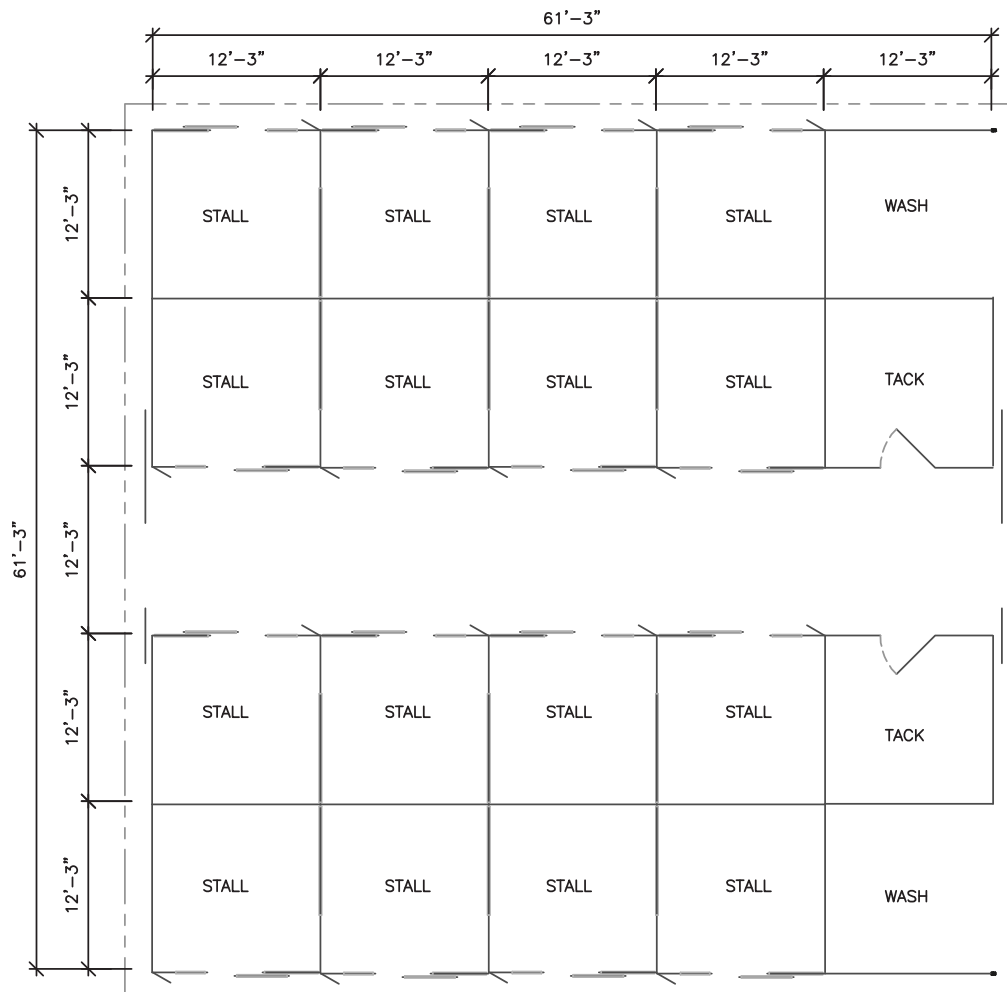

Back-to-Back Breezeway

16 Stall with Wash, Tack, Feed, and Office

Base Description:

- 3/12 roof pitch
- 9' eave height
- 18" overhang at eaves and gable ends
- Painted steel roofing and fascia
- 16 - 12'x12' stalls with 2/3 grill divider wall
- 2 - 12'x12' wash bays
- 2 - 12'x12' tack room with 4070 steel entry door
- 1 - 12'x24' office with 4070 steel entry door
- 1 - 12'x24' feed room with 4070 steel entry door and 8' solid sliding door
- 12' breezeway with doors

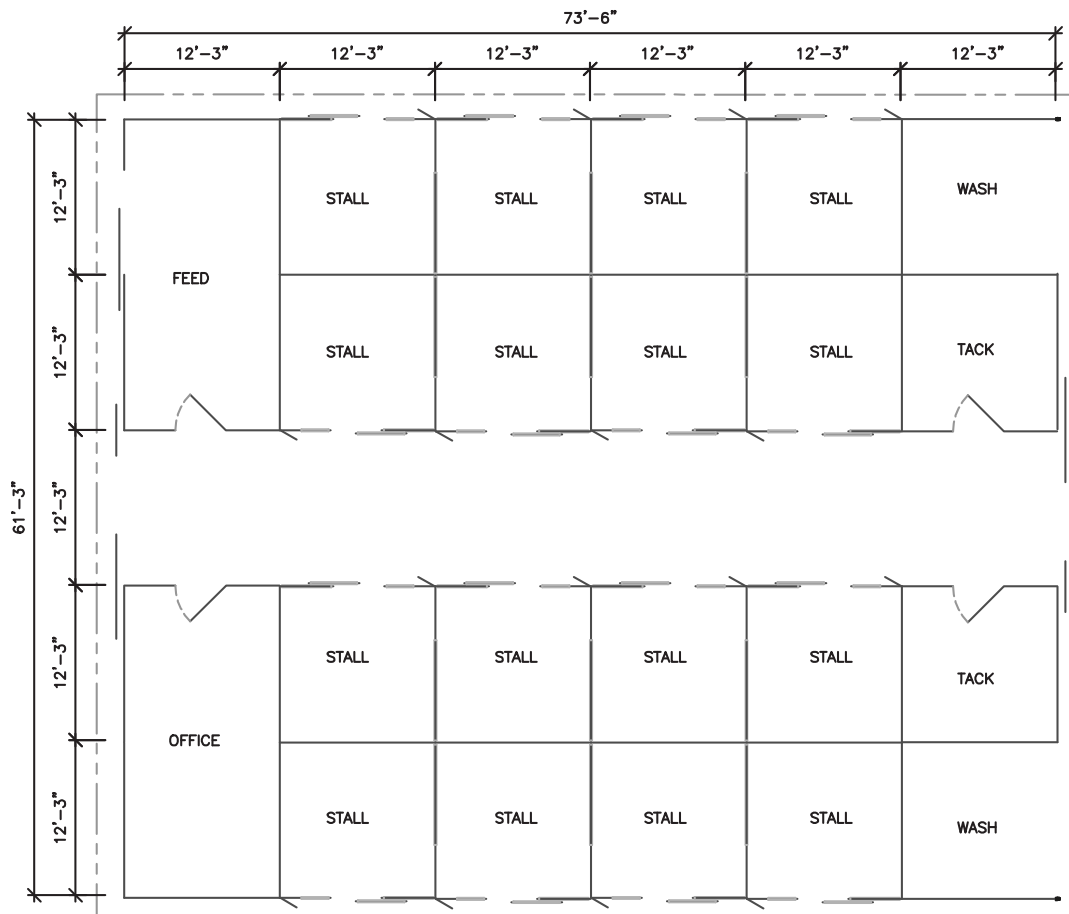

Back-to-Back Breezeway

8 Stall with 10' porch

Base Description:

- 3/12 roof pitch
- 9' eave height
- 18" overhang at eaves and gable ends
- Painted steel roofing and fascia
- 8 - 12'x12' stalls with 2/3 grill divider wall
- 12' breezeway with doors
- 10' side porches posted at 8'

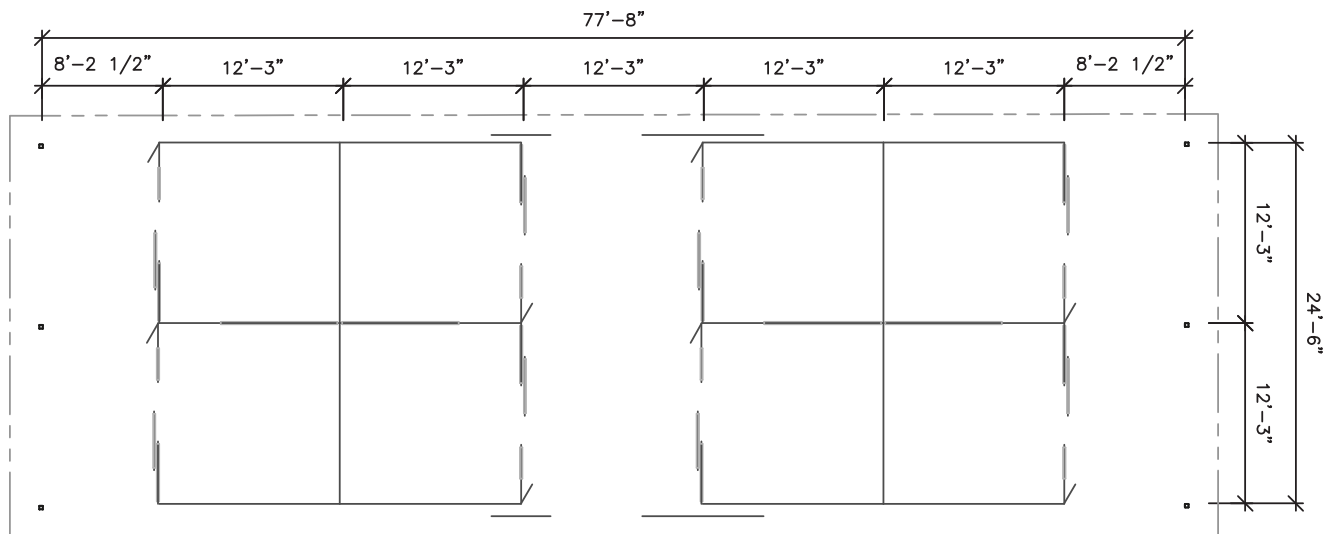

Back-to-Back Breezeway

8 Stall with 14' porch

Base Description:

- 3/12 roof pitch
- 9' eave height
- 18" overhang at eaves and gable ends
- Painted steel roofing and fascia
- 8 - 12'x12' stalls with 2/3 grill divider wall
- 12' breezeway with doors
- 14' side porches posted at 12'

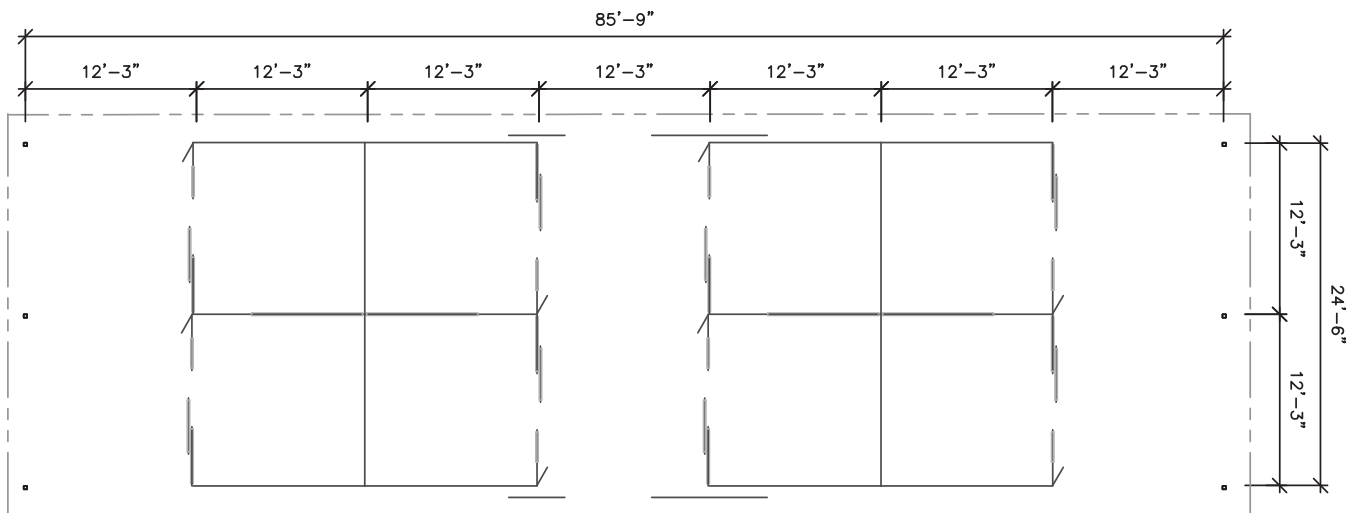

Back-to-Back Breezeway

16 Stall with Wash, Tack, Feed, Office and 10' porch

Base Description:

- 3/12 roof pitch
- 9' eave height
- 18" overhang at eaves and gable ends
- Painted steel roofing and fascia
- 16 - 12'x12' stalls with 2/3 grill divider wall
- 2 - 12'x12' wash bays
- 2 - 12'x12' tack room with 4070 steel entry door
- 1 - 12'x24' office with 4070 steel entry door
- 1 - 12'x24' feed room with 4070 steel entry door and 8' solid sliding door
- 12' breezeway with doors
- 10' side porches posted at 8'

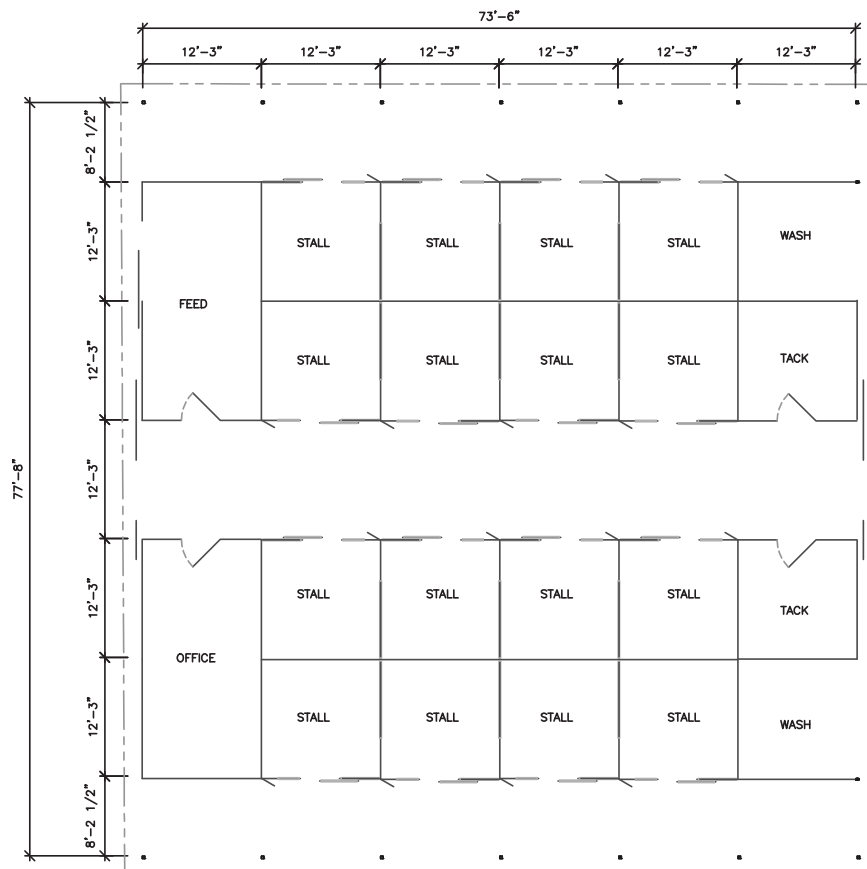

Back-to-Back Breezeway

16 Stall with Wash, Tack, Feed, Office and 14' porch

Base Description:

- 3/12 roof pitch
- 9' eave height
- 18" overhang at eaves and gable ends
- Painted steel roofing and fascia
- 16 - 12'x12' stalls with 2/3 grill divider wall
- 2 - 12'x12' wash bays
- 2 - 12'x12' tack room with 4070 steel entry door
- 1 - 12'x24' office with 4070 steel entry door
- 1 - 12'x24' feed room with 4070 steel entry door and 8' solid sliding door
- 12' breezeway with doors
- 14' side porches posted at 12'

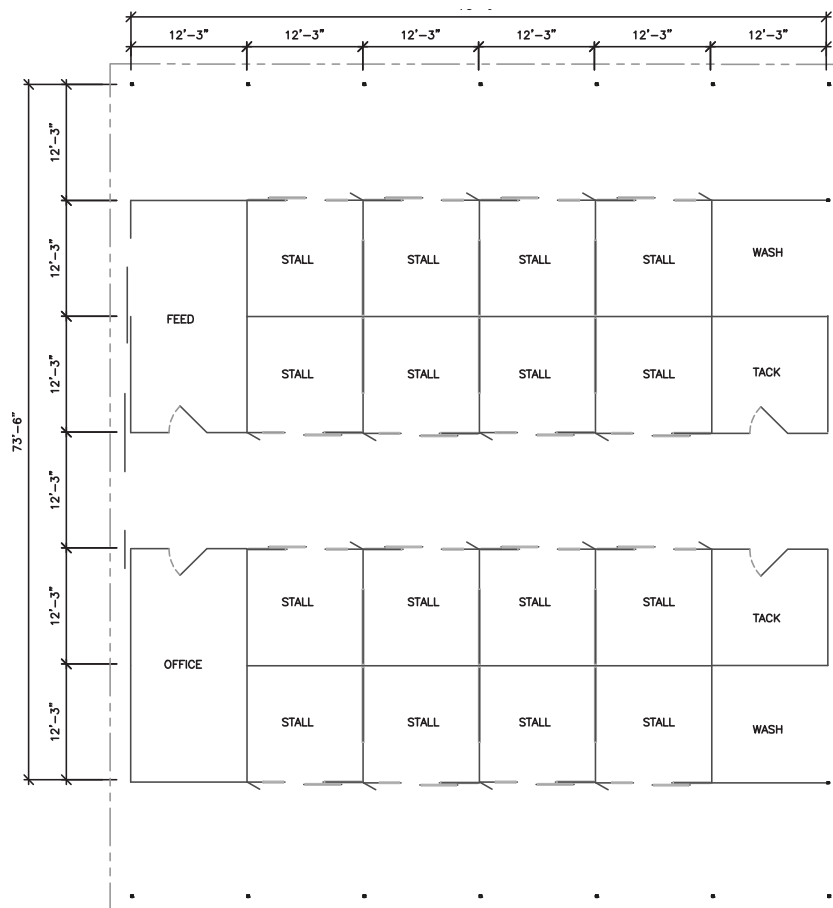

Back-to-Back Breezeway

16 Stall with Wash, Tack, and 10' porch

Base Description:

- 3/12 roof pitch
- 9' eave height
- 18" overhang at eaves and gable ends
- Painted steel roofing and fascia
- 16 - 12'x12' stalls with 2/3 grill divider wall
- 2 - 12'x12' wash bays
- 2 - 12'x12' tack room with 4070 steel entry door
- 12' breezeway with doors
- 10' side porches posted at 8'

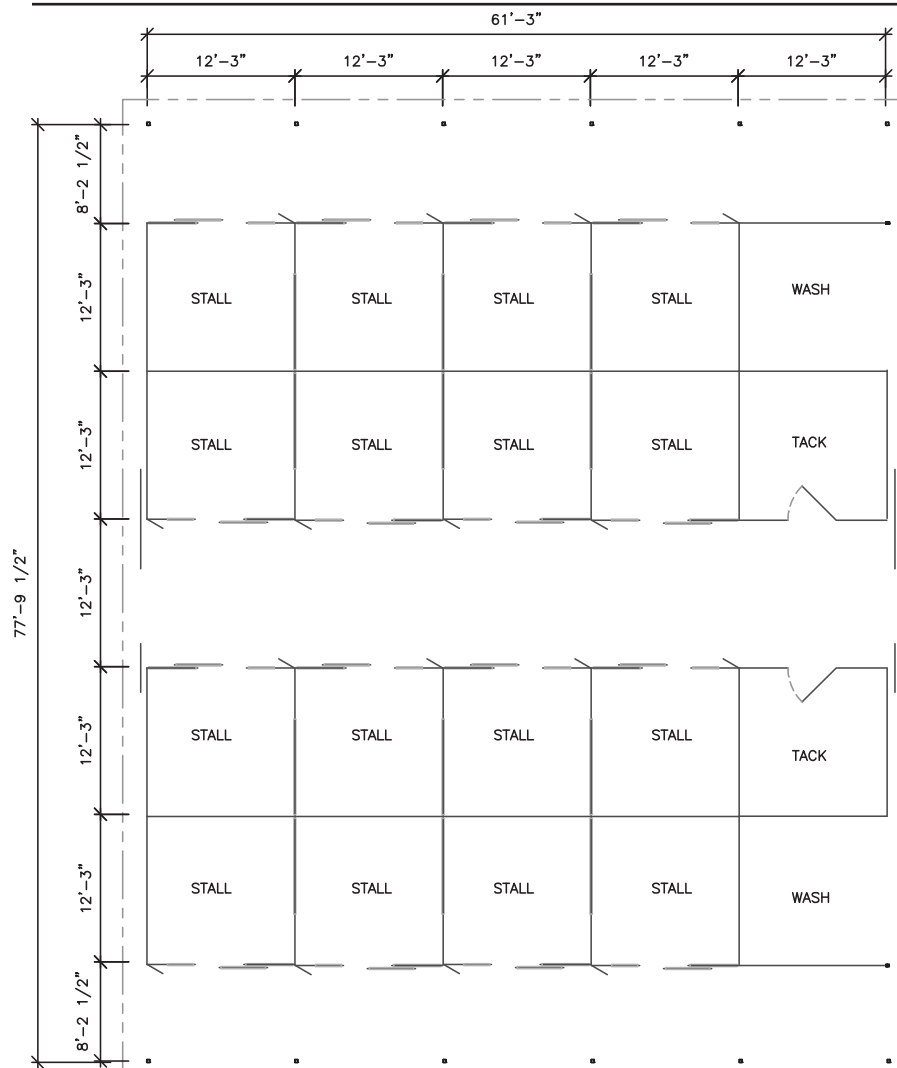

Back-to-Back Breezeway

16 Stall with Wash, Tack, and 14' porch

Base Description:

- 3/12 roof pitch
- 9' eave height
- 18" overhang at eaves and gable ends
- Painted steel roofing and fascia
- 16 - 12'x12' stalls with 2/3 grill divider wall
- 2 - 12'x12' wash bays
- 2 - 12'x12' tack room with 4070 steel entry door
- 12' breezeway with doors
- 14' side porches posted at 12'

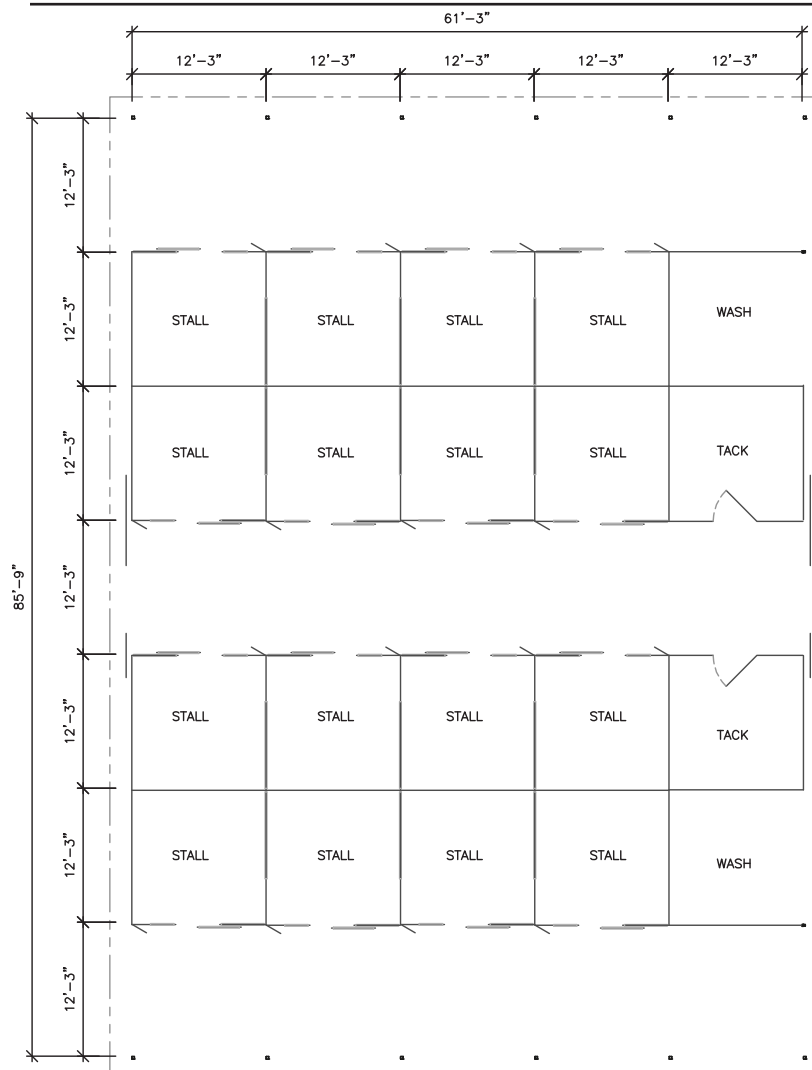

Double Breezeway
28 Stall

Base Description:

- 3/12 roof pitch
- 9' eave height
- 18" overhang at eaves and gable ends
- Painted steel roofing and fascia
- 28 - 12'x12' stalls
- 12' breezeway with doors

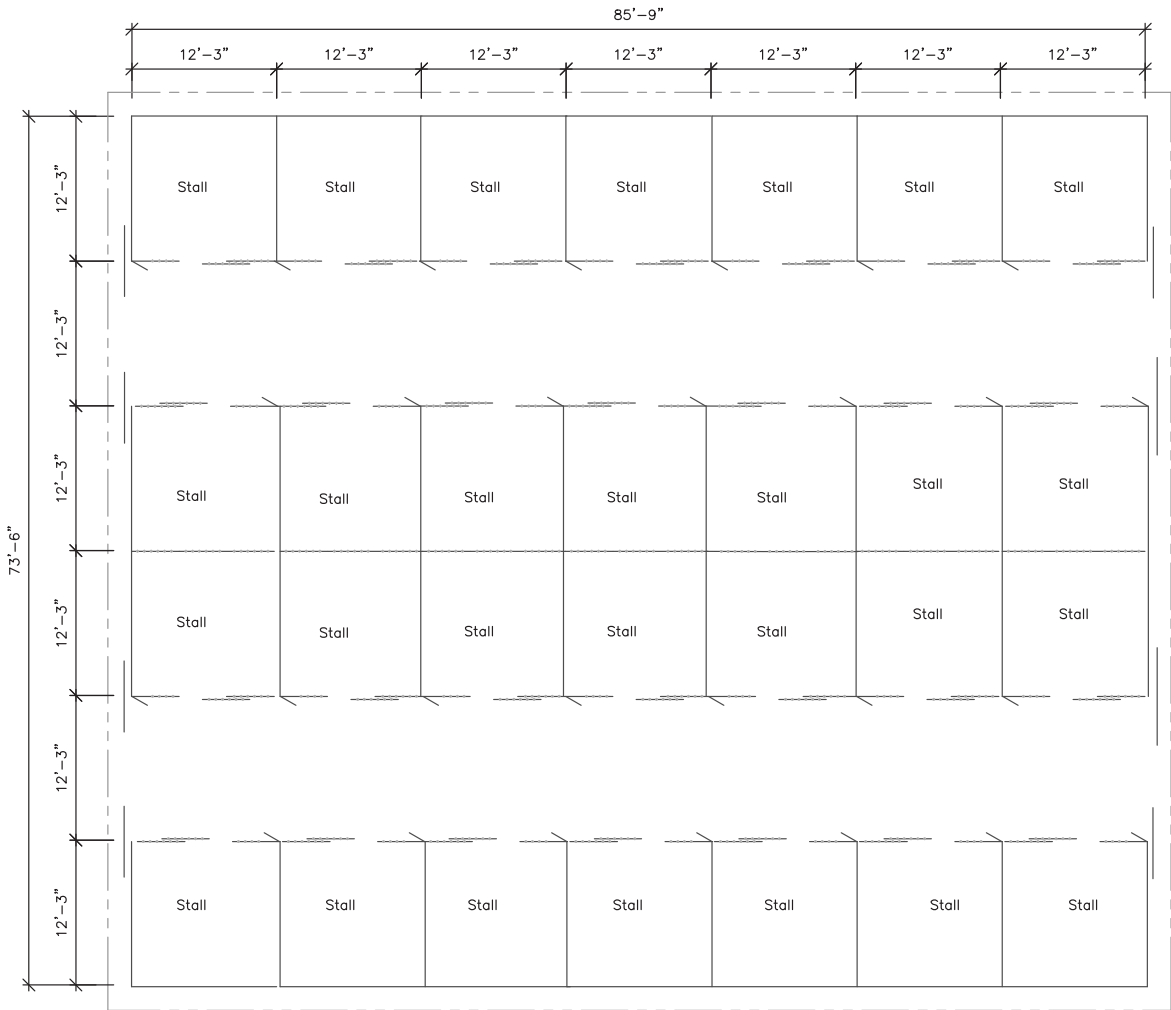

24 Stall with Tack

- 3/12 roof pitch
- 9' eave height
- 18" overhang at eaves and gable ends
- Painted steel roofing and fascia
- 24 - 12'x12' stalls
- 1 - 12'x24' tack with two 4070 steel entry doors and two 8' pivot walls
- 12' breezeway with doors

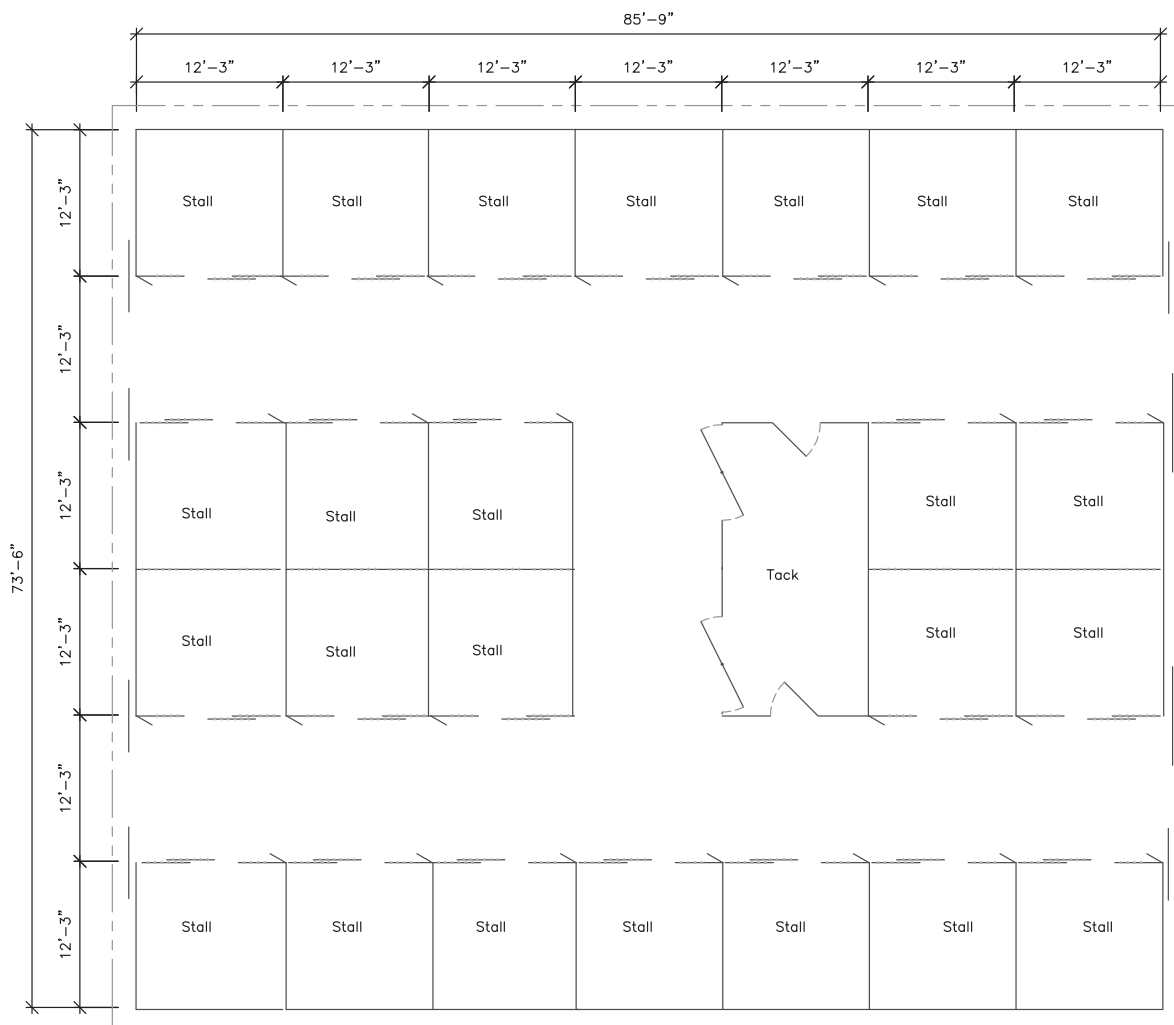

Double Breezeway

18 Stall with Wash, Tack, Feed, Office

Base Description:

- 3/12 roof pitch
- 9' eave height
- 18" overhang at eaves and gable ends
- Painted steel roofing and fascia
- 18 - 12'x12' stalls
- 1 - 12'x12' wash bay with wash divider wall and tie rings
- 1 - 12'x12' office with 4070 steel entry door
- 2 - 12'x24' tack room with two 4070 steel entry doors and two 8' pivot walls
- 1 - 12'x24' feed room with 8' solid sliding door
- 12' breezeway and cross breezeway with doors (6 pair)

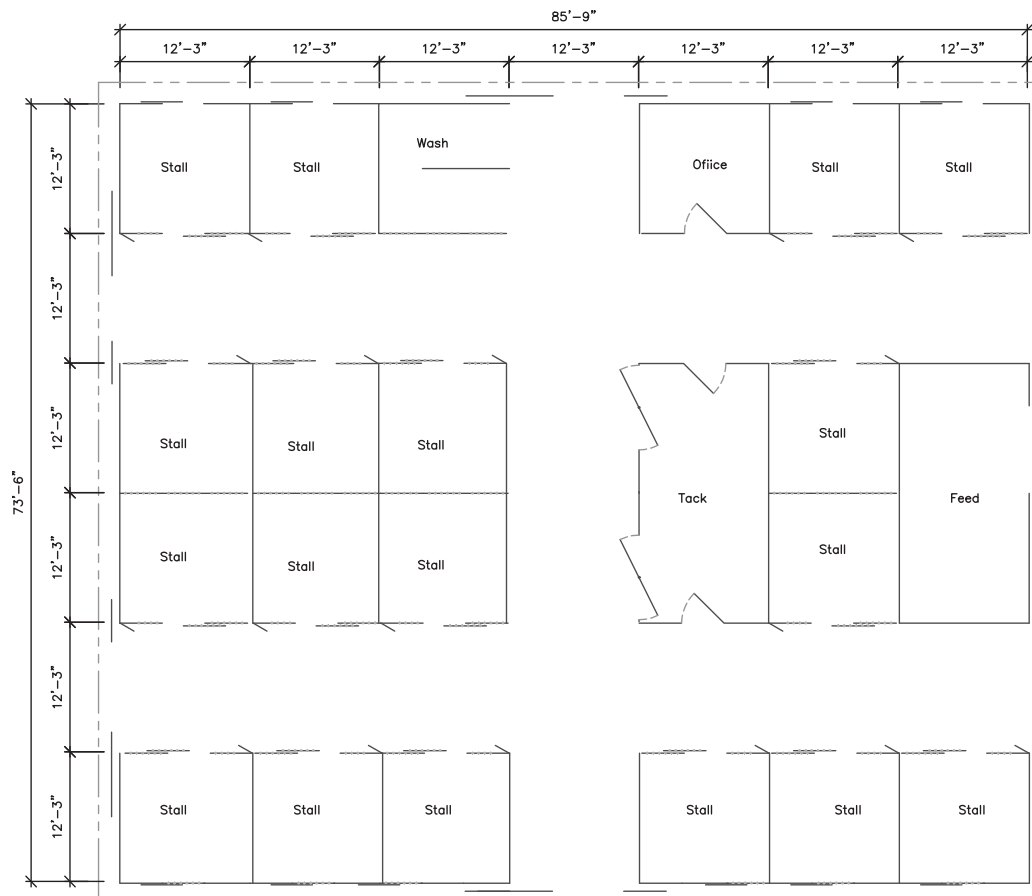

32 Stall with Wash, Tack, Feed, Office and 12' x 24' porch



- 3/12 roof pitch
- 9' eave height
- 18" overhang at eaves and gable ends
- Painted steel roofing and fascia
- 32 - 12'x12' stalls with 2/3 grill divider walls
- 2 - 12'x12' tack room with two 4070 steel entry doors
- 1 - 12'x12' office with 4070 steel entry door
- 1 - 12'x12' feed room with 6' solid sliding door
- 1 - 24' porch posted at 12' with 2 wash bays and wash divider walls with tie rings
- 12' breezeway and cross breezeway with doors (6 pair)

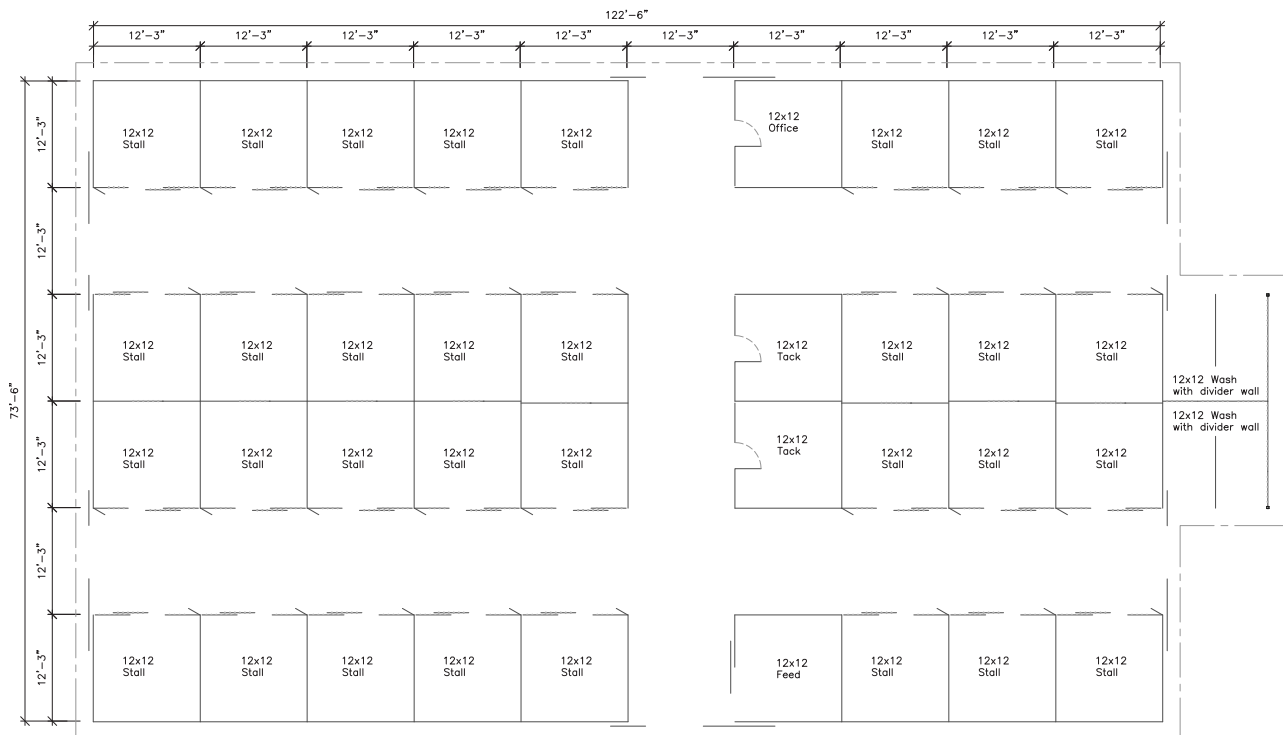

Specialty Breezeway

48 Stall with Two 12' Porches

Base Description:

- 3/12 roof pitch
- 9' eave height
- 18" overhang at eaves and gable ends
- Painted steel roofing and fascia
- 48 - 12'x12' stalls
- 4 - 12' cross breezeways
- 2 - 12' porches with hips

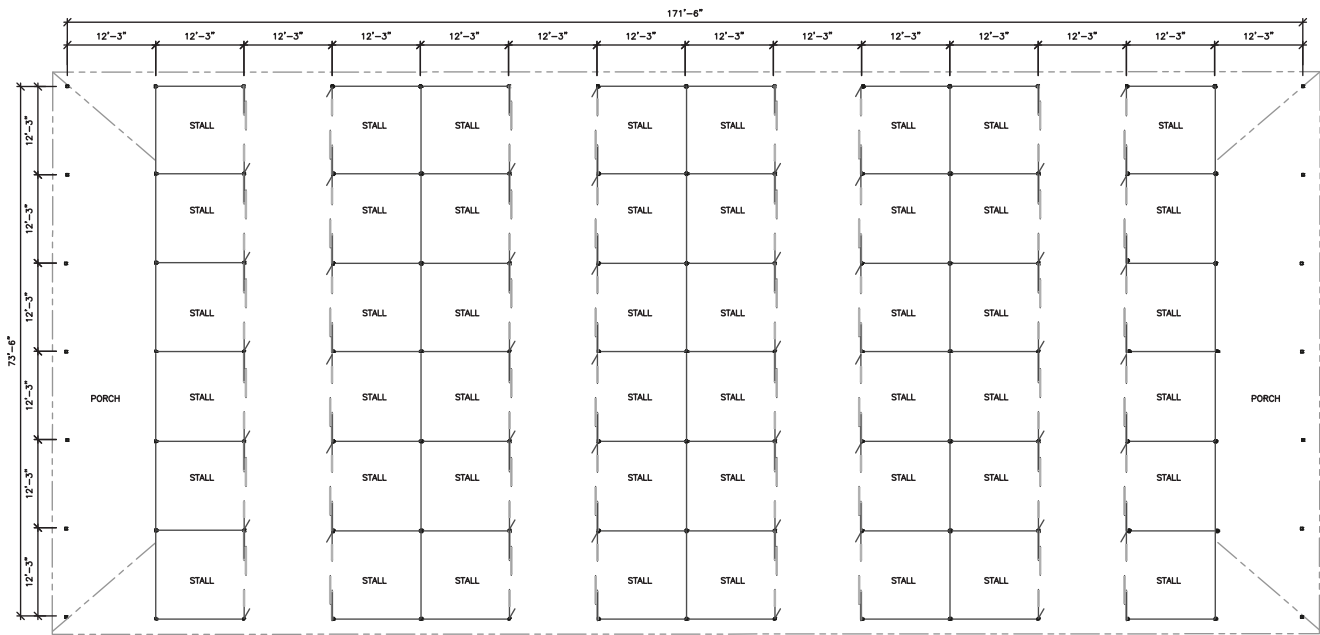

Specialty Breezeway

48 Stall with Wraparound Porch

Base Description:

- 3/12 roof pitch
- 9' eave height
- 18" overhang at eaves and gable ends
- Painted steel roofing and fascia
- 48 - 12'x12' stalls with 2/3 grill divider walls
- 4 - 12' cross breezeways
- 2 - 12' porches with hips
- 2 - side porches posted at 12'

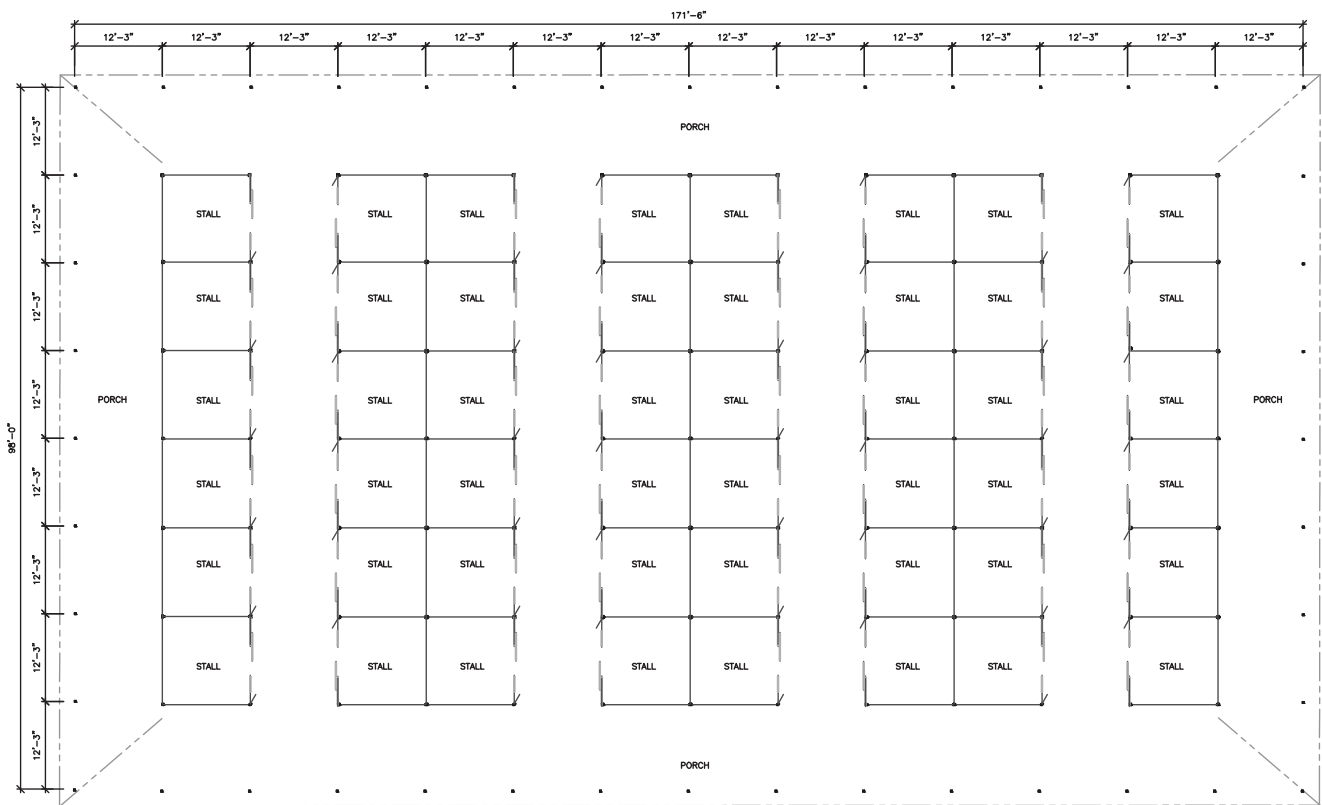

Freespan Buildings

20' Freespan Building

Base Description:

- 3/12 roof pitch
- Clearance is 1' less than chosen eave height
- 18" overhang at eaves and gable ends
- Sandstone Interior
- Painted steel roofing and fascia
- Two - 5' breezeway doors

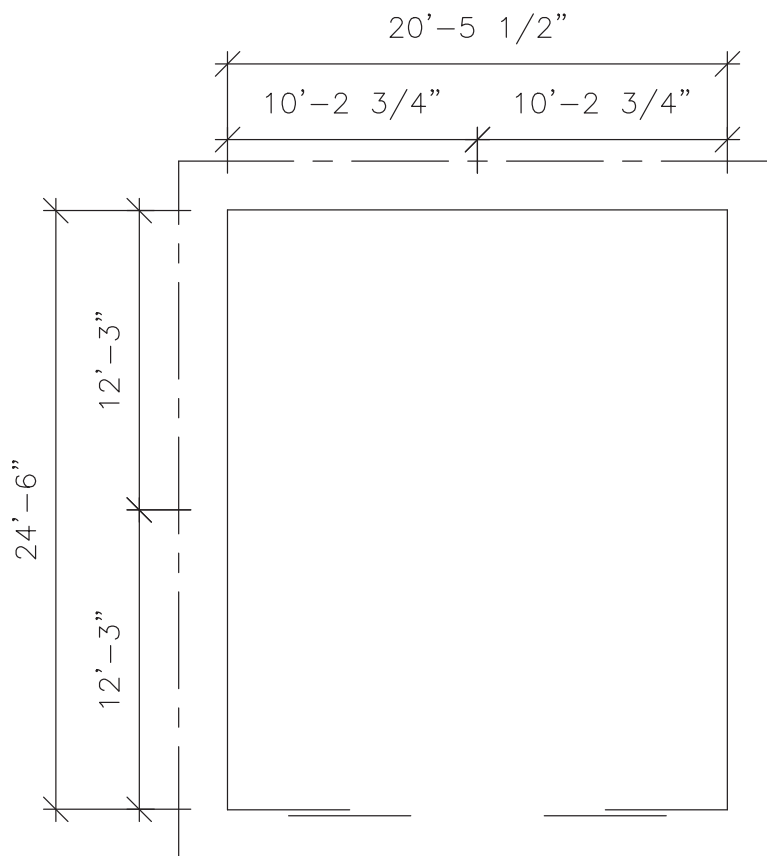

Freespan Buildings

24' Freespan Building

Base Description:

- 3/12 roof pitch
- Clearance is 1' less than chosen eave height
- 18" overhang at eaves and gable ends
- Sandstone Interior
- Painted steel roofing and fascia
- Two - 6' breezeway doors

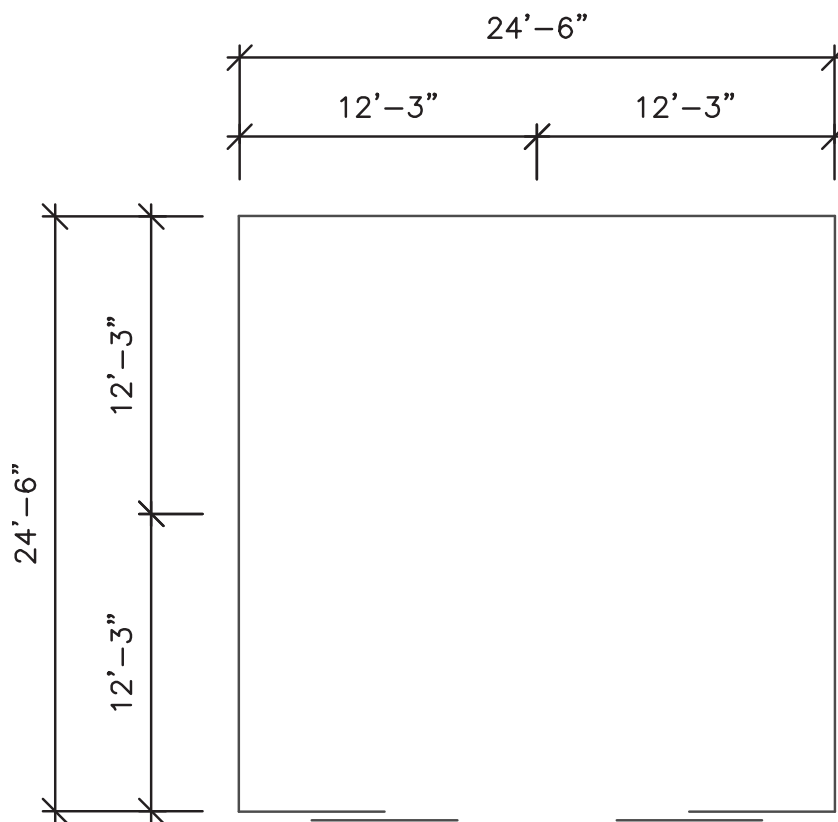

Freespan Buildings

28' Freespan Building

Base Description:

- 3/12 roof pitch
- Clearance is 1' less than chosen eave height
- 18" overhang at eaves and gable ends
- Sandstone Interior
- Painted steel roofing and fascia
- Two - 6' breezeway doors

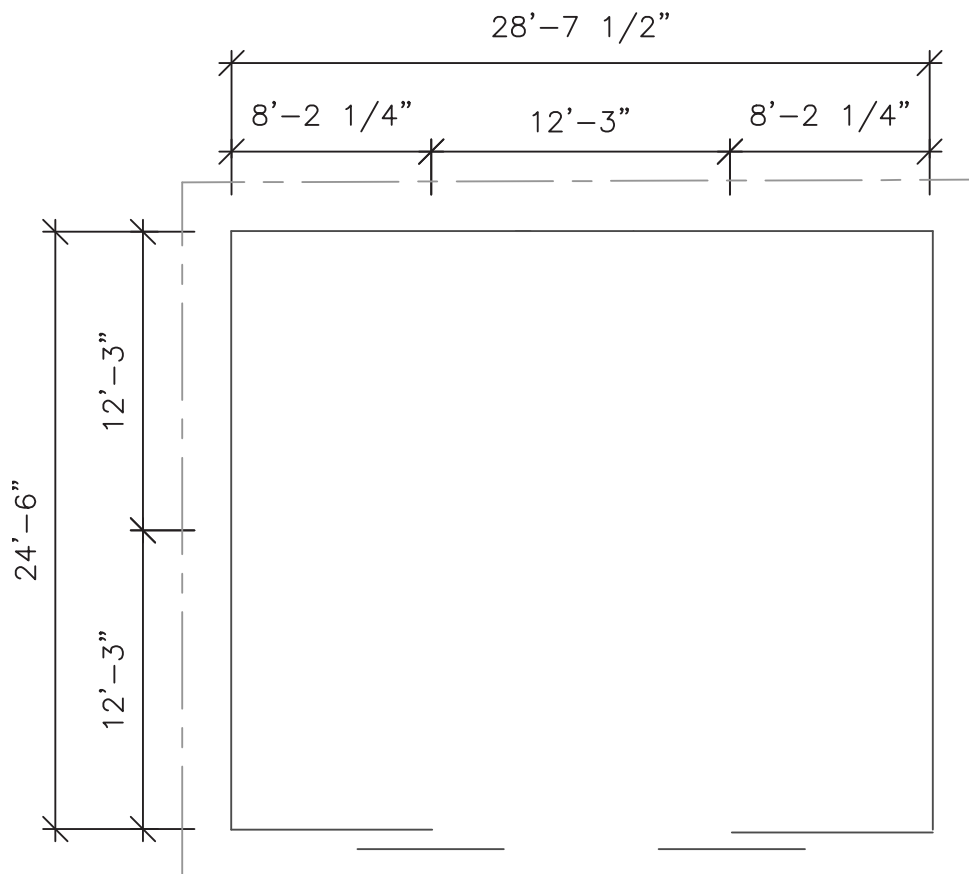

Freespan Buildings

32' Freespan Building

Base Description:

- 3/12 roof pitch
- Clearance is 1' less than chosen eave height
- 18" overhang at eaves and gable ends
- Sandstone Interior
- Painted steel roofing and fascia
- Two - 8' breezeway doors

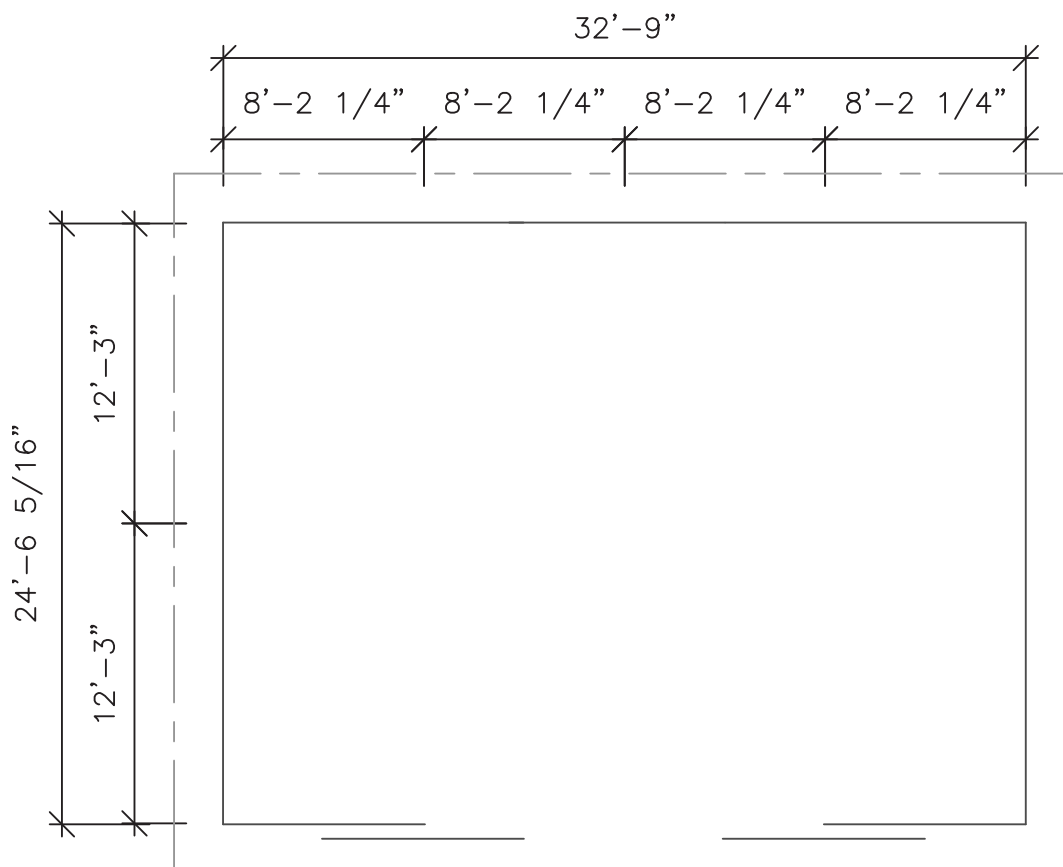

Freespan Buildings

36' Freespan Building

Base Description:

- 3/12 roof pitch
- Clearance is 1'6" less than chosen eave height
- 18" overhang at eaves and gable ends
- Sandstone Interior
- Painted steel roofing and fascia
- Two - 6' breezeway doors

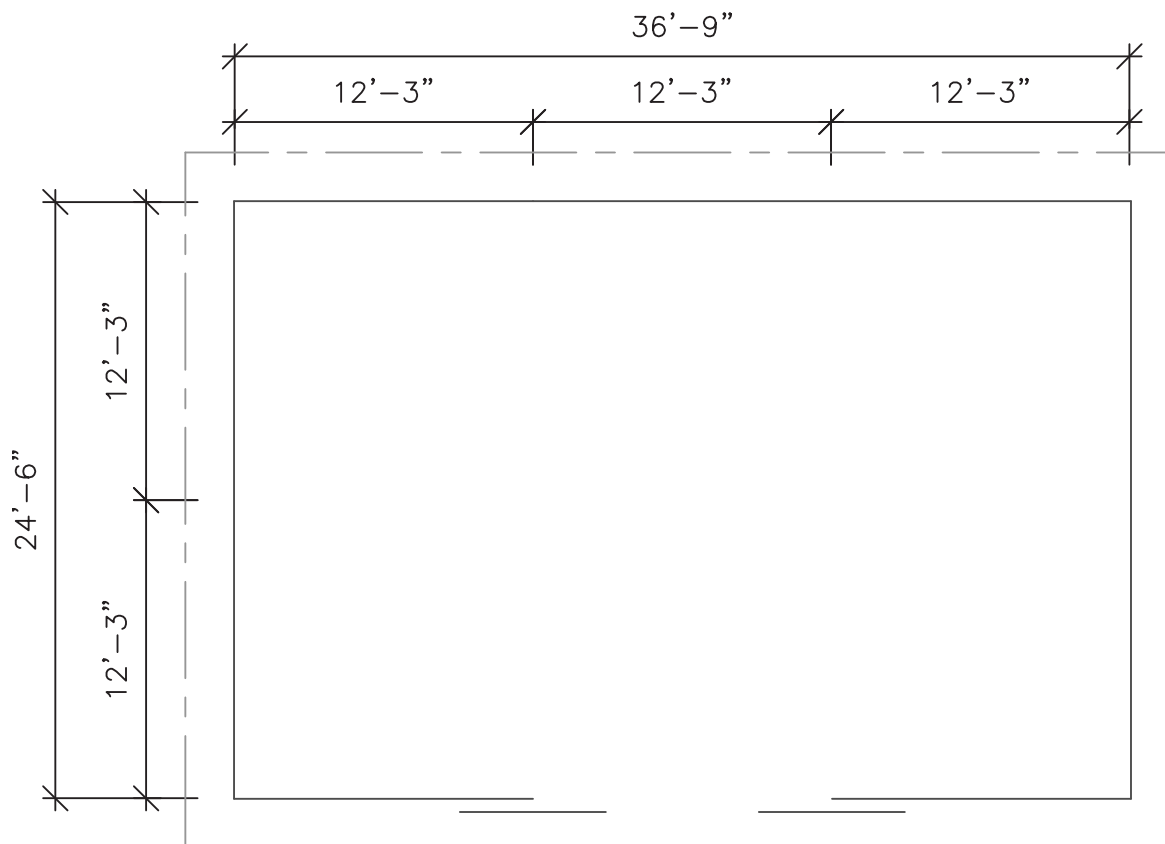

Freespan Buildings

40' Freespan Building

Base Description:

- 3/12 roof pitch
- Clearance is 1'6" less than chosen eave height
- 18" overhang at eaves and gable ends
- Sandstone Interior
- Painted steel roofing and fascia
- Two - 8' breezeway doors

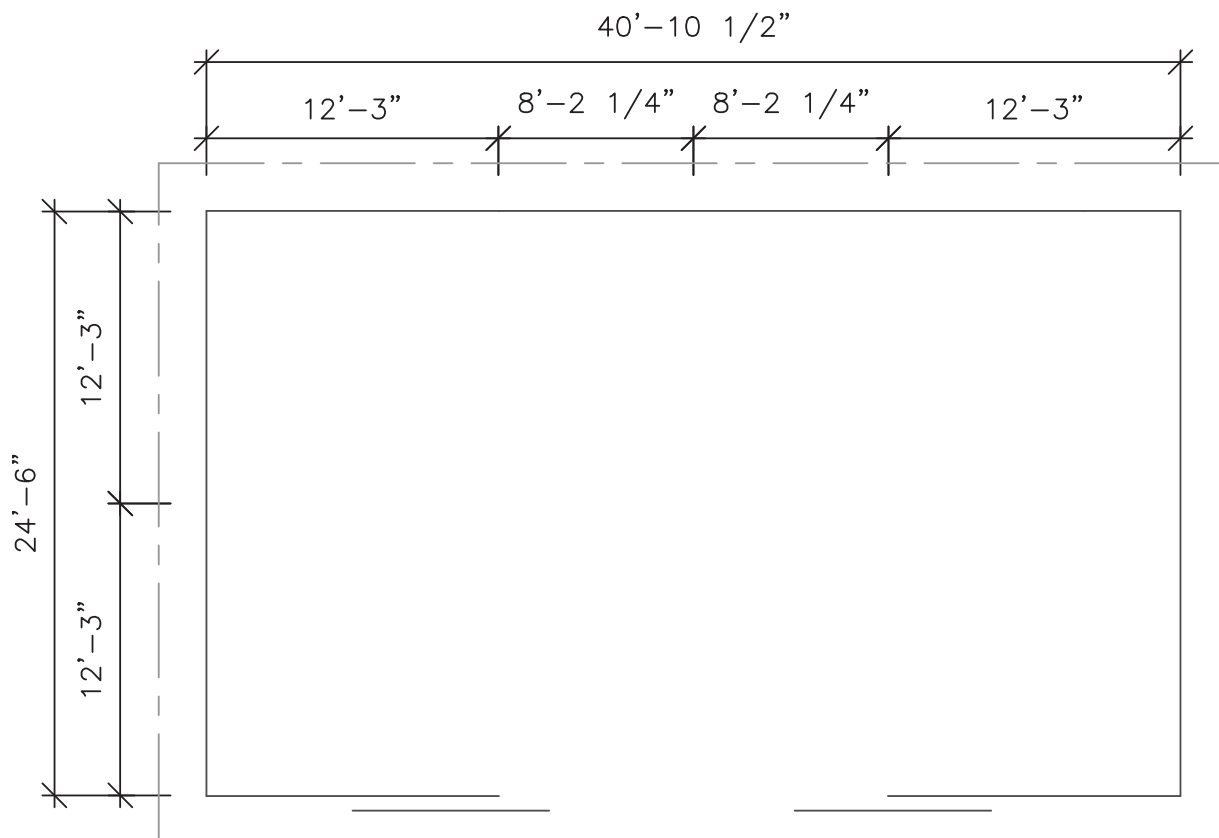

Freespan Buildings

44' Freespan Building



Base Description:

- 3/12 roof pitch
- Clearance is 1'6" less than chosen eave height
- 18" overhang at eaves and gable ends
- Sandstone Interior
- Painted steel roofing and facia
- Two - 6' breezeway doors

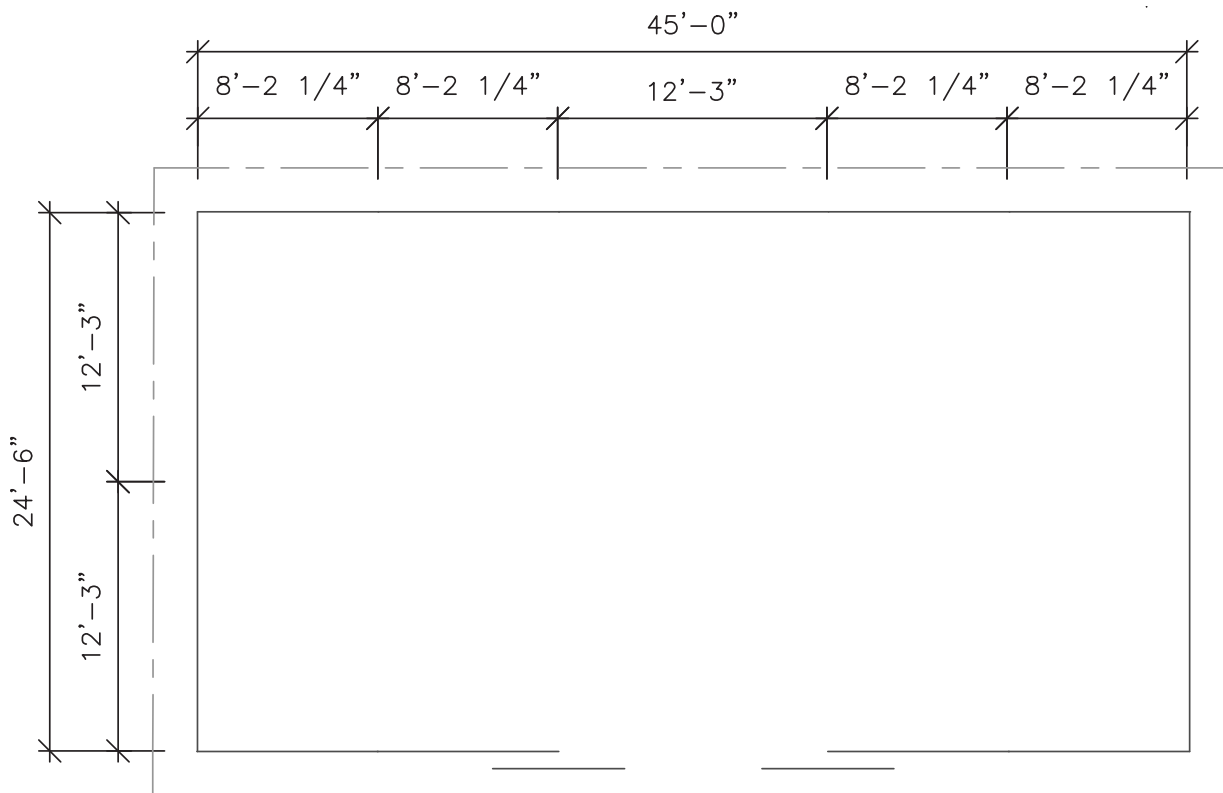

Freespan Buildings

48' Freespan Building



Base Description:

- 3/12 roof pitch
- Clearance is 1'6" less than chosen eave height
- 18" overhang at eaves and gable ends
- Sandstone Interior
- Painted steel roofing and fascia
- Two - 8' breezeway doors

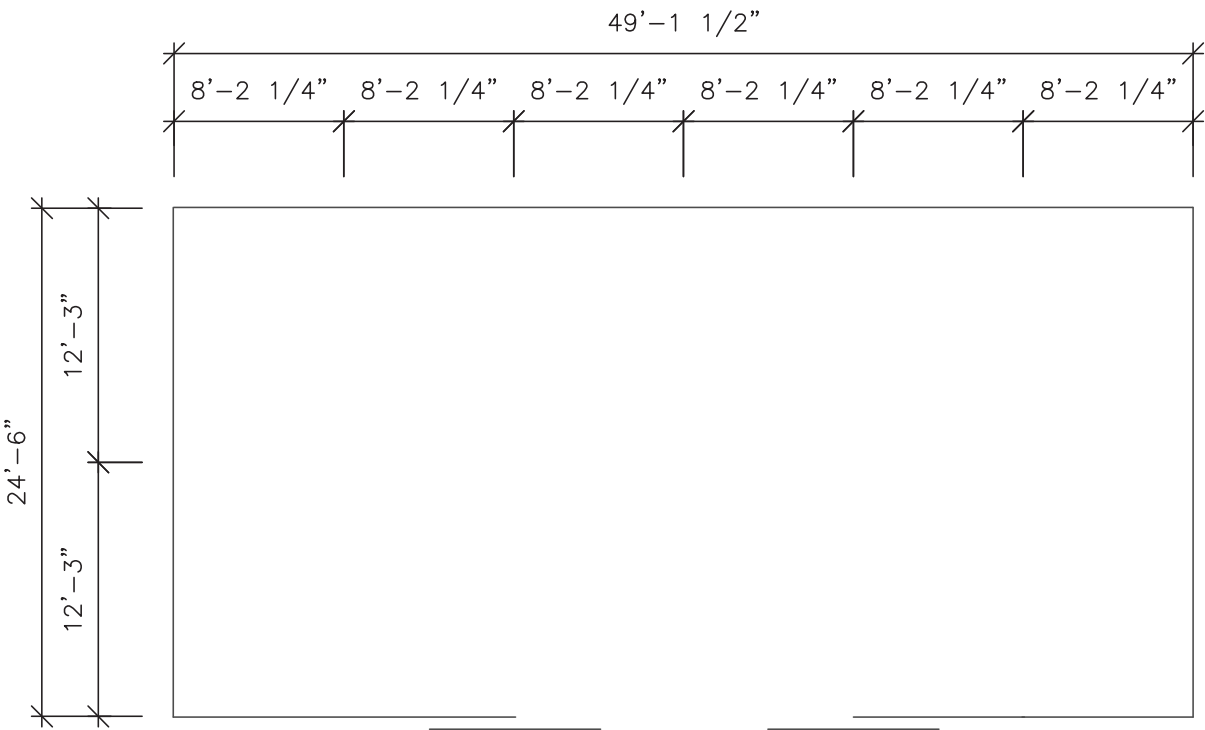

Freespan Buildings

60' Freespan Building



Base Description:

- 3/12 roof pitch
- Clearance is 2' less than chosen eave height
- 18" overhang at eaves and gable ends
- Sandstone Interior
- Painted steel roofing and fascia
- Two - 9' breezeway doors

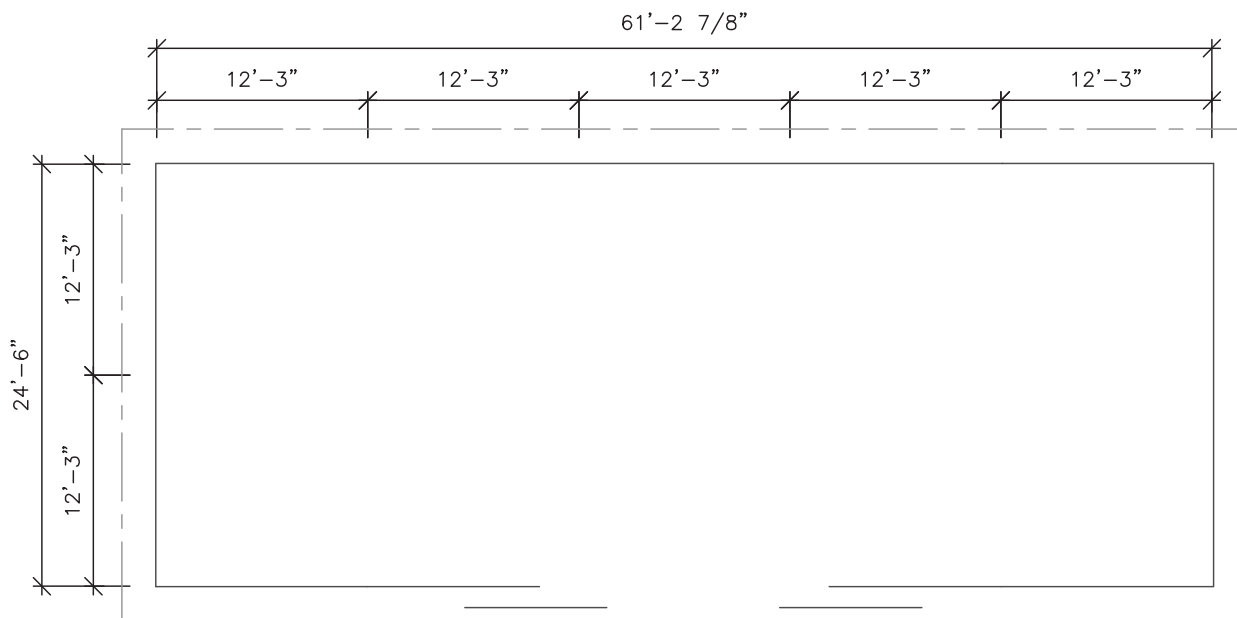

Loafing Shed

Panel Description:

- 12'x12' perimeter
- 1/12 roof pitch or 3/12 roof pitch with cantilever

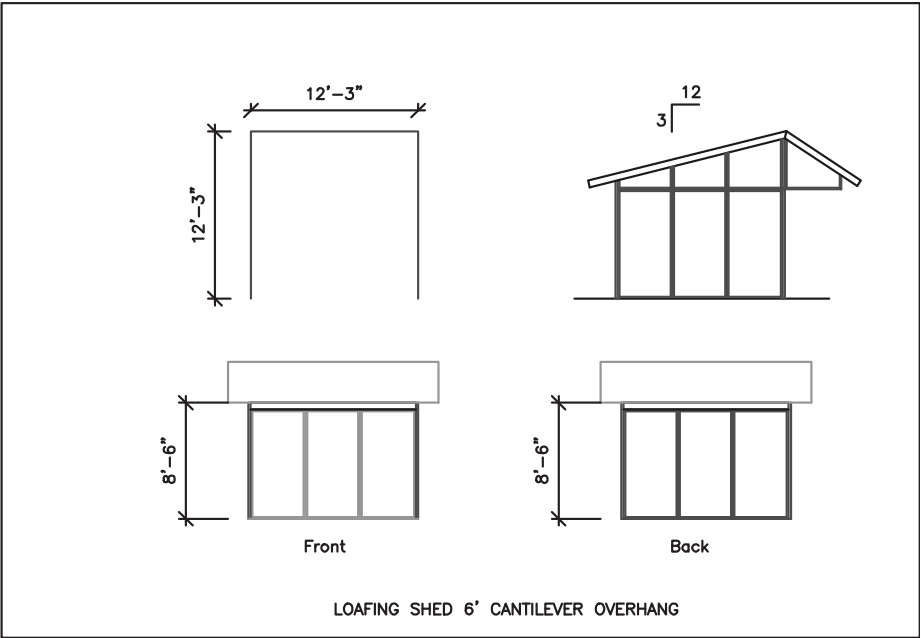
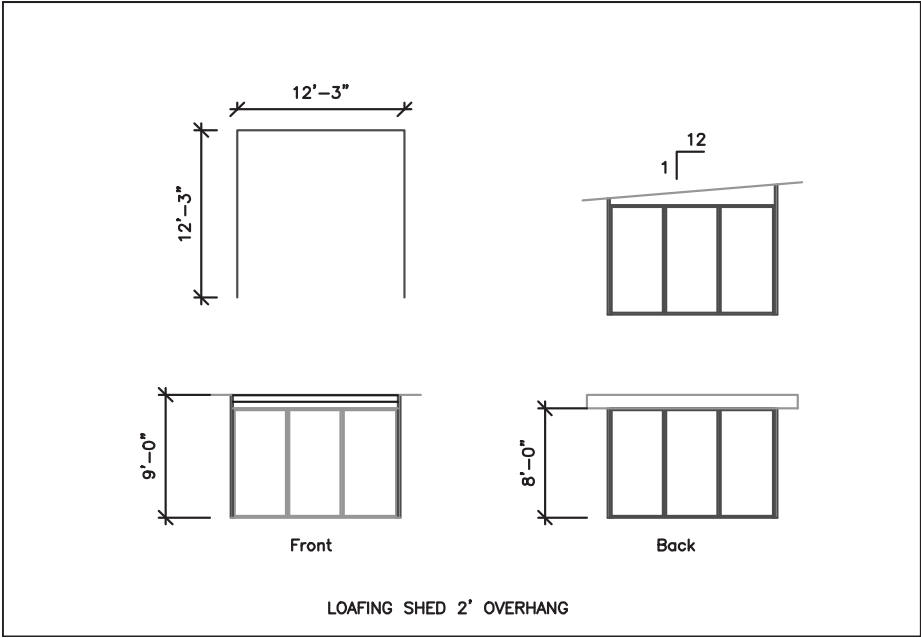

Round Pen

Panel Description:

- 8'4"x6' panels - solid to 4' high with two rails
- Gate panel - 8'4"x8'4" double drive gate (one with drop pin, the other with trigger latch)
- 1/2" bamboo walls
- Painted Sandstone interior
- 1-7/8" frame around perimeter

